

Process SAH 77457

Cadastral Sheet E 24 F ^{56C}/_{1/C}
Ward of Guayaguayare
County of Mayaro

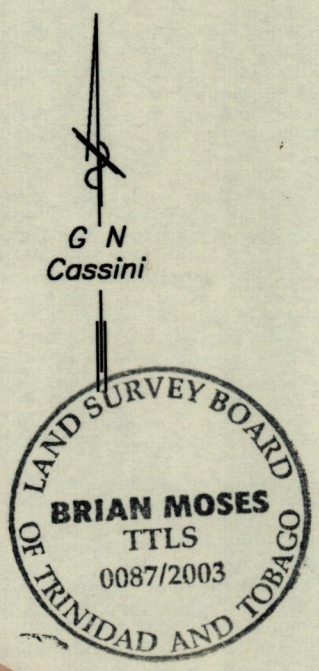
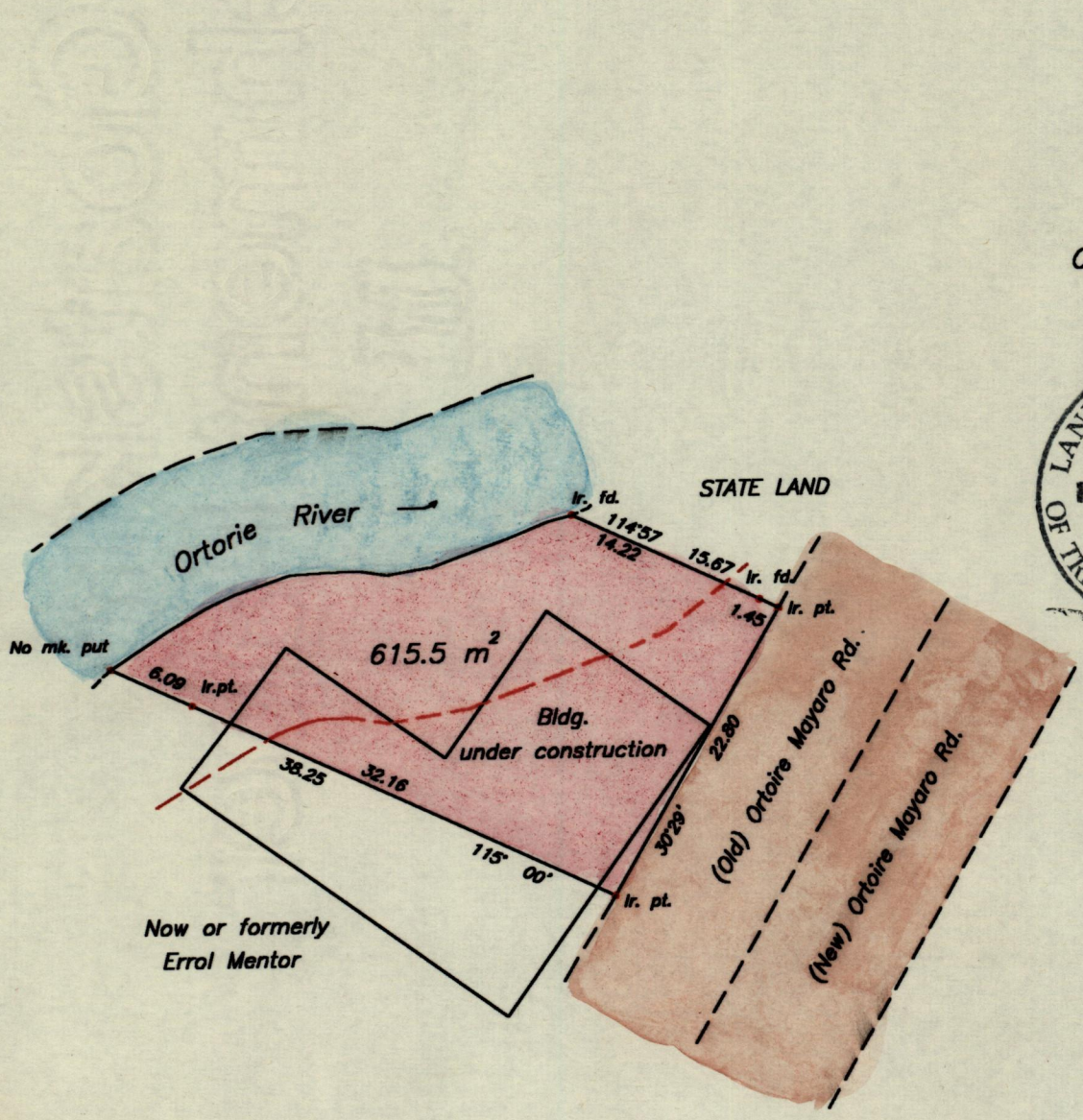

Area of encroachment of building into Lands of
of now or formerly Errol Mentor = 235 m²

Located
(6)

Previous survey Bk. 1130 Fol. 92

SCALE 1:500
Distances are in METRES

--- Building line setback 10 m from river
Bearings are based on Solar observations

PLAN of a Parcel of land coloured pink in the Ward of Guayaguayare
Containing six hundred and fifteen point five square meters
Surveyed by me, with due authority, in March, 2003
In accordance with Regulation 25 (1) of the Land Surveyors' Regulations 1998,
I certify that this Plan is correct.

Brian Moses
Trinidad & Tobago Land Surveyor 23rd April 2003
Entered