

1334

1337

Cadastral Sheet 56C E.24.B
 1/a
 Ward of Guayaguayare
 County of Mayaro

28
 Process SD# 77429

VIDE
 Book 1130:91

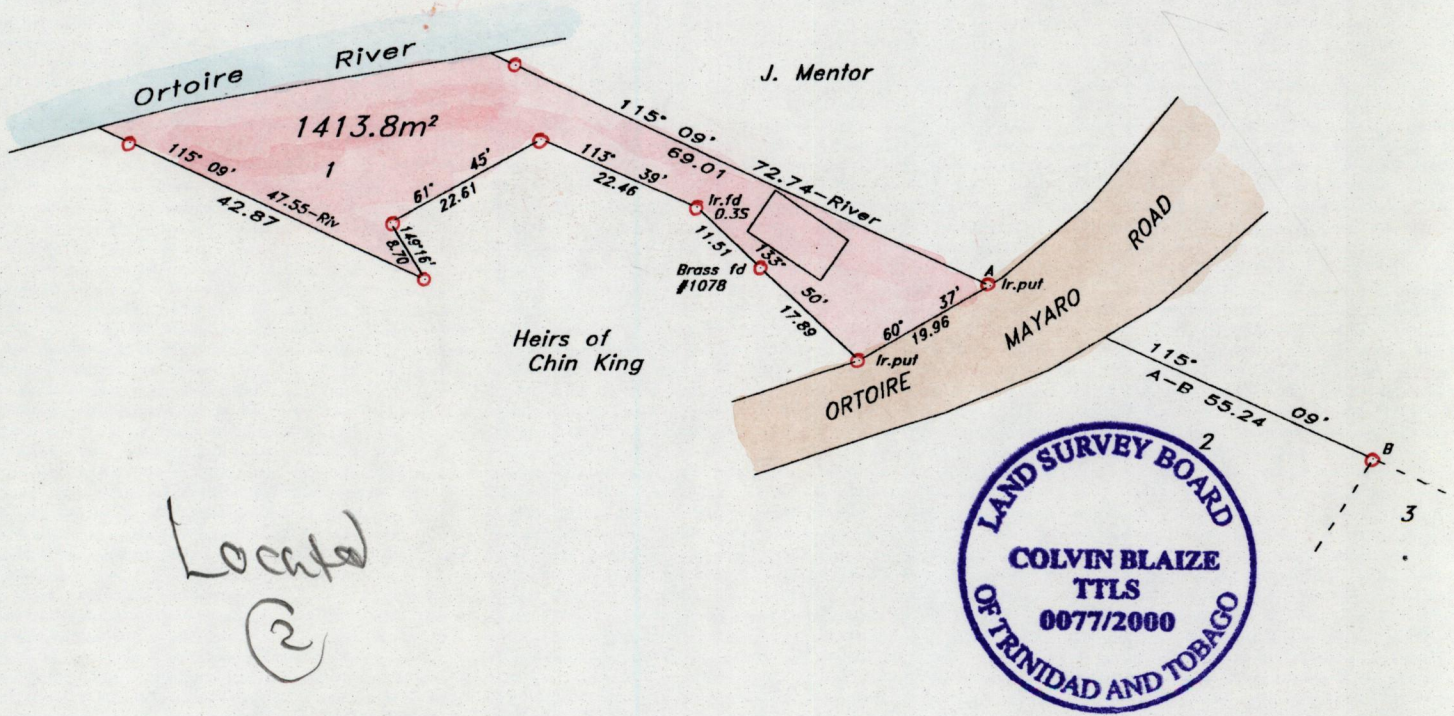
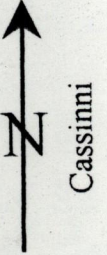

Locate
 (2)

○ Denotes Iron found unless otherwise state
 Bearings are based on Solar Obs

Scale 1 / 1000

Distances are in metres

PLAN of a parcel of Land coloured pink in the Ward of Guayaguayare
 Containing **One thousand four hundred and thirteen point eight square metres**
 Redefined by me with due authority in November 2000 for **BERNARD BLACKMAN**

In accordance with Rule 25(1) of the Land Surveyor's Regulations 1998, I certify

that this plan is correct.

Checked by
 Entered on

Colvin Blaize

 Trinidad & Tobago, Land Surveyor

20th December 2000
 2001.02.08