

70

1334

135

L. and S.—53

Process JDT 77424

Cadastral Sheet  $\frac{56B}{4/d}$  (H. 5. A.)

A N<sup>o</sup> 0234

Ward of Guayaguayare

County of Mayaro

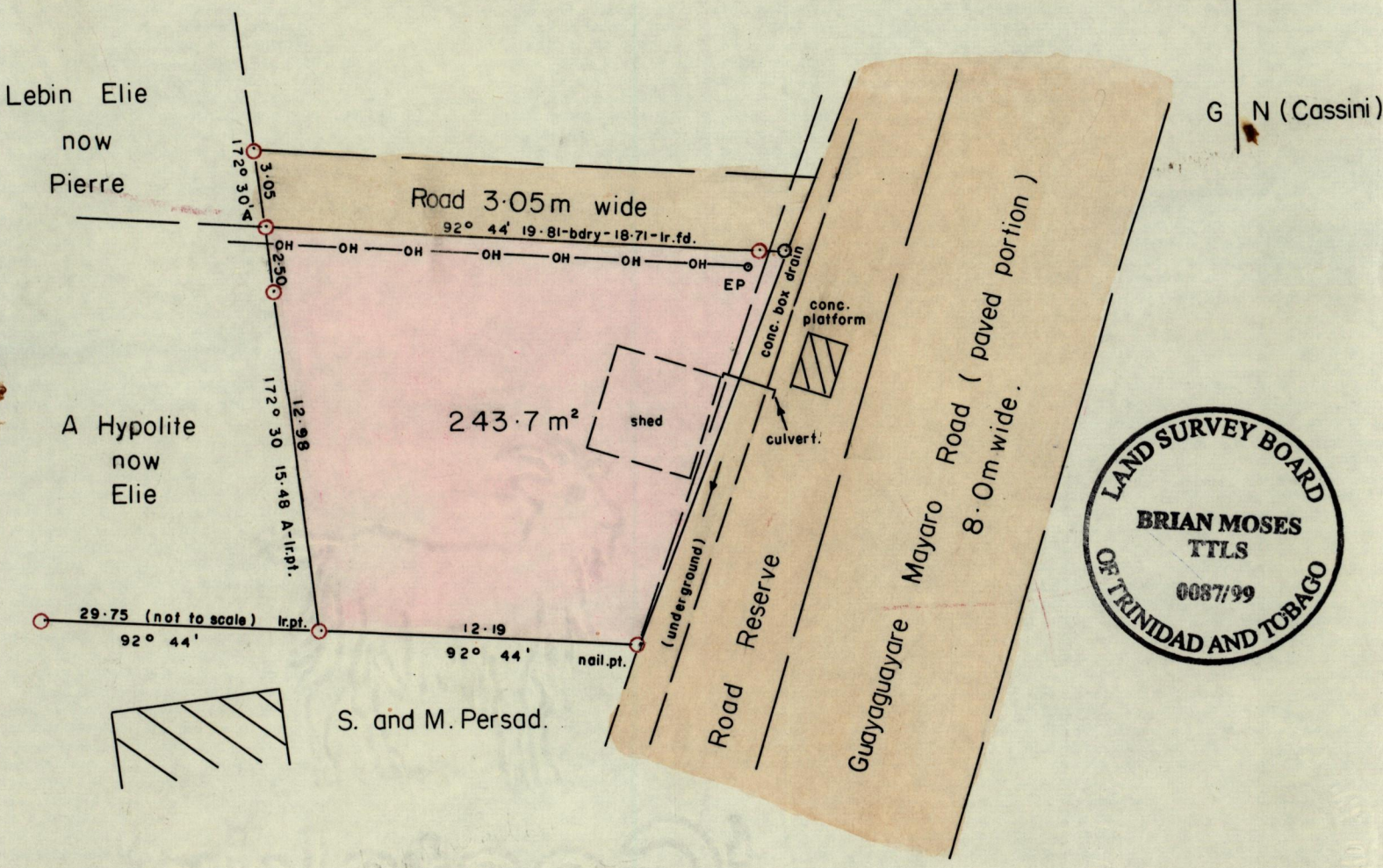

not located.

Approved .....  
Director of Surveys.

nail pt. - bdry 20° 27' 15.99  
 EP Electricity pole  
 OH Over head high tension wire

○ Denotes Iron found unless otherwise stated.  
 Bearings are based on Solar observations.

SCALE 1 : 250

Note: To obtain compass bearing subtract minutes Distances are in METRES.  
 PLAN of a Parcel of land coloured pink in the Ward of Guayaguayare.  
 Containing two hundred and forty three point seven square metres.  
 Surveyed by me, with due authority, in April 1999 for V. Elie.

Checked by ..... Brian Moses .....  
 Entered on ..... Land Surveyor, Trinidad and Tobago ..... 7<sup>th</sup> May ..... 1999.  
 G.P., TR./To.—M 2654—2,000—1/97  
 Certified Correct.

Rec'd. 99/05/11