

1334

1083

Process Jd. 71352

Cadastral Sheet E.24.J $\frac{56C}{1/c}$

Ward of Guayaguayare

County of Mayaro

CELL SITE - POINT RADIX

G N
cassini

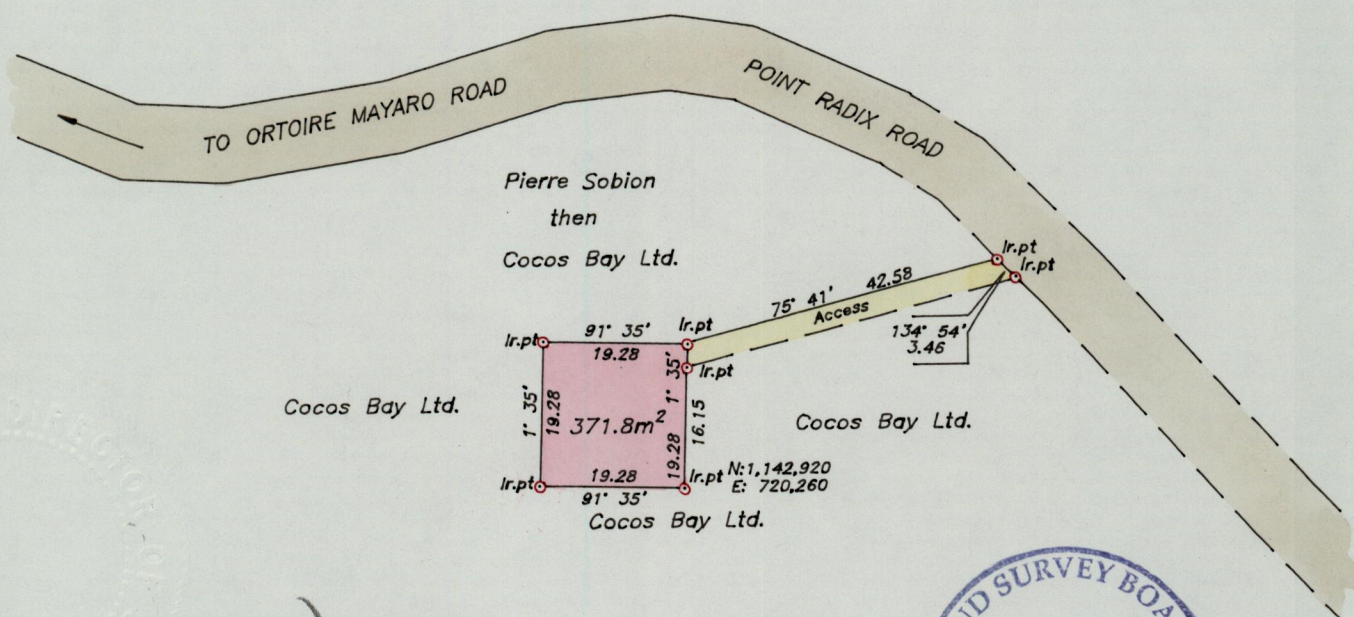

Located
(1)

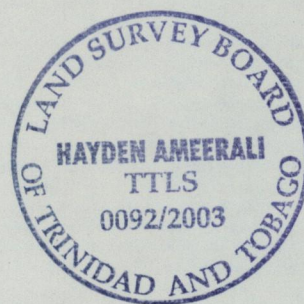

UTM Co-ordinates are approx. scaled from 1/10,000 ward sheet

Bearings are Cassini grid based on Magnetic Needle

Note: To obtain compass bearings add 18 minutes.

SCALE 1/1000

Distances are in metres

PLAN of a Parcel of land coloured pink in the Ward of Guayaguayare
 Containing three hundred and seventy one point eight square metres
 Surveyed by me, with due authority, in November 2003 for Site Acquisition Services Ltd.
 In accordance with Regulation 25 (1) of the Land Surveyors' Regulations 1998,
 I certify that this plan is correct.

Checked by.....

Entered..... Trinidad & Tobago Land Surveyor..... 15th December 2003