

13134

146

L. and S.—53

U. P. R. N No -----

Cadastral Sheet H.5.A

568 or E

Process. 120
ID# 77227

Ward of Guayaguayare

County of Mayaro

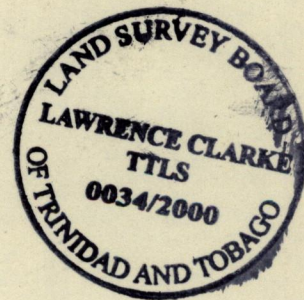
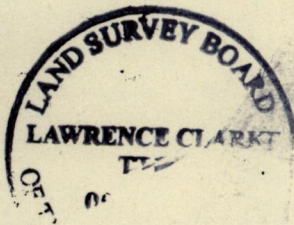
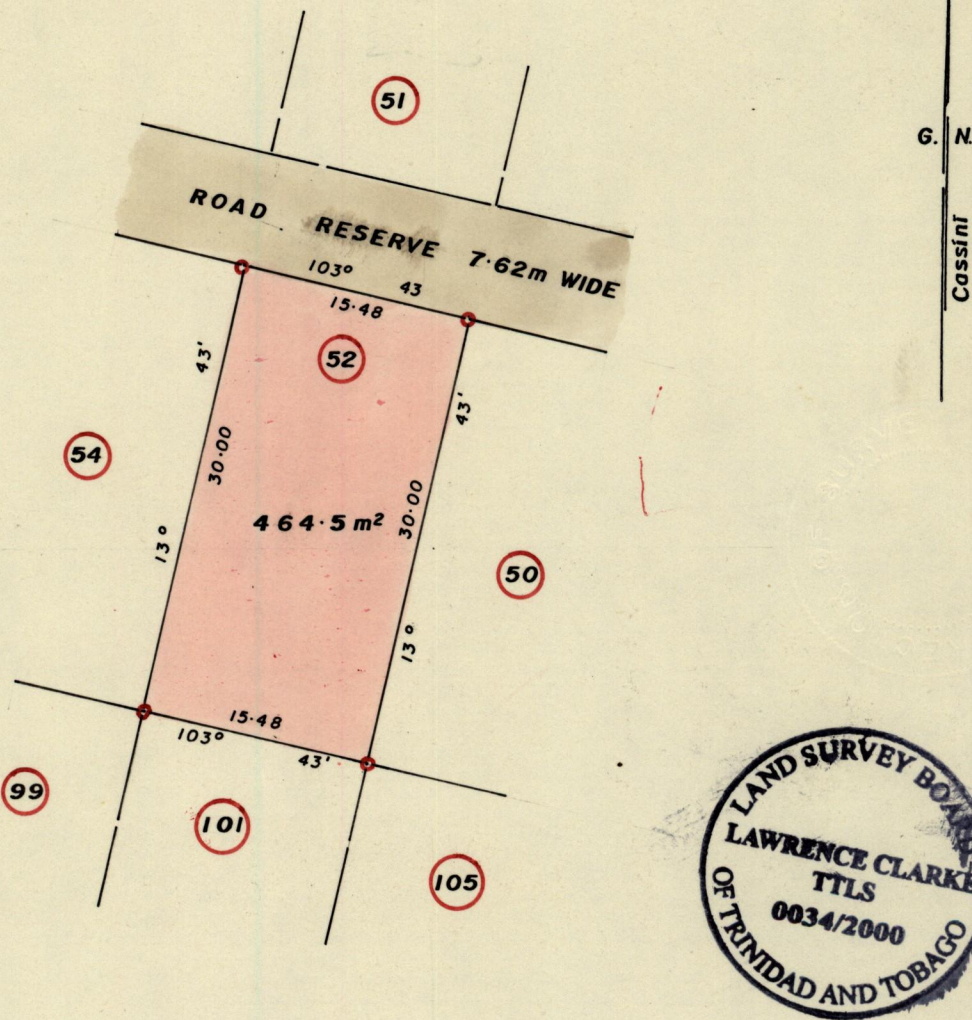

SCALE 1:500

Bearings are based on Solar Observations

Denotes Iron put

Note: To obtain compass bearing

minutes Distances are in metres

PLAN of a Parcel of land coloured pink in the Ward of Guayaguayare

Containing four hundred and sixty four point five square metres

Surveyed by me, with due authority, in

for Teemul Gopaul

In accordance with Rule 25(1) of the Land Surveyors' Regulation 1998. I certify that this plan is correct.

Lawrence Clarke

Entered on -----

Trinidad 31st July 2000.8.25 2000.
and Tobago Land Surveyor

Not located