

See Plan K.F.17-W.T. Vol.9 Fol.49
 Plan L.F.5
 Plan F.C.67-S.O.19/1941
 Bk.298 Fol.175

Cadastral Sheet E.24.1 & J 88C
 Ward of Guayaguayare
 County of Mayaro

Process ID# 77214

located @

on sheet 56B

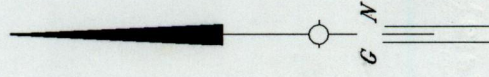

1334

A-B	23° 57'	30.48							
B-C	336° 46'	14.96	M-N	143° 55'	32.64				
E-F	322° 24'	46.88	N-P	145° 23'	27.79				
F-G	33° 26'	33.08	P-Q	150° 50'	25.30				
G-H	33° 19'	10.80	T-U	33° 29'	30.99				
H-J	52° 49'	29.18	U-V	354° 32'	40.98				
J-K	57° 50'	30.63	V-W	284° 51'	13.32				
K-L	21° 18'	11.84	W-X	31° 48'	63.07				
L-M	60° 50'	29.01	S-T	115° 51'	1112.42(N.T.S)				

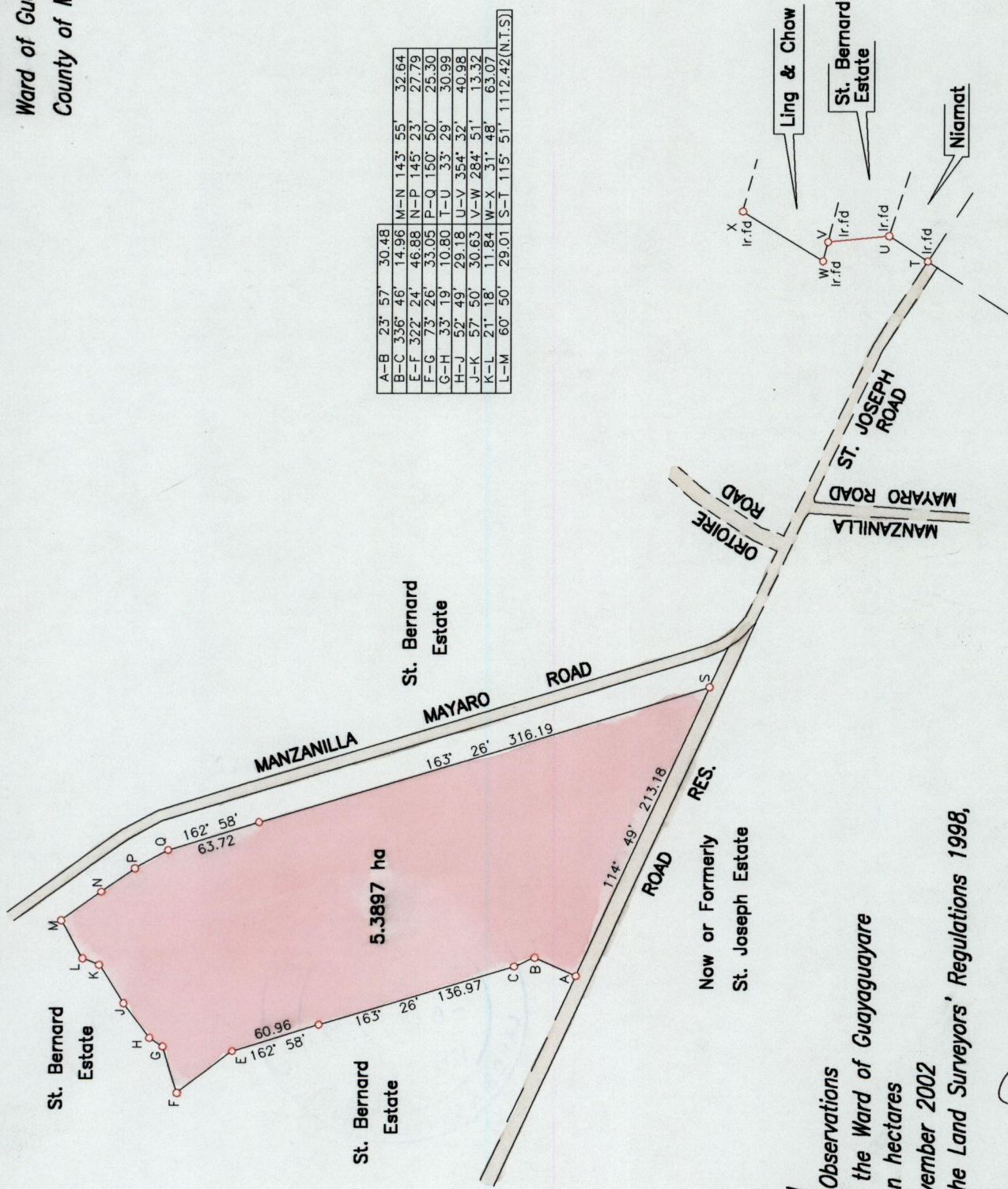

SCALE 1/4000

Distances are in Metres

○ Denotes Iron put except otherwise stated
 Bearings are Cassini Grid based on Solar Observations
 Plan of a Parcel of land coloured pink in the Ward of Guayaguayare
 Containing five point three eight nine seven hectares
 Surveyed by me with due authority, in November 2002
 In accordance with Regulation 25 (1) of the Land Surveyors' Regulations 1998,
 I certify that this plan is correct.

Entered

.....
Ronald Derrick

Trinidad & Tobago Land Surveyor

Path=C:\Sask\Proj\Mayaro Lots

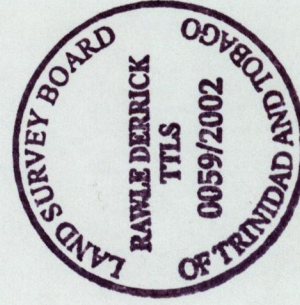

142