

Ward of Guayaguayare
 County of Mayaro
 Cadastral Sheet H.5.A., 56E
 2/b

cannot locate

Process ID# 77147

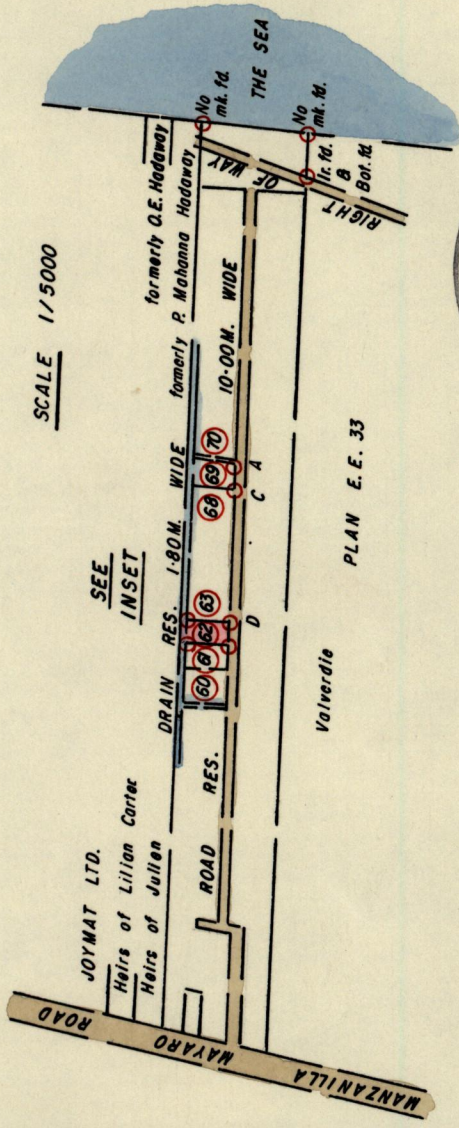

SCALE 1/5000

SEE
 INSET

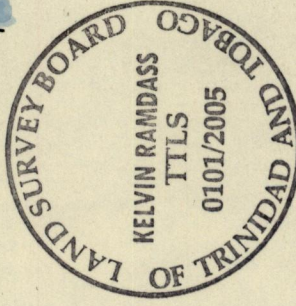

A - Ic. B Bot. fd. 103° 11' 195-86
 Ir. B Bot. fd. - No mt. fd. 92° 31' 28-35
 No mt. fd. - No mt. fd. 6° 49' 76-54

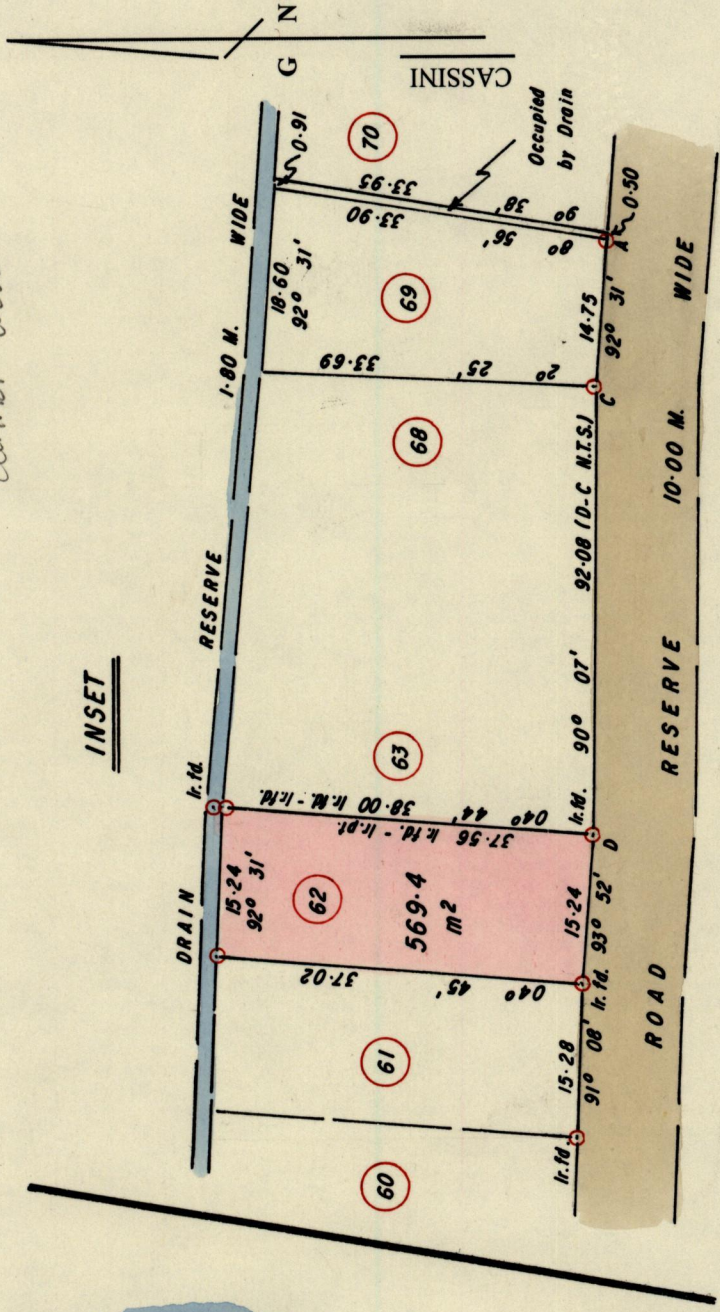

INSET

SCALE 1 / 750 (INSET)

○ Denotes Iron put unless otherwise stated

Distances are in METRES

Bearings are Cassini Grid based on Solar Obs.
 Note: To Obtain compass bearings add/subtract minutes.

PLAN of a Parcel of land coloured Pink in the Ward of Guayaguayare
 Containing five hundred and sixty nine point four square metres
 Surveyed by me, with due authority, in March 2005 for Margaret Singh and Krishna Singh
 In accordance with Regulation 25 (1) of the Land Surveyors' Regulations 1998, I certify that this plan is correct.

Entered on
 Kelvin Ramdass
 Trinidad and Tobago Land Surveyor 2005

1314

127