

Process ID# 76729

Ward of Guayaguayare  
County of Mayaro  
Cadastral Sheet H.15.I 56E  
2/d

cannot locate

G. N.

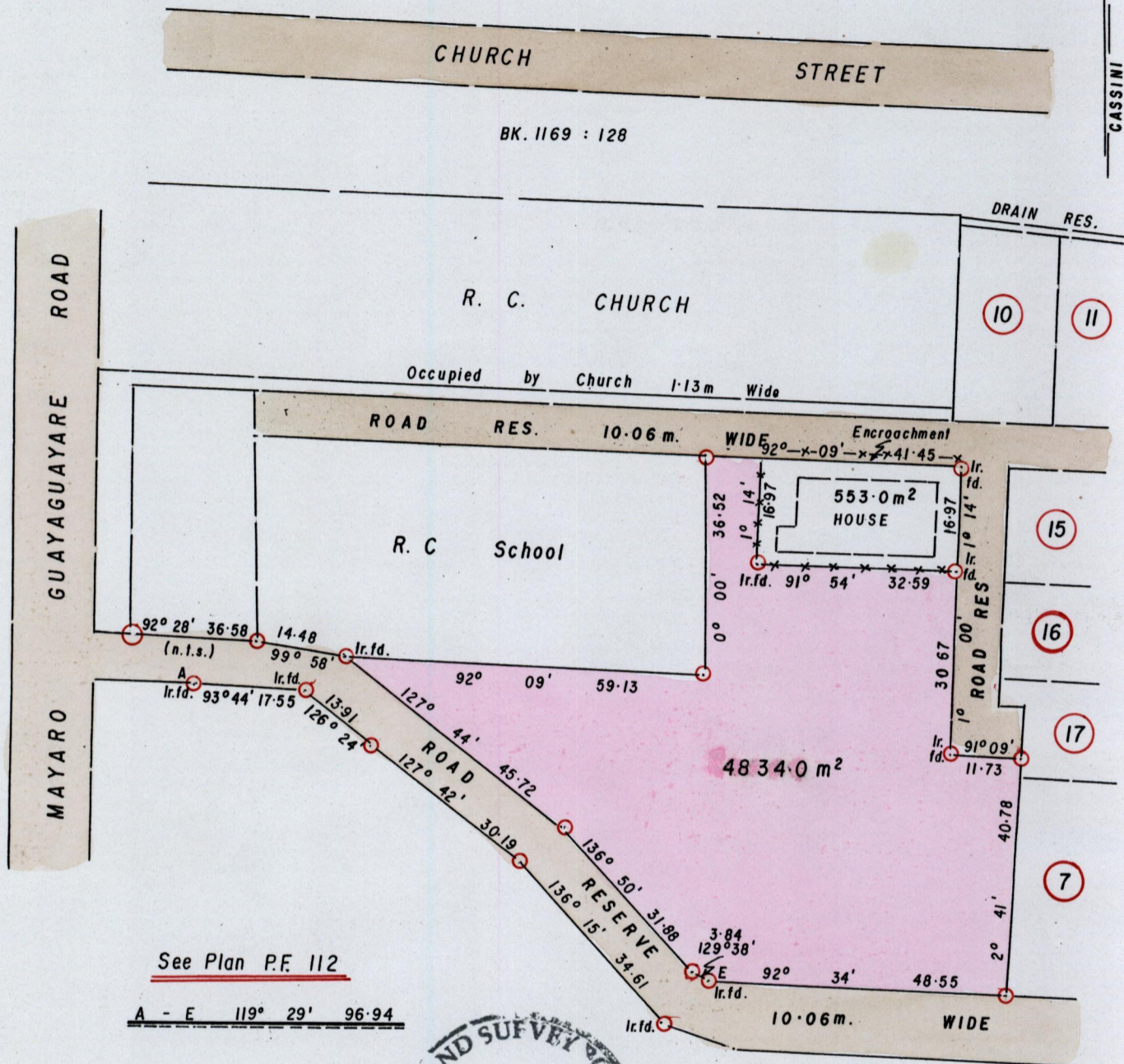

See Plan P.F. 112

A - E 119° 29' 96.94

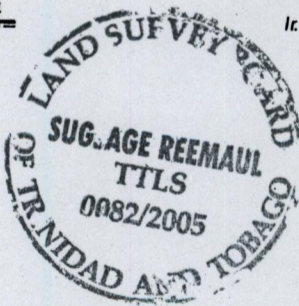

○ Denotes Iron put unless otherwise stated  
Bearings are Cassini Grid based on Solar Observations

SCALE 1/1000  
Distances are in metres

PLAN of a parcel of land coloured pink in the Ward of Guayaguayare  
Containing four thousand eight hundred and thirty fourpoint zero square metres  
Surveyed by me, with due authority in August 2005 for Commercial Finance Co.  
In accordance with Regulation 25 (1) of the Land Surveyors' Regulations 1998.  
I certify that this plan is correct.

.....*S. Reemaul*.....

Entered..... Trinidad & Tobago Land Surveyor.....*15<sup>th</sup> August*.....2005