

13834

102

Cadastral Sheet H.10.A, 56E  
Ward of Guayaguayare 4/d  
County of Mayaro

Process SDA 77041

ECCLES VILLAGE

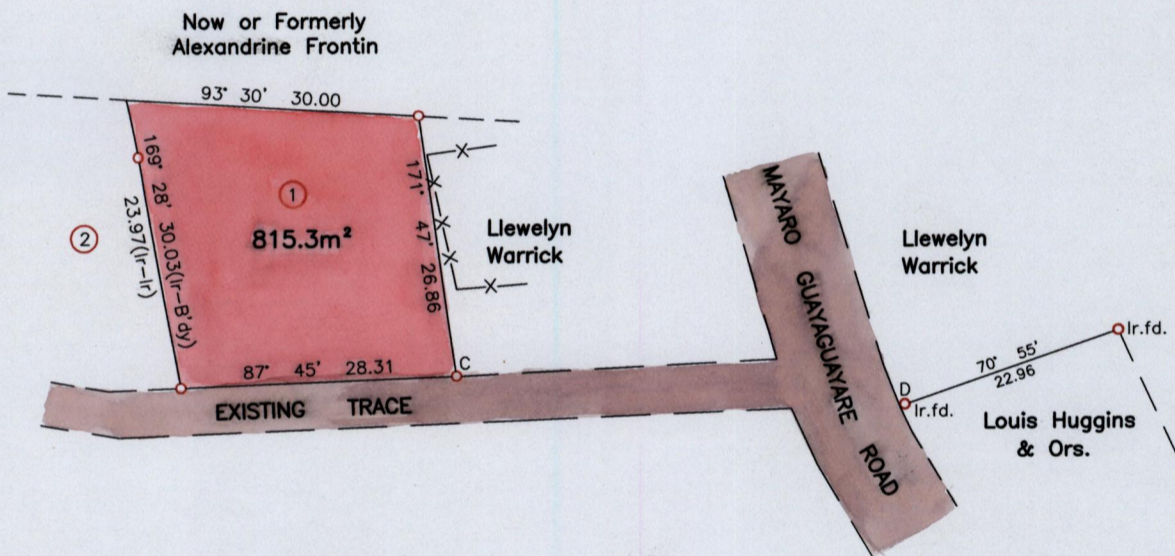

Logged  
(10)

C-D 93° 52' 49.98  
Wire Fence -x-x-x



SCALE 1/750  
Distances are in Metres

○ Denotes Iron put except otherwise stated  
 Bearings are Cassini Grid based on Solar Observations  
 Plan of a Parcel of land coloured pink in the Ward of Guayaguayare  
 Containing eight one five point three square metres  
 Surveyed by me with due authority, in September 2006 for Llewelyn Warrick  
 In accordance with Regulation 25 (1) of the Land Surveyors' Regulations 1998,  
 I certify that this plan is correct.

Entered

*Rawle Derrick*  
 .....  
 Trinidad & Tobago Land Surveyor September 20, 2006