

R.P.O Vol. 628 Fol. 153  
C.T. Vol. 1795 Fol. 157

Ward of Moruga.  
County of Victoria.  
Cadastral Sheet G.14.G. 64D  
2/d

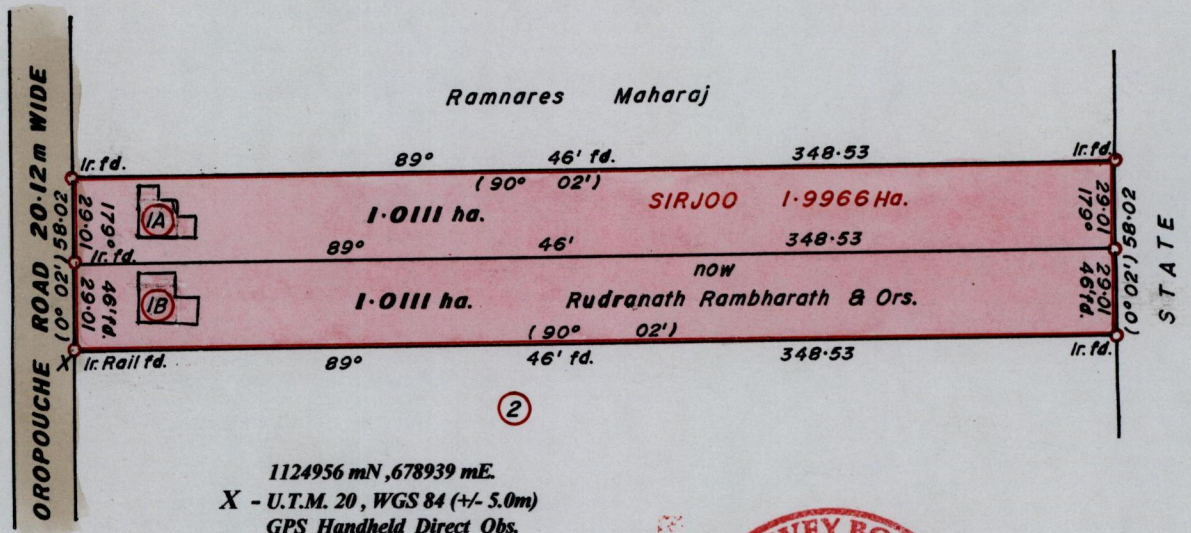

1124956 mN, 678939 mE.  
X - U.T.M. 20, WGS 84 (+/- 5.0m)  
GPS Handheld Direct Obs.

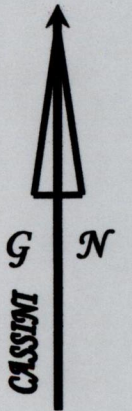
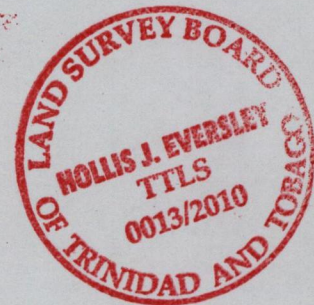

Bk. 1196 :643.

Bk. 1003 : 58.

SCALE 1 : 2500.

Distances are in METRES

o Denotes Iron Put except otherwise stated  
Bearings are Cassini Grid based on Solar Observations.

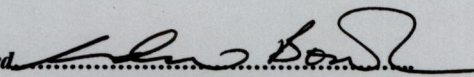
Approved   
Director of Surveys. 2010.12.31

**PLAN of 2 Parcels of land coloured in PINK in the Ward of Moruga.  
Containing together two point zero two two two hectares.  
Re-Surveyed by me, with due authority, in February 2010, from previous survey  
done by Mr. Ramcharan (T.T.L.S.), in November 1992.  
In accordance with Reg. 25(1) of the Land Surveyors' Regulations 1998,  
I certify that this plan is correct.**

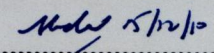
Checked by 

Entered .....

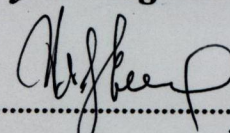
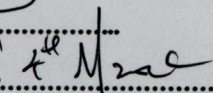
  
Trinidad and Tobago Land Surveyor  2010.