

REMAINING PORTION

R.P.O.Vol. 77

Fol. 187

Ward of Siparia

County of St. Patrick

C.T.Vol. 1010

Fol. 237

Cadastral Sheet G.13.J. 63F

U.P.R.N.

3/a

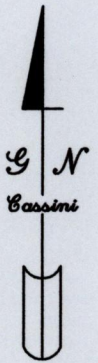
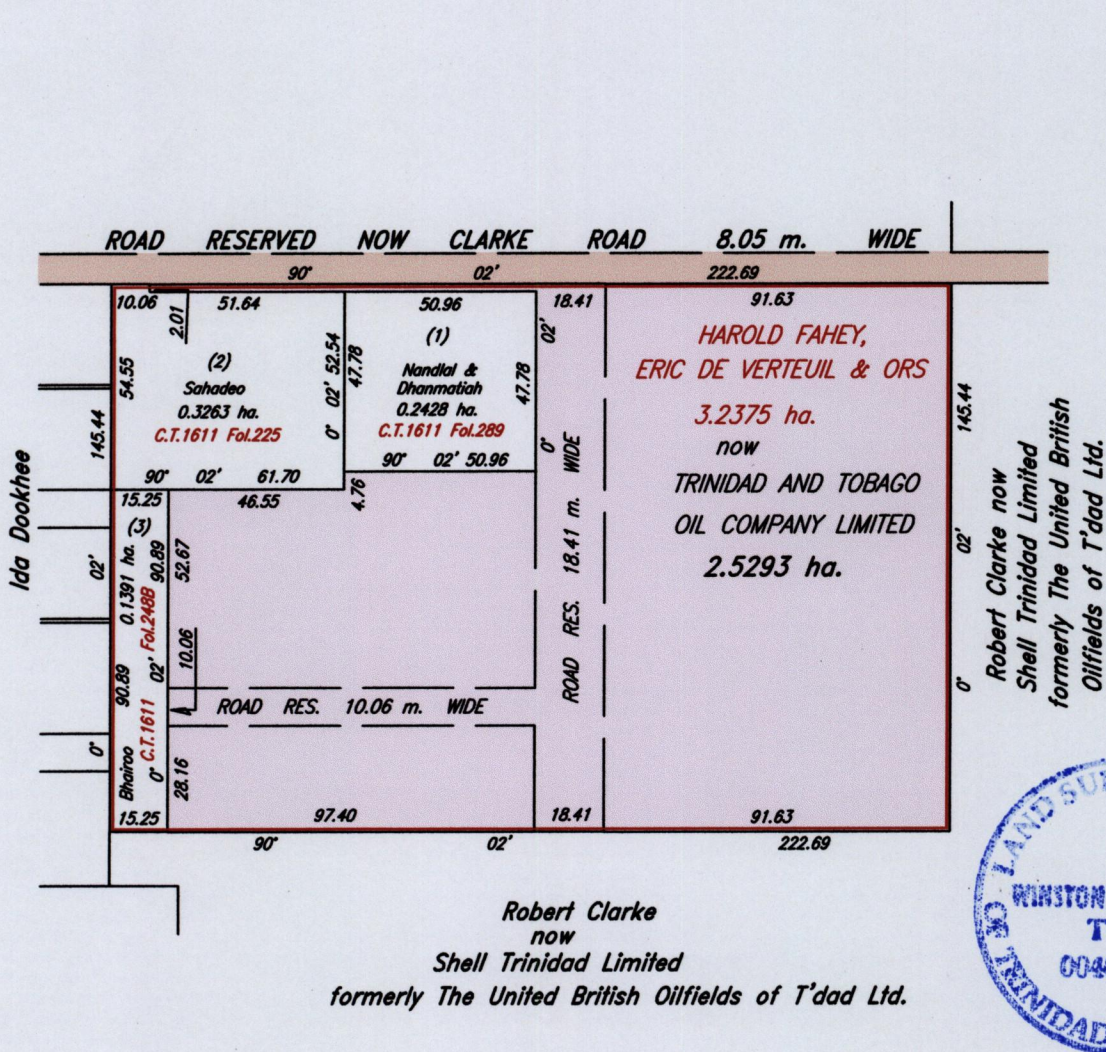

Bk. 966/42
Original Bk. 390/42

Approved
[Signature]
Director of surveys 2011.2.3

SCALE:- 1:2000
Distances are in metres.

Note: To obtain compass bearing subtract 02 minutes

This is a true copy of a diagram of three point two three seven five hectares originally transferred to HAROLD FAHEY, ERIC DE VERTEUIL & ORS shewing a portion coloured pink and containing two point five two nine two hectares being the remainder after three previous transfer of another portion of land In accordance with rule 25 (1) of the Land Surveyors' Regulations 1998, I certify that this plan is correct.

Checked by *[Signature]* *[Signature]*
Entered on.....Trinidad and Tobago Land Surveyor18th January 2011