

R.P.O Vol. 745 Fol. 47
C.T. Vol. 2469 Fol. 161
C.T. Vol. 5558 Fol. 51
Process ID # 39154

Ward of Siparia.
County of St. Patrick.
Cadastral Sheet G.14.E&F. 64D
1/c; 1/d

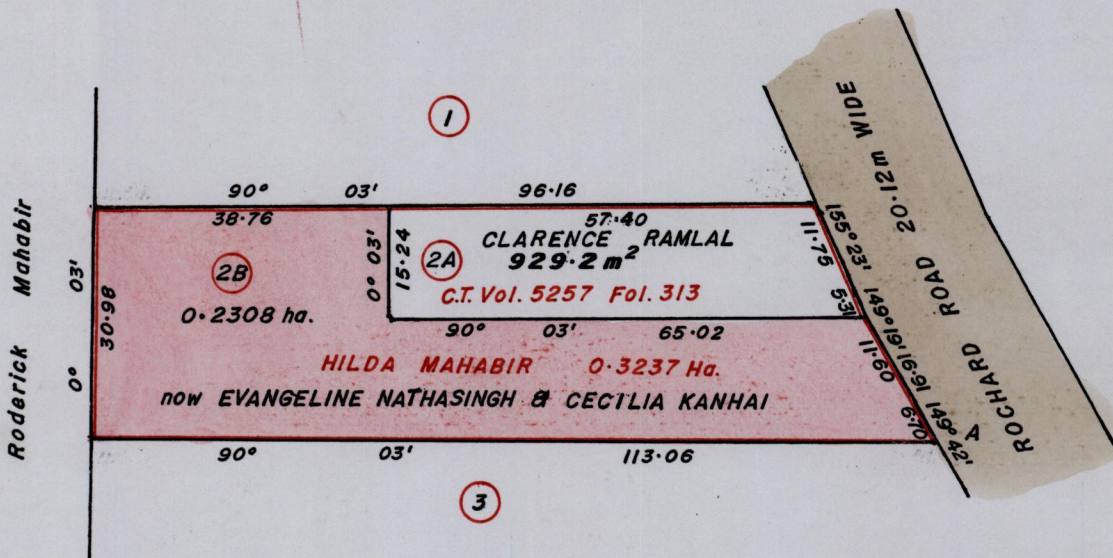
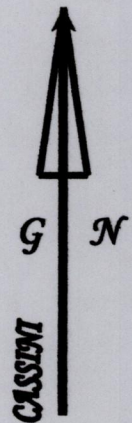

A
1124924 mN, 675885 mE.
U.T.M. 20, WGS 84 (+/-5.0m)
GPS Handheld Direct Obs.

Bk. 1110 : 46
" 1336 : 32
SCALE 1 : 1000.
Distances are in METRES

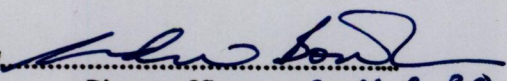
Approved 
Director of Surveys. 2011.9.30

This is a true copy of a diagram of zero point three two three seven hectare, Originally transferred to HILDA MAHABIR showing a portion, Coloured pink and containing zero point two three zero eight hectares, being the remainder, after one previous transfer of another portion of the land. In accordance with Reg. 25(1) of the Land Surveyors' Regulations 1998, I certify that this plan is correct.

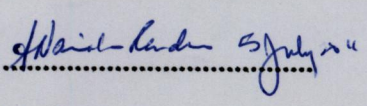
Checked by 
.....

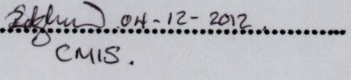
Entered  04-12-2012
CMIS.

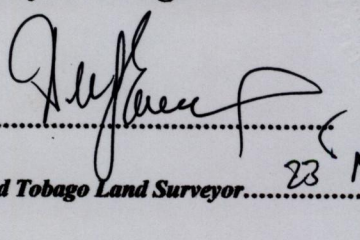
Trinidad and Tobago Land Surveyor..... 2011.