

1376 97

197

R.P.O. Vol. Fol.
C.T. Vol. 3016 Fol. 303



43F
Cadastral Sheet 3/c (D.22.B.)
Ward of Pointe-a-Pierre
County of Victoria

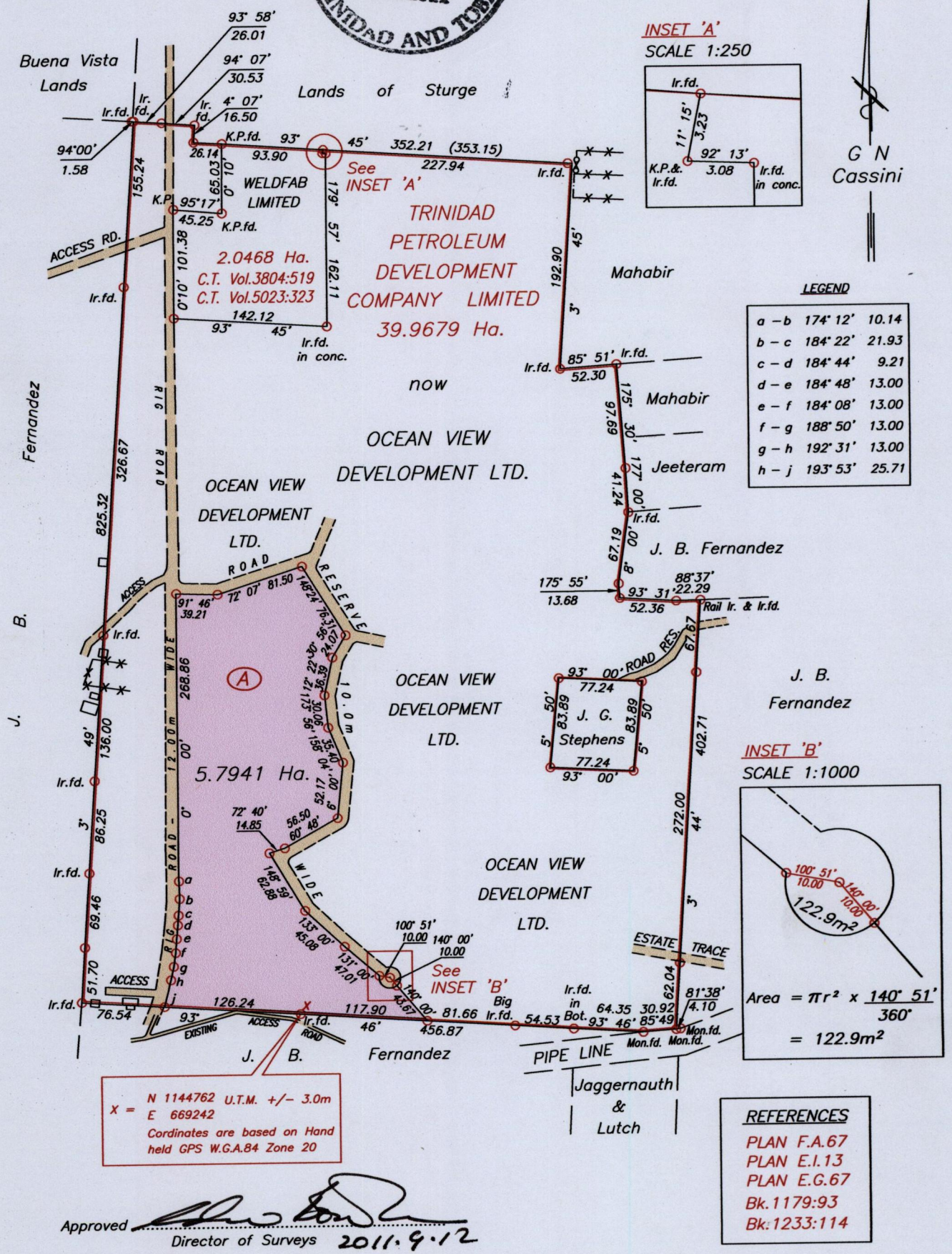

○ Denotes Iron put unless otherwise stated
Bearings are Cassini Grid based on Solar observations

SCALE 1:5000
Distances are in METRES

PLAN of a Parcel of land coloured pink in the Ward of Pointe-a-Pierre
Containing five point seven nine four one hectares
Surveyed by me, with due authority, in December 2008
In accordance with Regulation 25 (1) of the Land Surveyors' Regulations 1998,
I certify that this Plan is correct.

Checked by *[Signature]* *[Signature]*
Entered on Trinidad & Tobago Land Surveyor *[Signature]* 7th September 2011