

R.P.O. Vol. 308 fol. 633

C.T. Vol. 4554 fol. 495

Cadastral Sheet G.13.G. $\frac{63F}{1/b,1/d}$

Ward of Naparima

County of Victoria

Debe

Process ID# 38542

Vide Bk. 1271 fol. 293
Vide Bk. 1010 fol. 135
Vide Bk. 980 fol. 23
Vide Bk. 427 fol. 178
Vide Plan J.L. 21

671718mE, 1126455mN
(U.T.M. 20, WGS 84 (+/-4m))
Co-ordinates obtained from
Hand Held G.P.S.

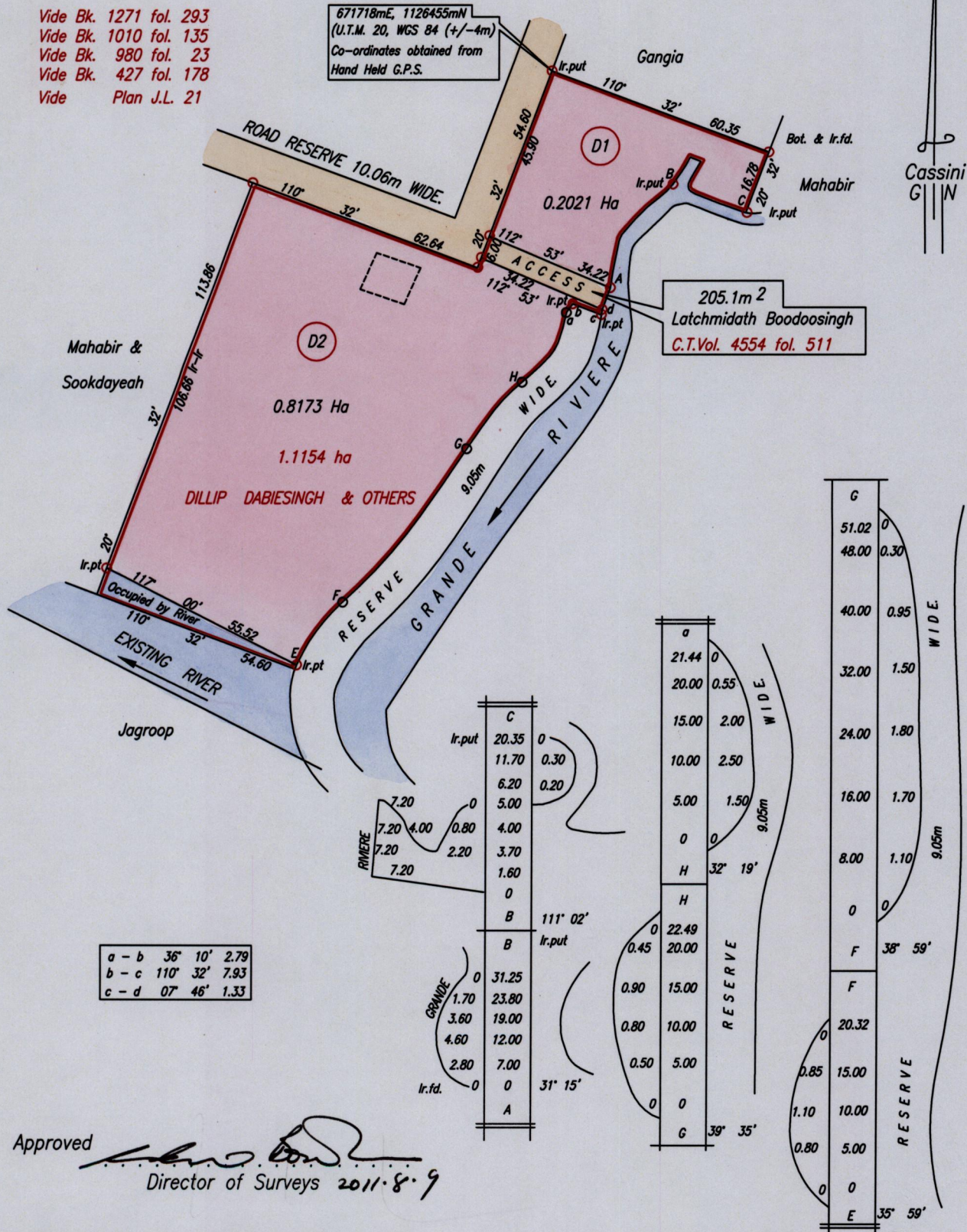

a - b	36° 10'	2.79
b - c	110° 32'	7.93
c - d	07° 46'	1.33

Approved

[Signature]
Director of Surveys 2011.8.9

oDenotes Iron found except otherwise stated.

Bearings are Cassini Grid based on Solar Observations

Plan of 2 Parcels of land coloured pink in the Ward of Naparima

Containing together one point zero one nine four hectares

Surveyed by me, with due authority, in September, 2008

In accordance with Regulation 25(1) of the Land Surveyors' Regulations 1998,

I certify that this plan is correct.

Checked by: *[Signature]* 11.07.13

[Signature]

Entered CMS 09-2012

Trinidad & Tobago Land Surveyor 11th May 2011.

PATH = ADA004 C:/DEO\Dabesingh2.dwg

SCALE 1:1500
Distances are in Metres

