

Ward of Moruga  
County of Victoria  
Cadastral Sheet ( G.14.G ) 64.D.  
2/d

REMAINING PORTION

R.P.O. Vol. 649 Fol. 159  
C.T. Vol. 3968 Fol. 427  
C.T. Vol. 5576 Fol. 221  
Process SD # A0854

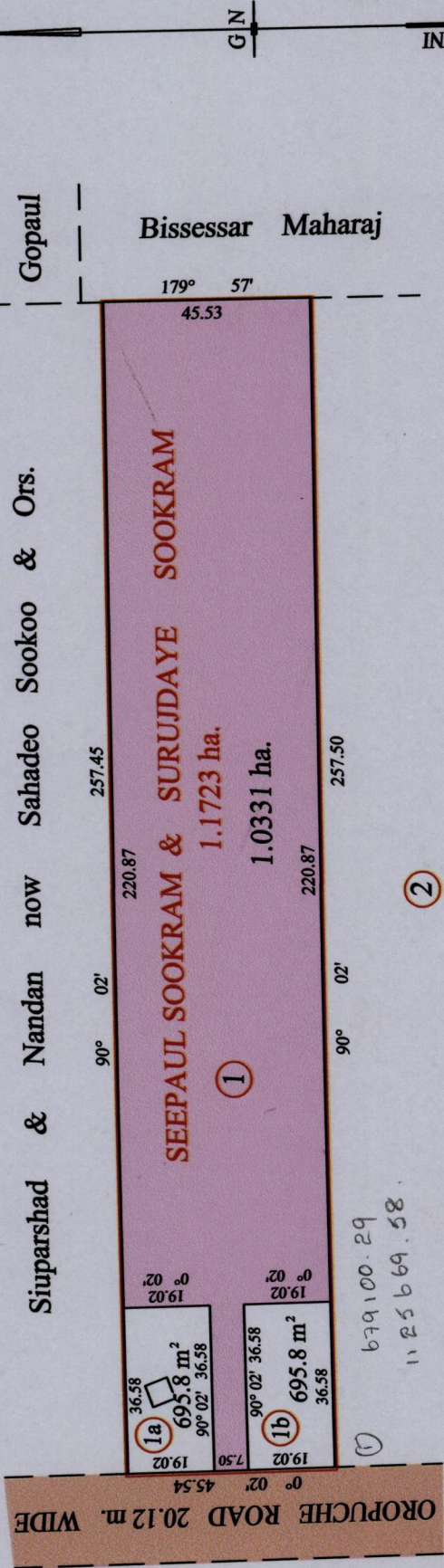

1376

182

Approved *[Signature]*  
Director of Surveys 2011.8.19

SCALE : 1:1500  
Distances are in metres

Note: Bearings are cassini grid based on solar observations  
This is a true copy of a diagram of one point one seven two three hectare, originally transferred to Seepaul Sookram & Surujdaye Sookram, shewing a portion coloured pink and containing one point zero three three one hectares being the remainder after two (2) previous transfer of another portion of the land.  
In accordance with Regulation 25 (1) of the Land Surveyors' Regulations 1998,  
I certify that this plan is correct.

At Station (A)  
E 0678902  
N 1125485  
Reading taken with  
Handheld G.P.S.  
U.T.M. Zone 20  
Naparima  
+ 5 m.

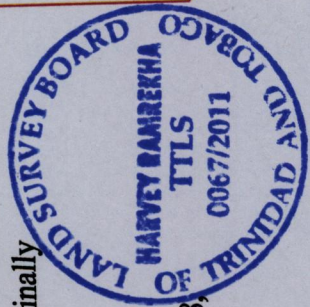

Vide Bk. 1247 fol. 17

1a Anil Pooran,  
Sangeeta Pooran & Ors.  
C.T. Vol. 4629 Fol. 7

1b Chaitram Andrew Jagmohan &  
Carolyn Ramsuchit Jagmohan  
C.T. Vol. 4629 Fol. 15

Checked by *[Signature]* 15.06.2011

Entered on *[Signature]* 15.06.2011  
Trinidad & Tobago Land Surveyor

1876/182