

R.P.O. Vol. 183 fol. 591
C.T. Vol. 4579 fol. 427

Ward of Siparia
County of St. Patrick
Cadastral Sheet (G.18. H.) $\frac{73 C}{4/a}$

Bk.406 fol. 74

Process ID # 40934

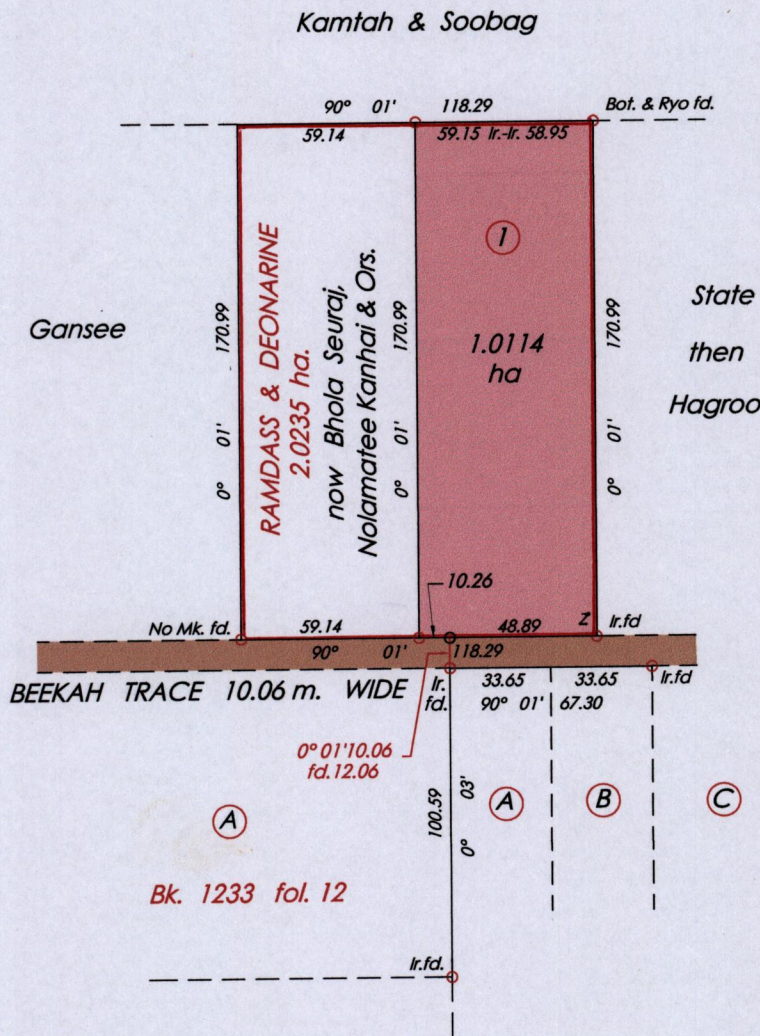

Bk. 1233 fol. 12

Z = N. 1119091 E. 672255
U.T.M. Zone 20 Naparima +/- 5.00 m.
Hand Held G.P.S.

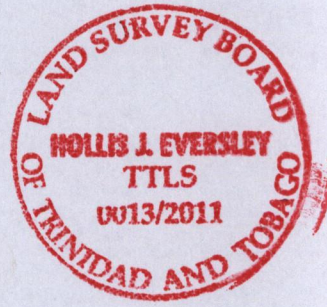

SEE 1395:218

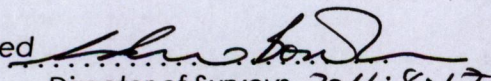
Approved 
Director of Surveys 2011.8.17

○ Denotes Iron Put Except
Otherwise Stated

SCALE : 1 : 2500

Note: Bearings are cassini grid based on solar observations Distances are in metres
PLAN of a Parcel of land coloured pink in the Ward of Siparia
Containing one point zero one one four hectares
Surveyed by me, with due authority, in Dec. 2010
In accordance with Regulation 25 (1) of the Land Surveyors' Regulations 1998,
I certify that this plan is correct.

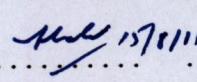
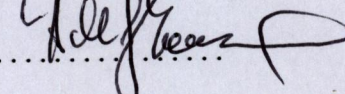
Checked by  

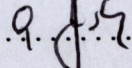
Entered on C.M.S. Form 2013 Trinidad & Tobago Land Surveyor  2011