

1118905mN, 673829 mE.
X - U.T.M. 20, WGS 84 (+/-5.0m)
GPS Handheld Direct Obs.

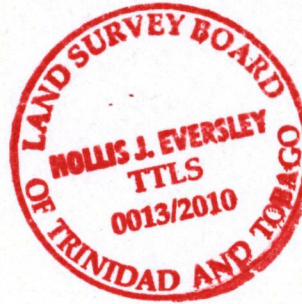
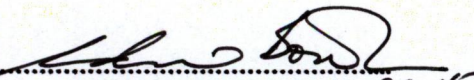

Approved 
Director of Surveys. 2011-8-15

Bk. 993 : 130.
SCALE 1 : 5000.

Distances are in METRES
o Denotes Iron Put except otherwise stated
Bearings are Cassini Grid based on Solar Observations.

PLAN of 2 Parcels of land coloured in PINK in the Ward of Siparia.
Containing together eight point two ~~eight nine six~~ hectares.
Surveyed by me, with due authority, in May 2009.
In accordance with Reg. 25(1) of the Land Surveyors' Regulations 1998,
I certify that this plan is correct.

Checked by  25/2/11
Entered

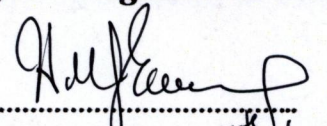
Trinidad and Tobago Land Surveyor..... 15th Nov 2010

Original 993/130

	E2	
	1.79	
	E	50°33'
	E1	
	13.06	
	E2	0°06'
	F	
10.06	15.42	10.06
10.06	0	10.06
	E	50°33'
10.06	21.44	10.06
10.06	0	10.06
	D	30°58'
10.06	42.62	10.06
10.06	0	10.06
	C	355°21'
10.06	38.61	10.06
10.06	0	10.06
	B	335°05'
10.06	21.45	10.06
10.06	0	10.06
	A	0°06'

Kowsil
Gunness

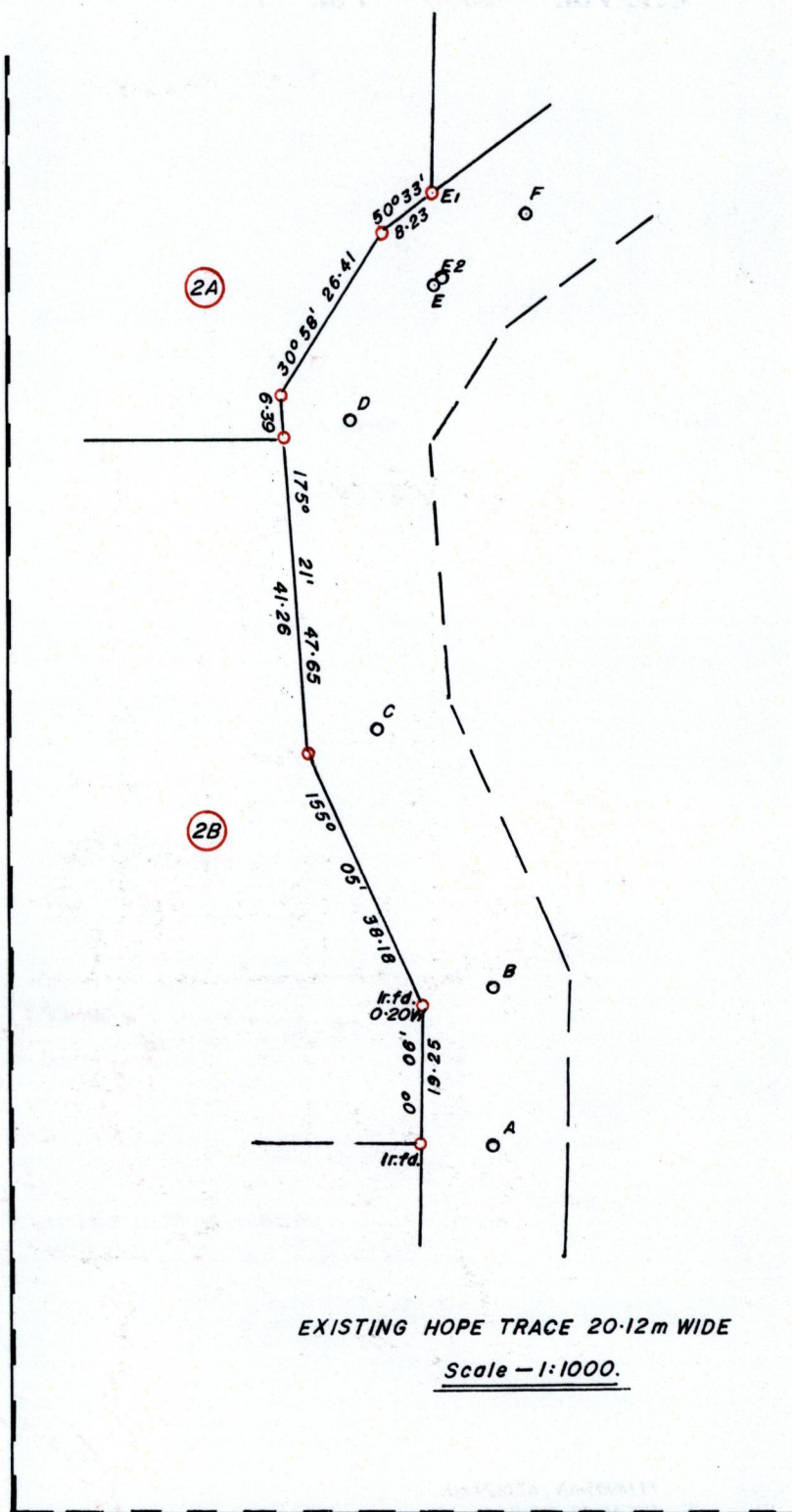

1376/155