

Process ID 39749

R.P.O. Vol. 633 Fol. 119

C.T. Vol. Fol.

1376

145

Cadastral Sheet B.17.F.13E
4/d

Ward of St. Anns

County of St. George

BK.580 Fol.268
Plan P.K.82

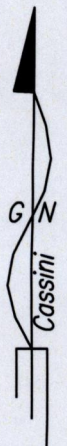

REMAINING PORTION

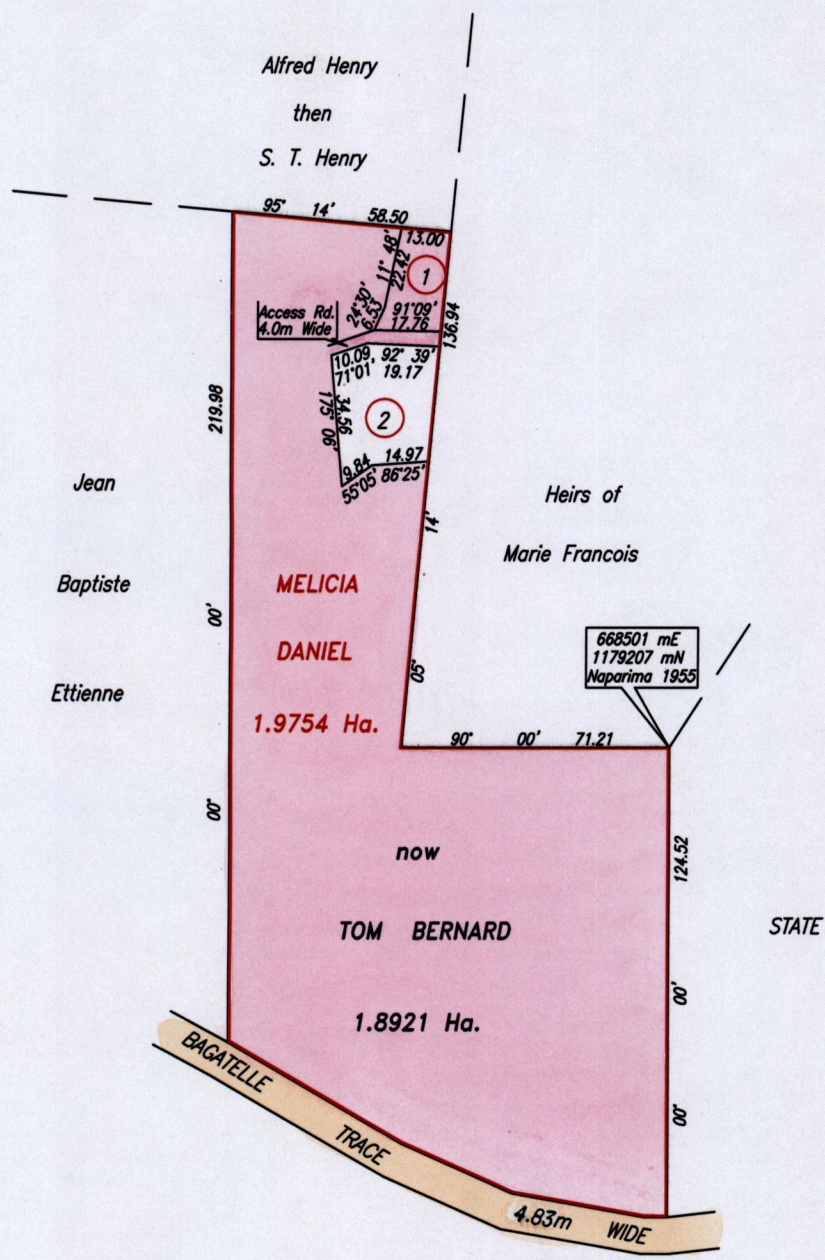

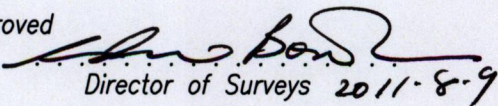
Approved 
Director of Surveys 2011-8-9

LOT	NAMES	AREA	C.T.Vol.
2	Marilyn Scilla Durant & Michael Elvis Durant	832.5 m ²	Vol.4639 Fol.469

Coordinates obtained from Topo Data

SCALE 1:2000
Distances are in metres

This is a true diagram of a parcel of land in the Ward of St. Anns
Containing one point nine seven five four hectares originally granted to MELICIA DANIEL
Showing a portion coloured pink and containing one point eight nine two one hectares
Being the remainder after one previous transfer of a portion of the land.
In accordance with Regulation 25 (1) of the Land Surveyors' Regulations 1998,
I certify that this plan is correct.

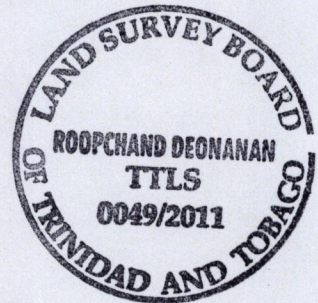

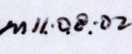
Checked by  11.08.07

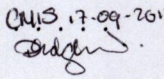
Entered on  17.09.2012
Trinidad & Tobago Land Surveyor. 6th June 2011.
PATH = ADA004 C:/DEO/REMAIN DWG