

STA	BEARING	DIST.	STA	BEARING	DIST.
P-H	04° 12'	35.68	R-S	191° 33'	15.00
H-B	88° 19'	75.74	S-T	190° 31'	29.42
B-B1	84° 37'	23.57	A-B	11° 51'	119.35
B-C	96° 44'	68.04	A-A1	107° 59'	60.92
C-D	116° 38'	83.07	A1-A2	107° 59'	47.43
D-E	143° 33'	40.70	A2-A3	101° 08'	40.32
E-F	274° 27'	3.19	A3-A3'	203° 42'	3.75
R-P	351° 30'	3.35			

1376

131

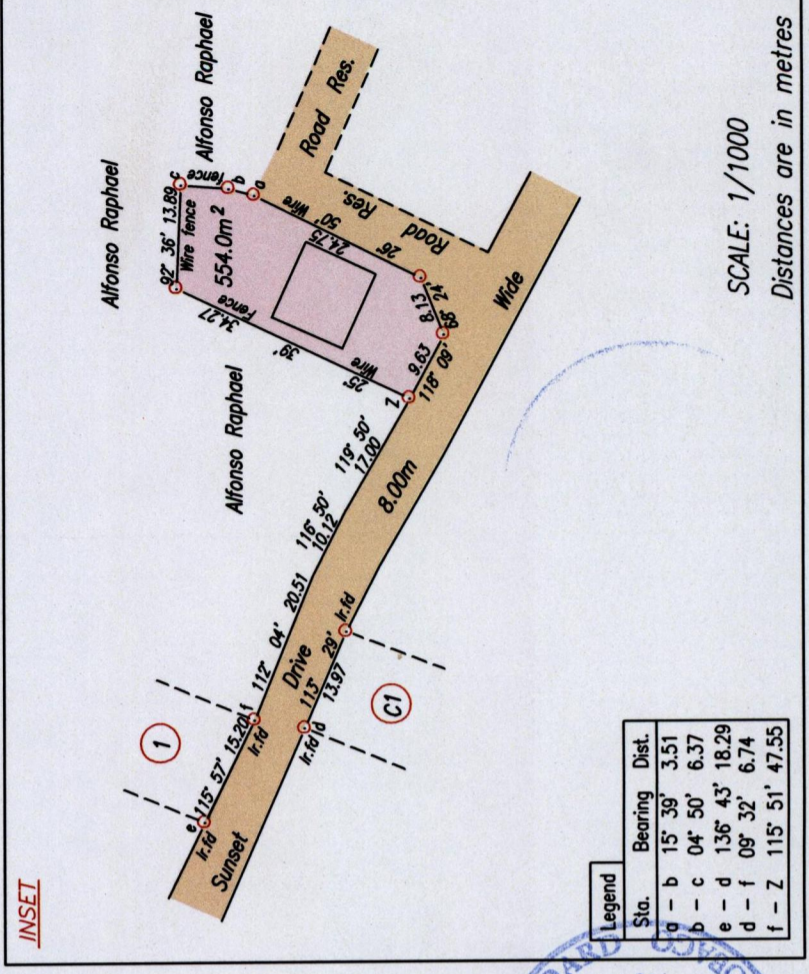

Legend	Sta.	Bearing	Dist.
a	b	15° 39'	3.51
b	c	04° 50'	6.37
c	d	136° 43'	18.29
d	e	09° 32'	6.74
e	f	115° 51'	47.55

LOT #	NAME	C.T. VOL. : FOL.	AREA
(C)	BAIROB SINGH & SOOKMIN SINGH	3323 : 9	475.6m ²
(1)	VICTORIA ANDREWS & MARTIN ANDREWS	4452 : 153	920.0m ²
(A)	MARILYN GLAUD	3245 : 449	444.8m ²
(4)	LENNARD HICKSON	4831 : 207	542.8m ²

SCALE 1/3000
 Distances are in metres

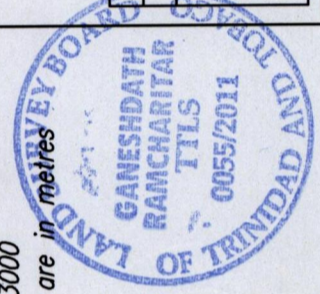

Approved *Moses Harrison*
 Director of Surveys 2011.6.2
 Co-ordinates obtained by Hand Held G.P.S. (WGS84 U.T.M. Zone)
 Pt. Z
 Accuracy ± 5m
 E 706593m
 N 1177875m

Denotes Iron put except otherwise stated
 Bearings are Cassini Grid based on Solar Observations
 Plan of a Parcel of land coloured pink in the Ward of Manzanilla
 Containing five hundred and fifty four point zero square metres
 Surveyed by me, with due authority, on September 1st 2010
 In accordance with Regulation 25 (1) of the Land Surveyors' Regulations 1998,
 I certify that this plan is correct.

Entered on
 Checked by *Mrs. 26/5/2011* Trinidad & Tobago Land Surveyor 2011

SCALE: 1/1000
 Distances are in metres