

R.P.O. Vol. 16

Fol. 163

Cadastral Sheet E.I.F. 25E/3/d

C.T. Vol. 1282

Fol. 305

Ward of Turure

County of St. Andrew

Vide Bk.157 Fol. 47

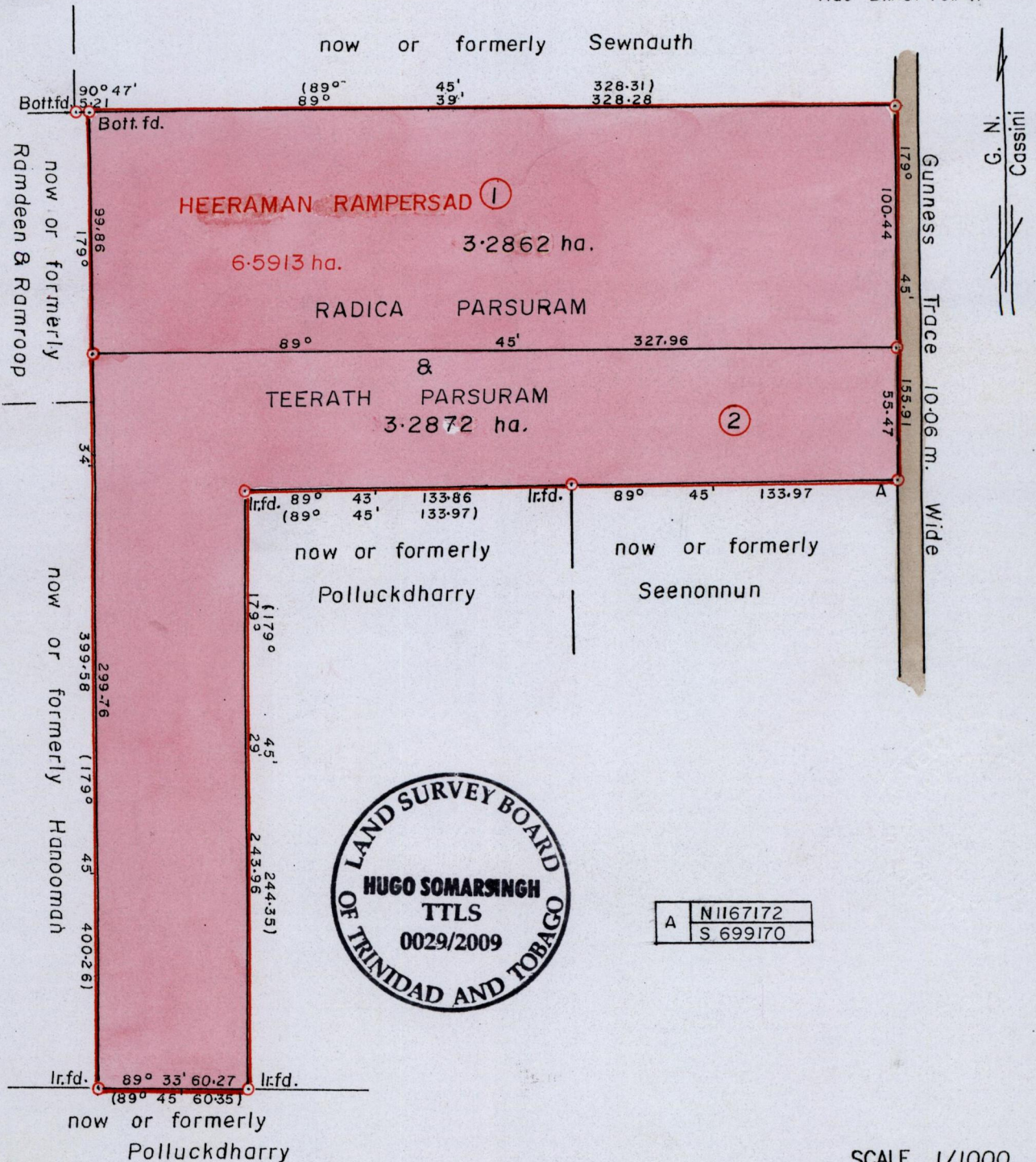

A	N 1167172
	S 699170

SCALE 1/1000

Distances are in metres

Approved

[Signature]
 Director of Surveys 2011.5.27

○ Denotes Iron put except where otherwise stated

Coordinates based on hand held G.P.S. (Naparima 20) ± 5m.
 Bearings are based on Solar Observations.

PLAN of 2 Parcelsof land coloured pink in the Ward of Turure.
 Containing together six point five seven three four hectares.
 Surveyed by me, with due authority, in May 2008 for Radica Parsuram.
 In accordance with Regulation 25 (1) of the Land Surveyors' Regulations 1998,
 I certify that this plan is correct.

Checked by *[Signature]* 24/10/2011

[Signature]

Entered on.

Trinidad & Tobago Land Surveyor. *[Signature]* 2009.