

1375

6

R.P.O. Vol. 37

Fol. 641

Vide Bk. 172 Fol. 192
Plan C.J.42 - S.O. 186/57
Plan M.A. 44



located
(2)

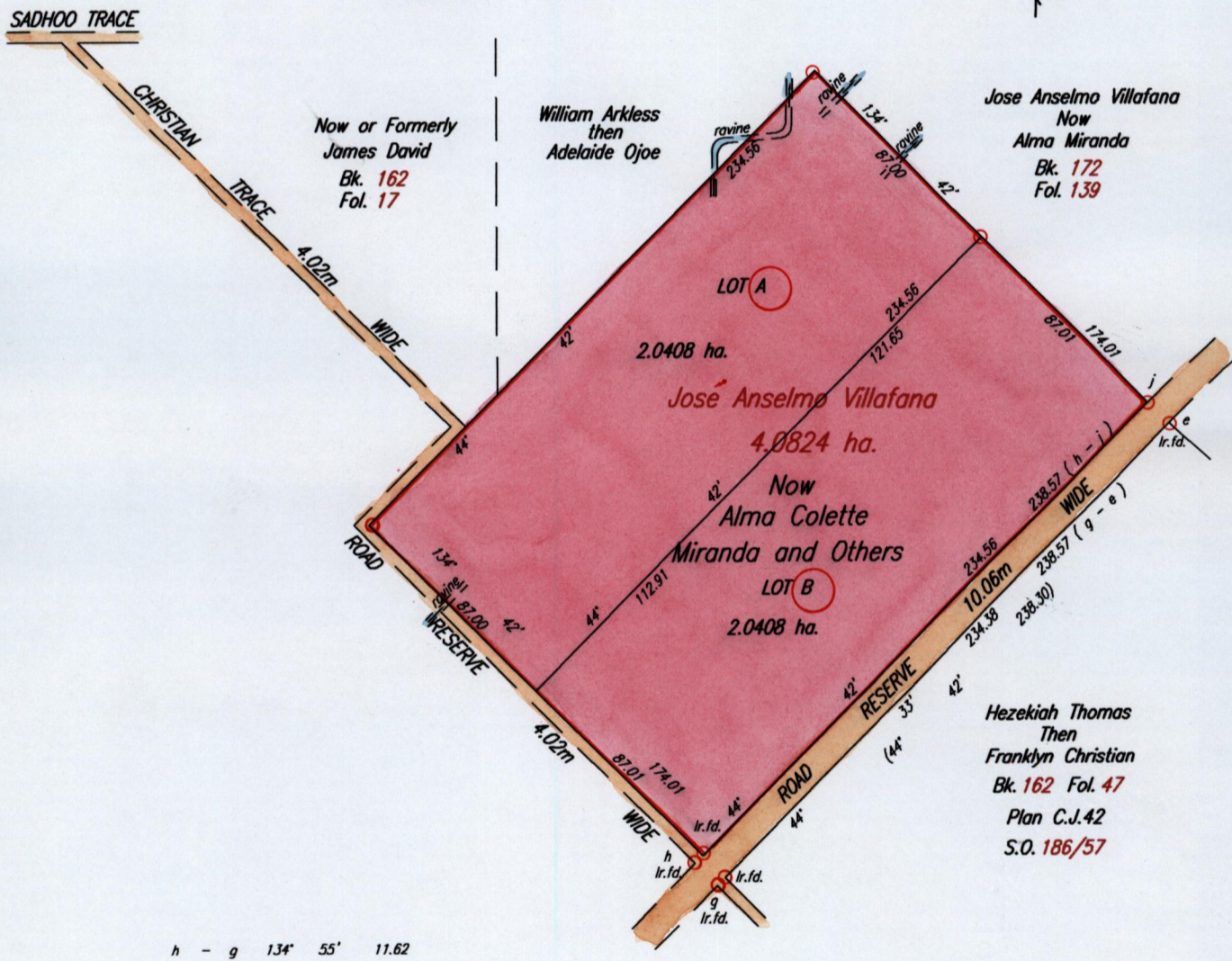
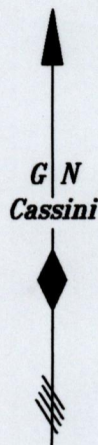

h - g 134° 55' 11.62

Approved
Director of Surveys
2006.6.9

SCALE 1:2500

Distances are in METRES

○ Denotes Iron put except where otherwise stated

Bearings are Cassini Grid based on Solar Observations

PLAN of 2 Parcels of land coloured pink in the Ward of Turure
Containing together four point zero eight one six hectares
Surveyed by me, with due authority, in June & October 2004

In accordance with Regulation 25 (1) of The Land Surveyors' Regulations 1998,
I certify that this plan is correct.

Checked by
2006.6.5

Camille Fortune-Rollock, TTLS

Entered on

Trinidad & Tobago Land Surveyor 26th May 2006
C:\LESS 2004\ANGELA & MIRANDA\INGRID\00