

R.P.O. Vol. 621 fol. 501  
C.T. Vol. 1022 fol. 203

Ward of Siparia  
County of St. Patrick  
Cadastral Sheet ( G. 13 F.)  $\frac{63 F.}{4/a}$

Bk. 599 fol. 98

located  
(15)

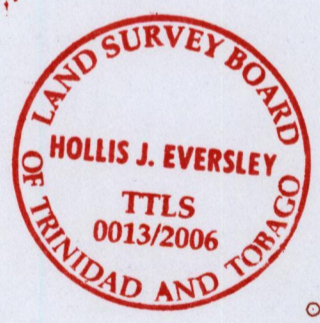
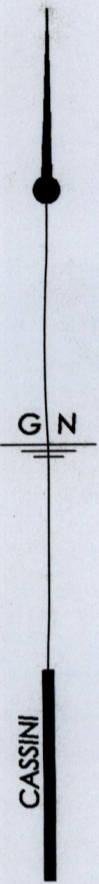
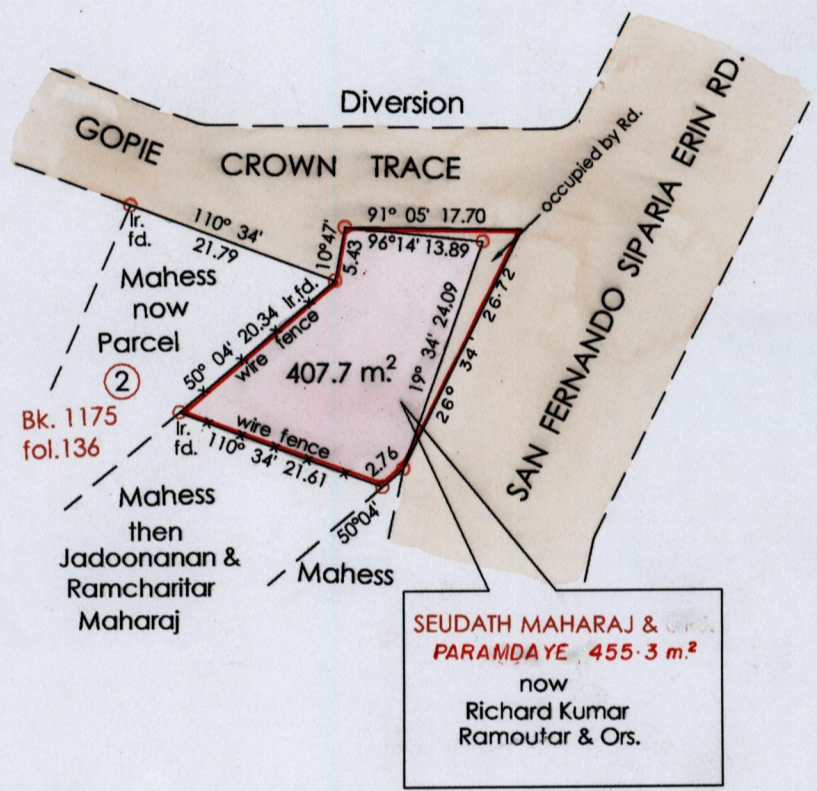

Approved *[Signature]*  
Director of Surveys  
2006.6.26

○ Denotes Iron Put Except  
Otherwise Stated

SCALE : 1 : 750

Note: Bearings are cassini grid based on solar observations Distances are in metres  
 PLAN of a Parcel of land coloured pink in the Ward of Siparia  
 Containing four hundred seven point seven sq. metres  
 Surveyed by me, with due authority, in March 2006  
 In accordance with Regulation 25 (1) of the Land Surveyors' Regulations 1998,  
 I certify that this plan is correct.

Checked by *[Signature]* 21/6/06

Entered on ..... Trinidad & Tobago Land Surveyor *[Signature]* 24<sup>th</sup> Mar 2006