

REMAINING PORTION

Cadastral Sheet G.12.H. 63F
Ward of Siparia 17/d
County of St.Patrick.

R.P.O. Vol. 49 Fol. 671
C.T. Vol. 1817 Fol. 195
Vide Plan B.C.47

cannot locate

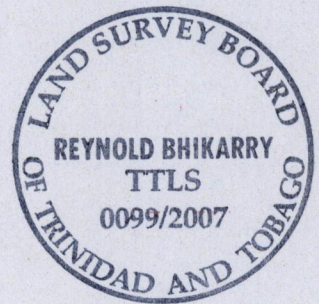
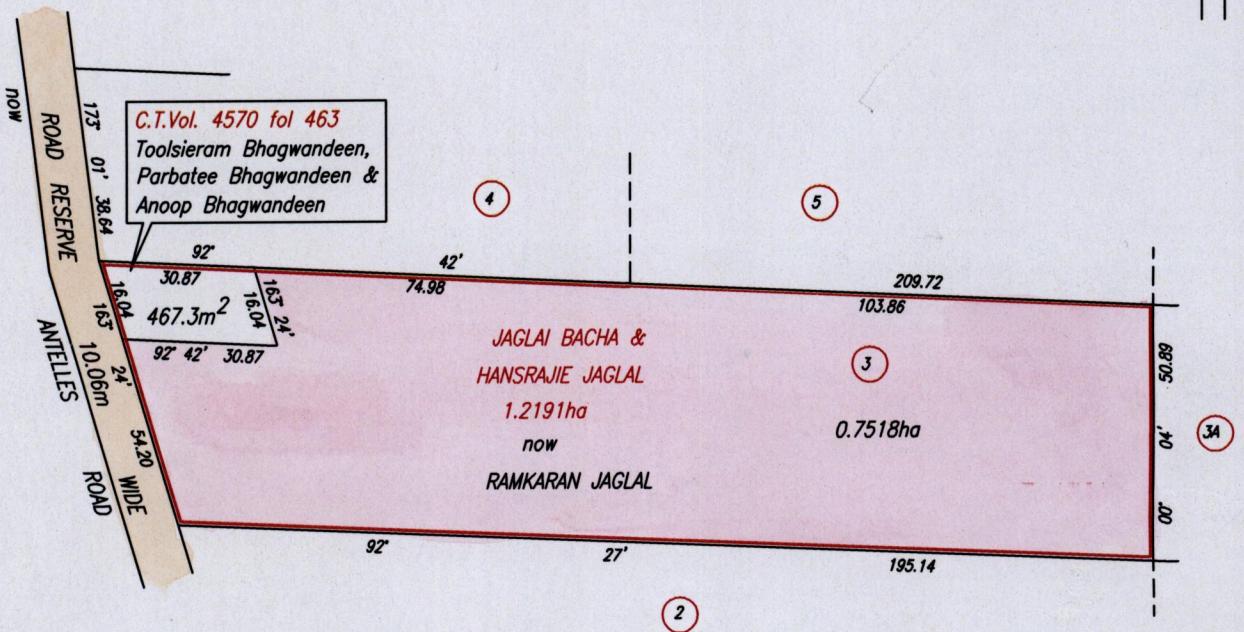
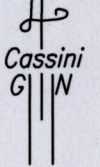

Approved *[Signature]*
Director of Surveys
2007.10.22

SCALE 1:1500
Distances are in Metres

This is a true copy of a diagram of a Parcel of land in the Ward of Siparia Containing one point two one nine one hectares originally transferred to JAGLAL BACHA & HANSRAJIE JAGLAL showing a portion coloured pink and containing zero point seven five one eight hectare being the remainder after one previous transfer of a portion of the land.

In accordance with Regulation 25(1) of the Land Surveyors' Regulations 1998, I certify that this plan is correct.

Checked by *[Signature]* *[Signature]*

Entered Trinidad & Tobago Land Surveyor 4th August 2007