

Not to cater

1375

1657

R.P.O. Vol. 233 Fol. 623

C.T. Vol. 2697 Fol. 347

Ward of Charuma

County of Nariva

Cadastral Sheet (E.21.I) 55.A. & 55.B.

Crown then Jams Dumante

2/d 1/c

then

Jams Dumante

89° 52' 87.11

LOUVINA PAYNE

AGUSTUS PAYNE &

LEONARD WILLIAM FARRELL

2.8328 ha.

now

ENDORA LEA FARRELL,

JOSEPH FARRELL &

VIDA DOROTHY HARRIS

Etwariah

Road Reserve 8.05 m. Wide

G N

CASSINI

Ramlal Maharaj

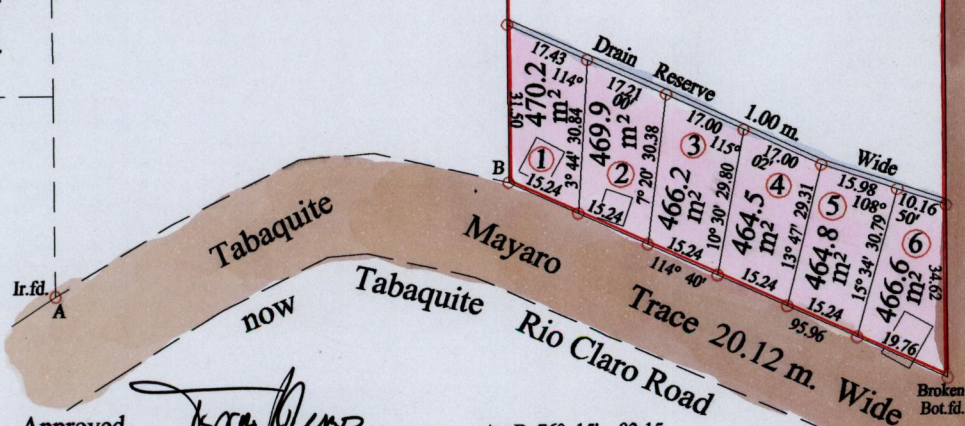

Approved

Director of Surveys

2006-12-04

A - B 76° 15' 93.15

Vide Bk. 275 fol. 326

Denotes Iron put except stated otherwise.

SCALE : 1:1500

Note: Bearings are cassini grid based on solar observations Distances are in metres

PLAN of 6 Parcels of land coloured pink in the Ward of Charuma Containing together two thousand eight hundred and two point two square metres Surveyed by me, with due authority, in August 2004

In accordance with Regulation 25 (1) of the Land Surveyors' Regulations 1998, I certify that this plan is correct.

Checked by

Entered on Trinidad & Tobago Land Surveyor 9.11.2006

