

REMAINING PORTION

R.P.O. Vol. Fol.  
C.T. Vol. 1620 Fol. 315

Ward of Siparia  
County of St. Patrick  
Cadastral Sheet ( G.11.H ) 63.D.  
1/c

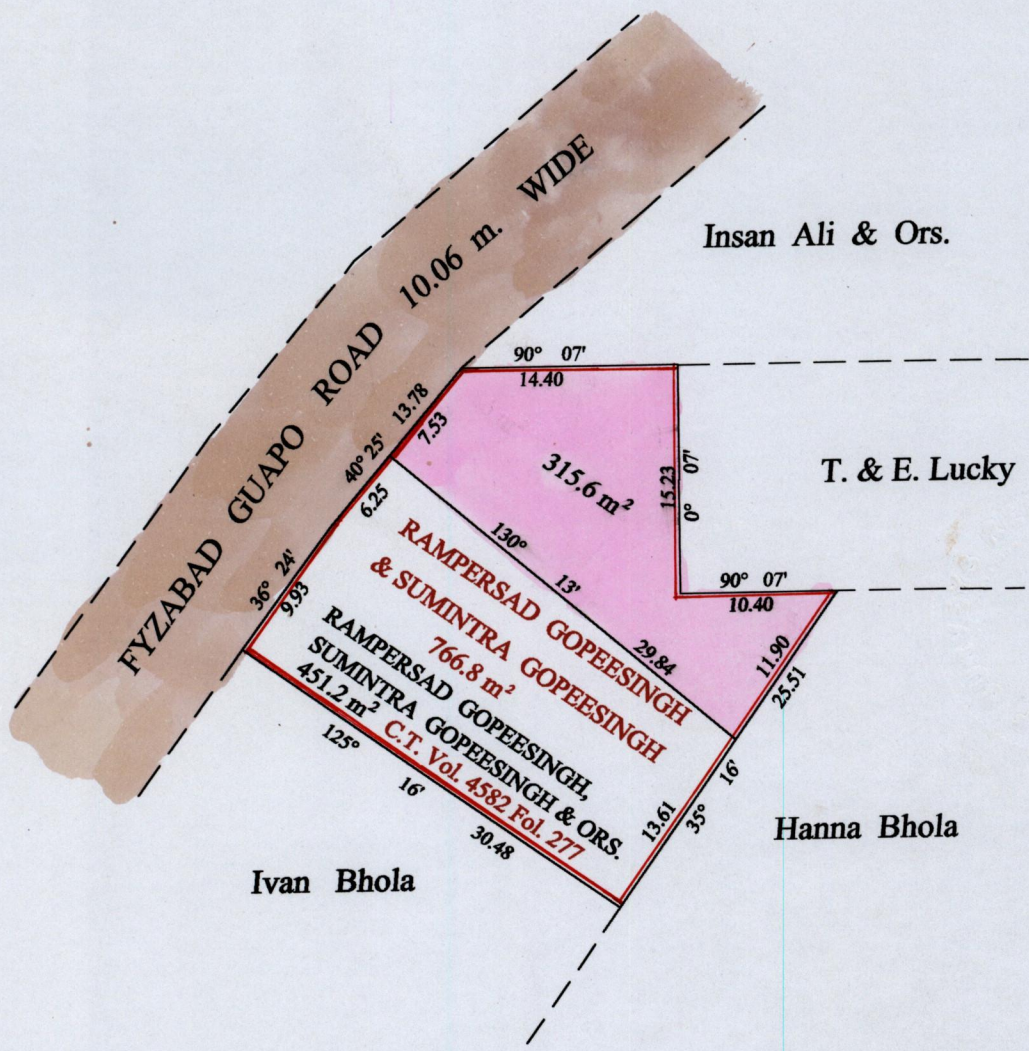

GN

CASSINI

Located @ 31

Vide Bk.968 fol.39

Approved *[Signature]*  
Director of Surveys

SCALE : 1:500

Note: Bearings are cassini grid based on solar observations

Distances are in metres

This is a true copy of a diagram of seven hundred and sixty six point eight square metres, originally transferred to Rampersad Gopeesingh and Sumintra Gopeesingh, showing a portion coloured pink and containing three hundred and fifteen point six square metres being the remainder after one (1) previous transfer of another portion of the land.

In accordance with Regulation 25 (1) of the Land Surveyor's Regulations 1998, I certify that this plan is correct.

Checked by *[Signature]* 15/11/06

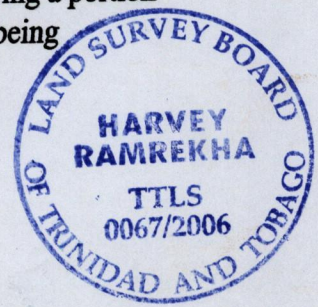

Entered on ..... Trinidad & Tobago Land Surveyor ..... 28.09 ..... 2006