

R.P.O. Vol. 283 Fol. 225
C.T. Vol. 3759 Fol. 207

Cadastral Sheet G.13.A.63E
Ward of Siparia.
County of St.Patrick.

Vide Bk. 1135 fol 501
Vide Bk. 1238 fol 109

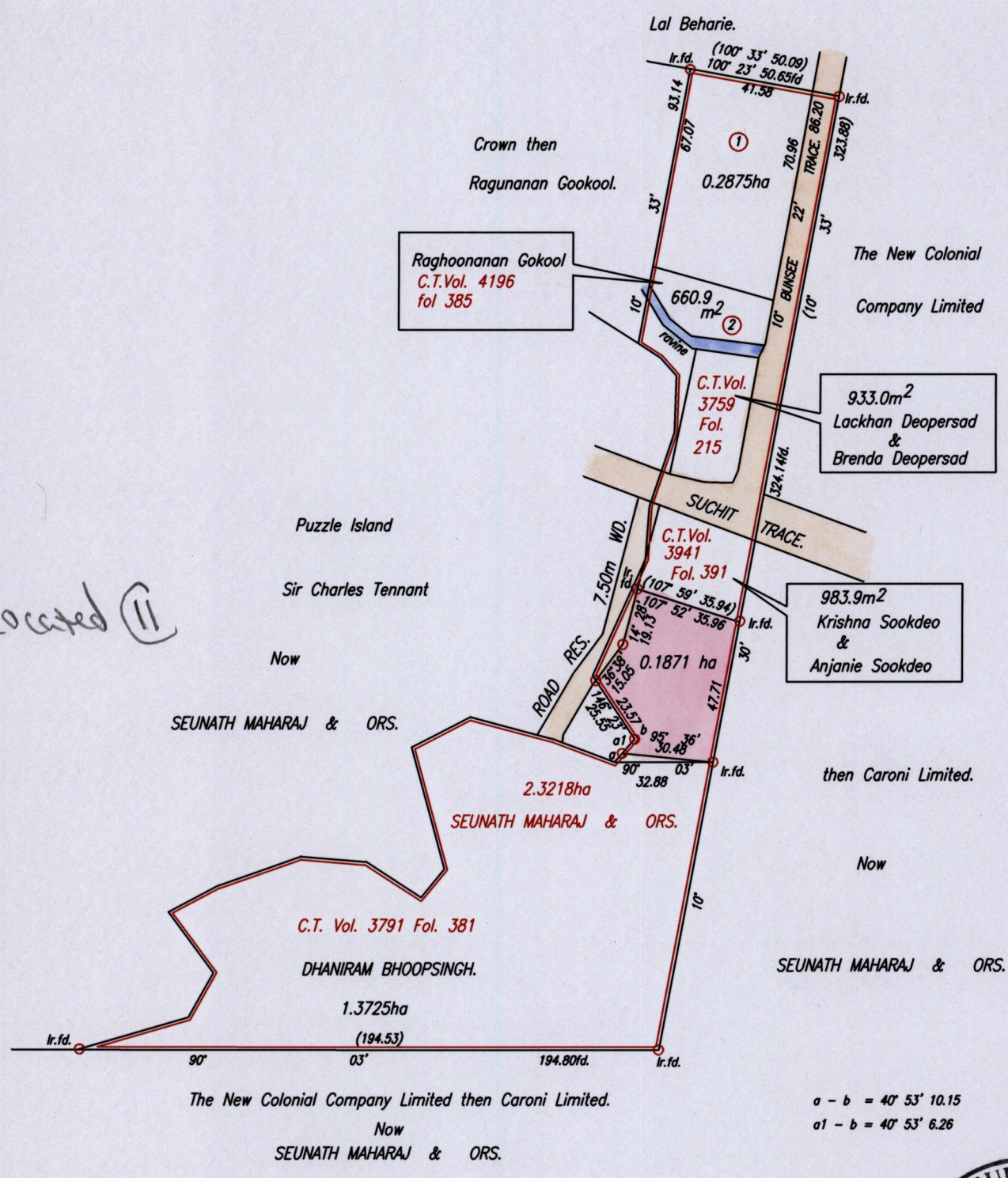
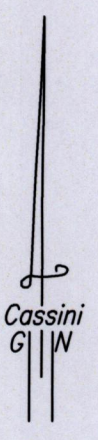

Located @

$$a - b = 40^{\circ} 53' 10.15$$

$$a1 - b = 40^{\circ} 53' 6.26$$

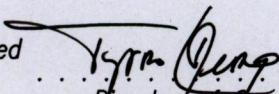
Approved 
 Director of Surveys
 2006-11-20

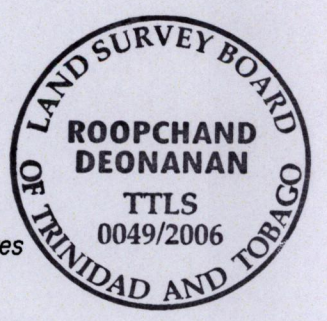

SCALE 1:2000
 Distances are in Metres

○ Denotes Iron put except otherwise stated.
 Bearings are (Cassini Grid) based on Solar Observations.
 PLAN of a Parcel of land coloured pink in the Ward of Siparia.
 Containing zero point one eight seven one hectare.
 Surveyed by me, with due authority, in June 2004.
 In accordance with Regulation 25(1) of the Land Surveyors' Regulations 1998,
 I certify that this plan is correct.

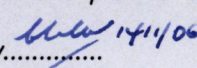
Checked by 

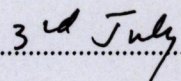
Entered on Trinidad & Tobago Land Surveyor  2006
 PATH = EV700 C:\Pisland\Smpo(T&C).dwg.