

Process 22#69457

1369/1369

51

To be brought under the provisions of the Real Property Ordinance

Ward of Ortoire
County of Victoria
Cadastral Sheet G.5.L., 54F
3/b

GEORGE VILLAGE

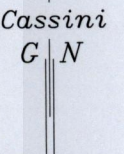
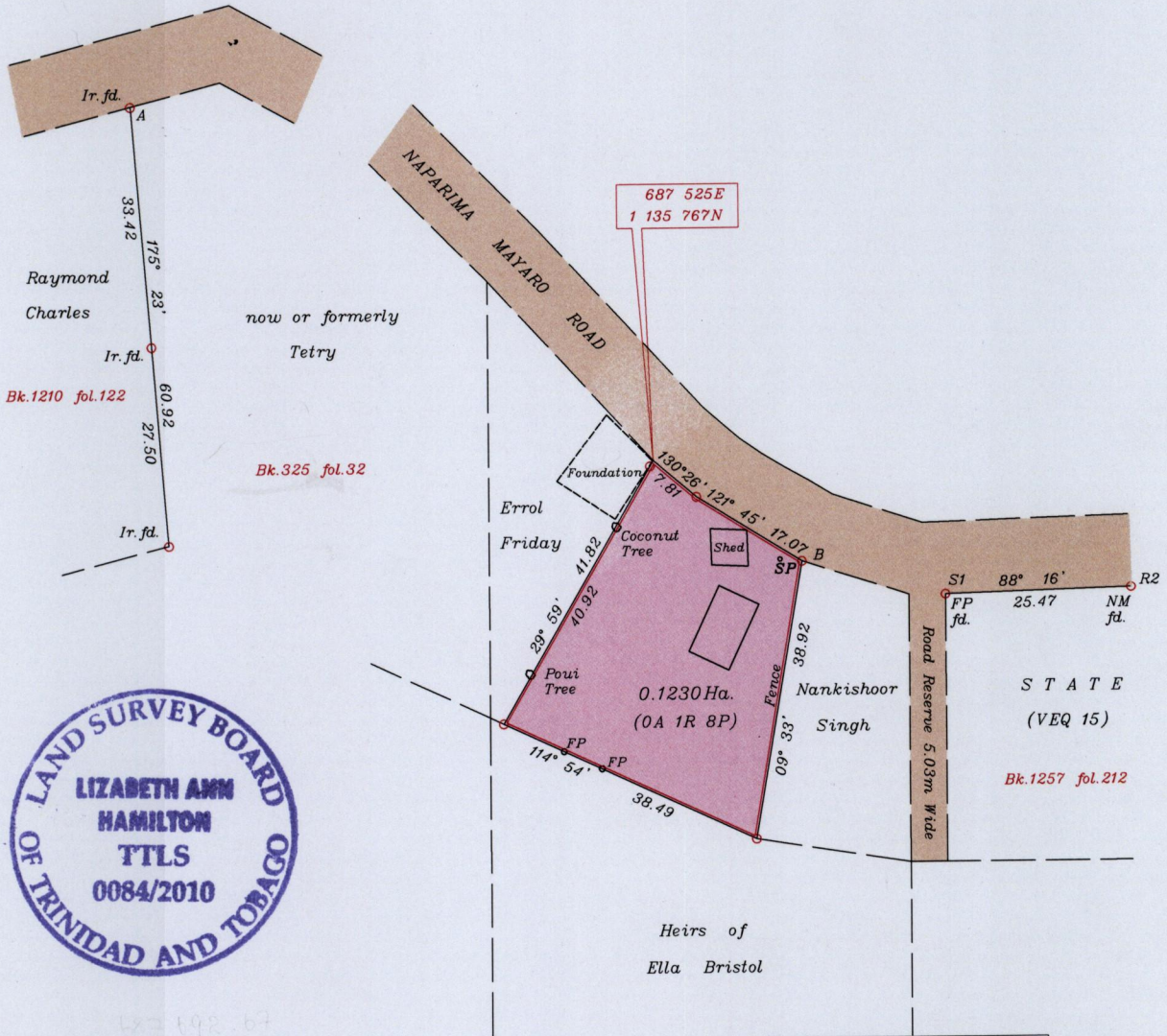

Line	Bearing	Distance
AB	124° 45'	156.76
B-S1	103° 39'	20.32
B-SP	275° 19'	3.04

oSP - Standpipe

Approved *[Signature]*
Director of Surveys 2011.2.2

Co-ordinates are U.T.M. Zone 20 Naparima Datum +/-5m obtained from handheld G.P.S.

SCALE 1:1000

o denotes Ir.pt. unless otherwise stated

Bearings are Cassini Grid based on Solar Observations

Distances are in metres

PLAN of a Parcel of land coloured pink in the Ward of Ortoire

Containing zero point one two three zero hectares

Surveyed by me, with due authority, on September 30, 2010 for Essau Arcoy

In accordance with Regulation 25(1) of the Land Surveyors Regulations 1998,

I certify that this plan is correct.

Checked by *[Signature]* 21.01.2011

Entered *[Signature]* 7.08.2013

[Signature]
Trinidad & Tobago Land Surveyor October 06 2010