

Process ~~SD#~~ 69440

Cadastral Sheet G.8.A. 63B
2/a
Ward of Naparima
County of Victoria

To be brought under the Provisions of the
Real Property Ordinance

RAMBERT VILLAGE

Vide Plan C.K.137
Bk.1218 Fol.176

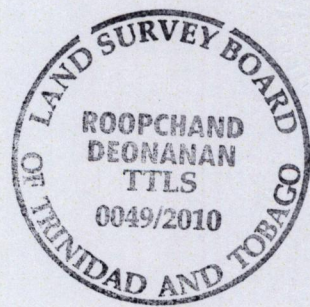
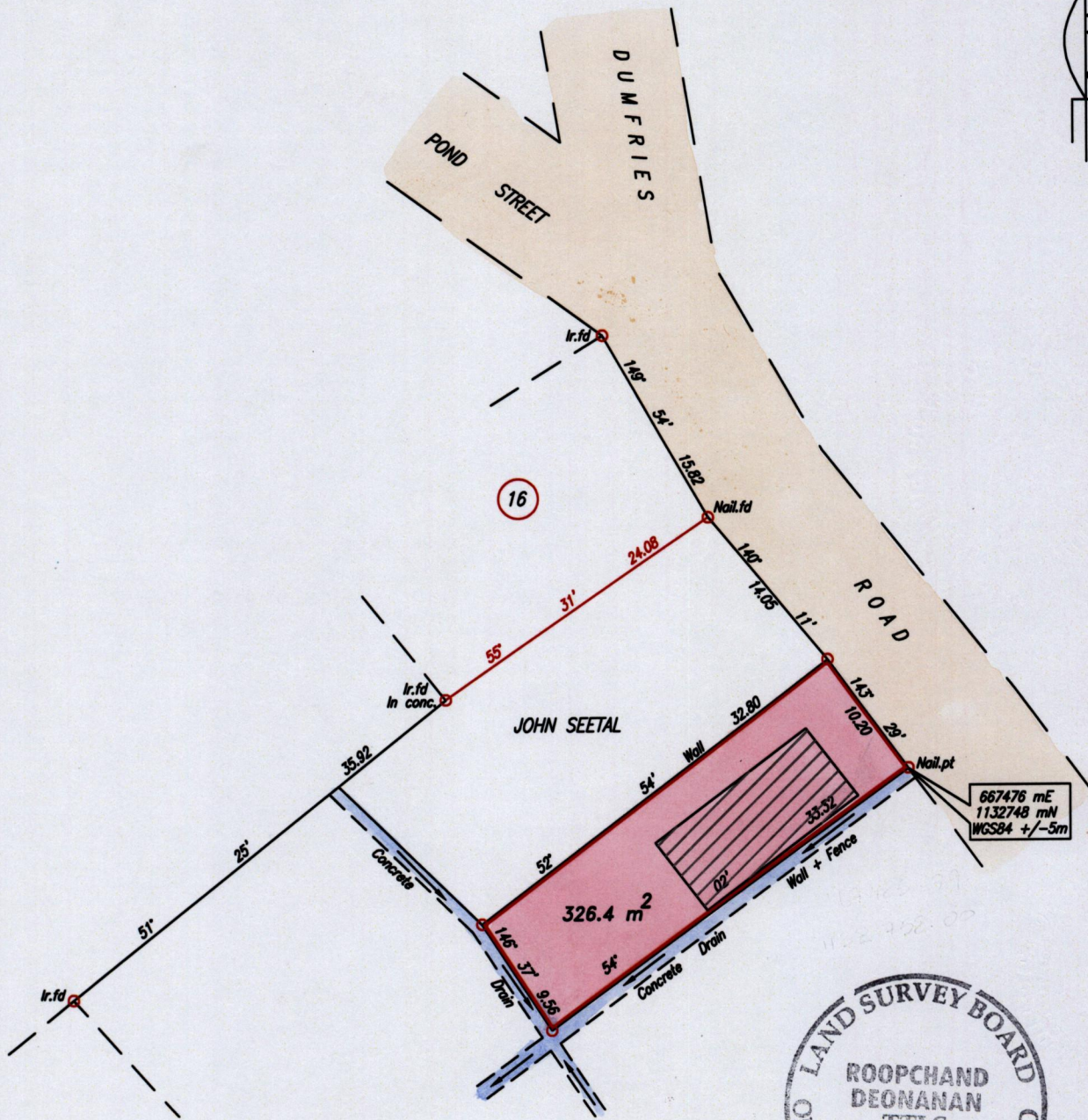
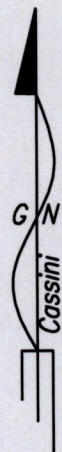

Coordinates obtained from hand held G.P.S.

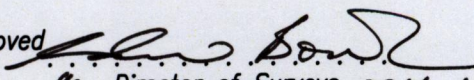
Approved 
Director of Surveys 2011.1.18

SCALE 1:500

Distances are in metres

○Denotes Iron put except where otherwise stated
Bearings are Cassini Grid based on Solar Observations
PLAN of a Parcel of land coloured pink in the Ward of Naparima
Containing three hundred and twenty six point four square metres
Surveyed by me, with due authority, on 25th March 2010 for Daphne Reyes & Stanley Reyes
In accordance with Regulation 25 (1) of the Land Surveyors' Regulations 1998,
I certify that this plan is correct.

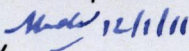
Checked by  12/1/11

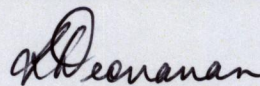

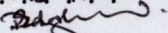
Entered on CHS 7.8.2013

Trinidad & Tobago Land Surveyor.13th May 2010.
PATH = ADM004 E/DEO/REYES DWG