

Process ~~69431~~ 69431

1369

41

To be brought under the provisions
of The Real Property Ordinance

13E
Cadastral Sheet 3/a (A.20.C.)
Ward of St. Anns
County of St. George

Reg. Deed DE200400446101
Reg. Deed DE200400446080

Station	Bearing	Distance	Station
T	262° 59'	11.70	T1
T1	262° 59'	1.98	T2

G N
U.T.M.

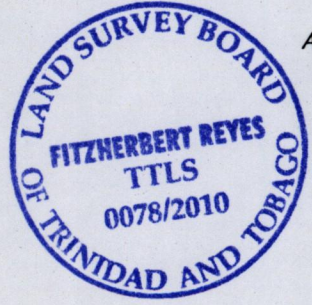
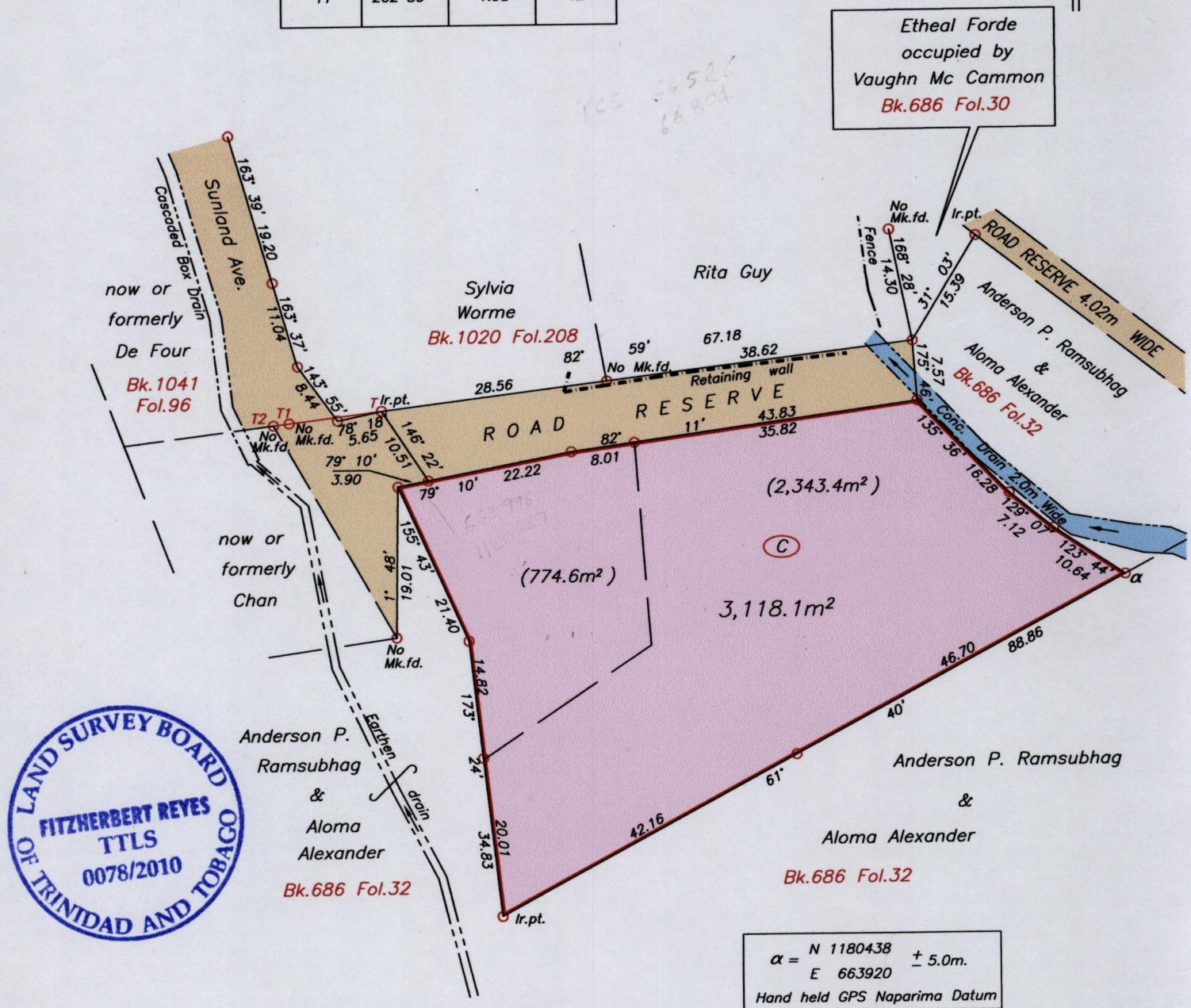

$\alpha = \begin{matrix} N 1180438 \\ E 663920 \end{matrix} \pm 5.0m.$
Hand held GPS Naparima Datum

Approved *[Signature]*
& Director of Surveys 2011.1.18

SCALE 1:750
Distances are in METRES

○ Denotes Iron found unless otherwise stated
Bearings are based on Solar observations

PLAN of a Parcel of land coloured pink in the Ward of St. Anns
Containing three thousand one hundred and eighteen point one square metres
Surveyed by me, with due authority, on 06 & 13 May & 10 June 2006 for P.E.R. Limited
In accordance with Regulation 25 (1) of the Land Surveyors' Regulations 1998,
I certify that this Plan is correct.

Checked by *[Signature]* 12/1/11 T.T.L.S.
Entered on *[Signature]*
Trinidad & Tobago Land Surveyor *[Signature]* 19 May 2010

JF153 JF152