

1369

39

To be brought under the provisions of the Real Property Ordinance

Ward of Pointe a Pierre

County of Victoria

Cadastral Sheet D.22.L., 53C 4/a

Process ~~LDH~~ 69392

VIDE Bk.1304 fol.2

R.D.#692/1945

R.D.#18083/1964

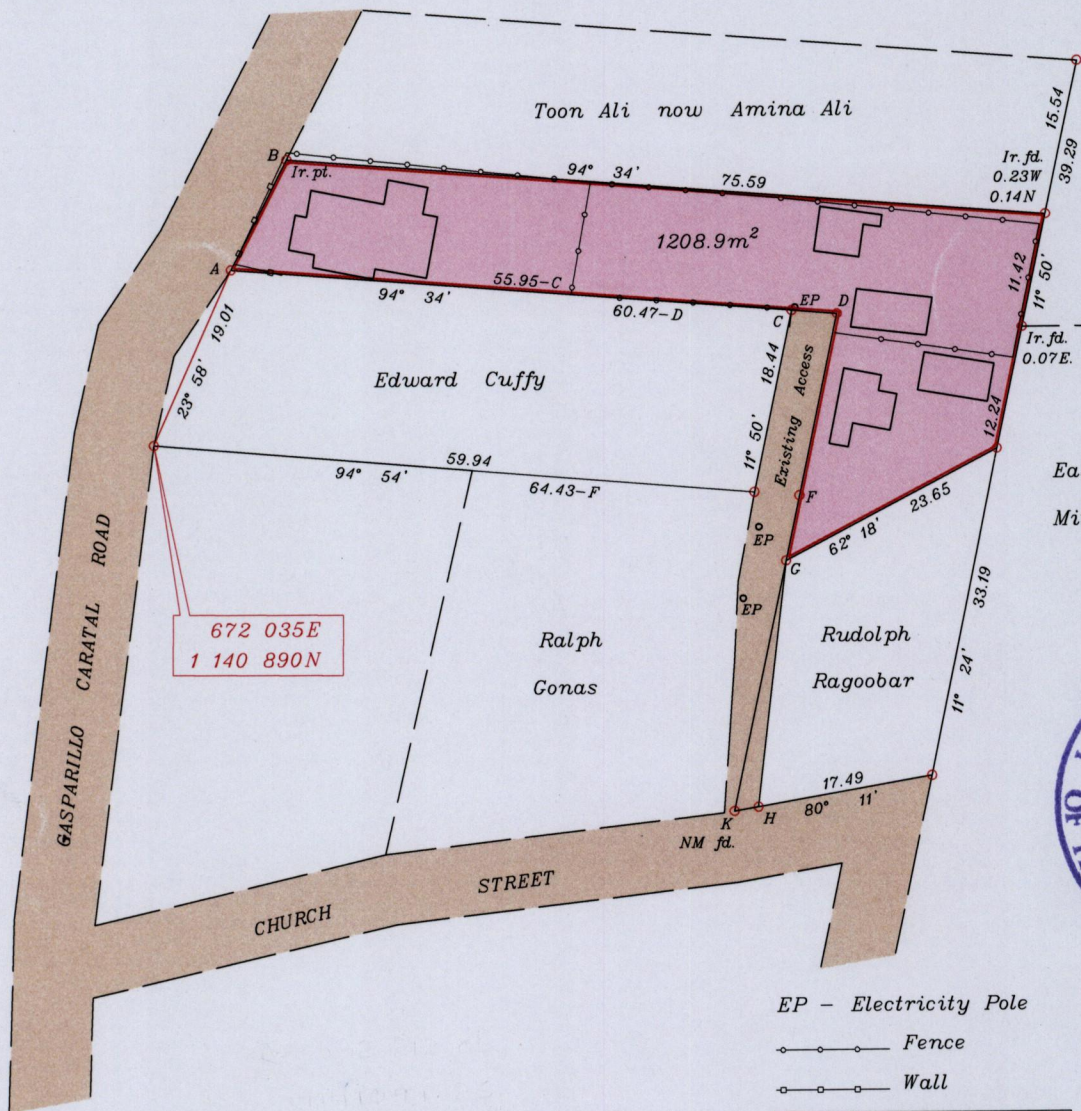

Curtis King

Cassini G N

Eastlyn Mitchell



EP - Electricity Pole
 --- Fence
 --- Wall

Line	Bearing	Distance
AB	27° 00'	12.26
FD	11° 54'	18.45
CF	11° 53'	6.60
HC	06° 38'	24.69
KH	80° 11'	2.43
KC	11° 53'	25.47

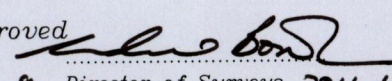
Approved 
 Director of Surveys 2011.1.13

Co-ordinates are U.T.M. Zone 20 Naparima Datum +/-5m obtained from handheld G.P.S.

SCALE 1:750

o denotes Ir.f.d. unless otherwise stated

Bearings are Cassini Grid based on Solar Observations Distances are in metres

PLAN of a Parcel of land coloured pink in the Ward of Pointe a Pierre
 Containing one thousand two hundred and eight point nine square metres
 Surveyed by me, with due authority, on September 03, 2010 for Pearl Belgrove Guevara
 In accordance with Regulation 25(1) of the Land Surveyors' Regulations 1998,
 I certify that this plan is correct.

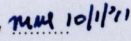
Checked by  10/11/11

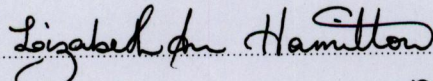
 Trinidad & Tobago Land Surveyor October 26 2010

Entered CMS 19.07.2013 