

Not finding 369/37

1369

37

Process ID# 69395

13F

To be brought under the provisions of The Real Property Ordinance

Cadastral Sheet 3/c/3 (B.17J.)  
Ward of St. Anns  
County of St. George  
NEWALLO VILLE, SAN JUAN

See Bk.1173 Fol.64

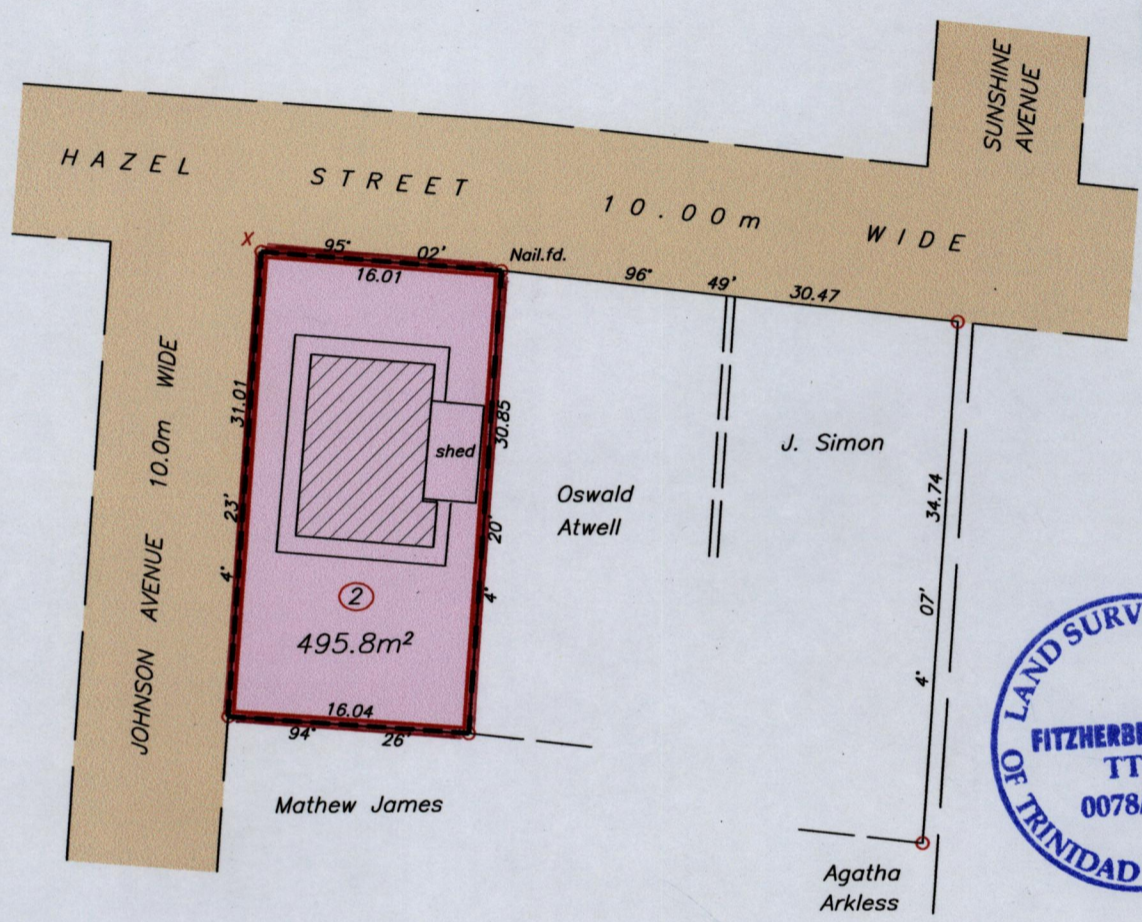
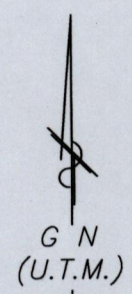

SEE 1502:192

--- wall  
--- chain link fence

N 1178206  
X = E 668892 +/- 5.0m  
UTM 20 Naparima Datum  
Hand Held GPS

Approved Director of Surveys 2011.1.12

SCALE 1:500  
Distances are in METRES

o Denotes Irons found unless otherwise stated  
Bearings are based on Solar observations

PLAN of a Parcel of land coloured pink in the Ward of St. Anns  
Containing four hundred and ninety five point eight square metres  
Surveyed by me, with due authority, on September 11th 2010 for  
Peter and Alicia Bartholomew

In accordance with Regulation 25 (1) of the Land Surveyors' Regulations 1998,  
I certify that this Plan is correct.

Checked by T.T.L.S.  
Entered on GIS 29.07.2013 Trinidad & Tobago Land Surveyor 21 Sept 2010