

To be brought under the provisions of The Real Property Ordinance

Ward of Blanchisseuse County of St. George

Reference Bk.1119 Fol.134

PROCESS ID # 44834

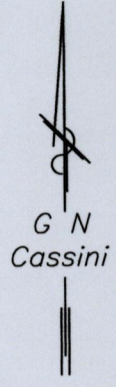

THE SEA

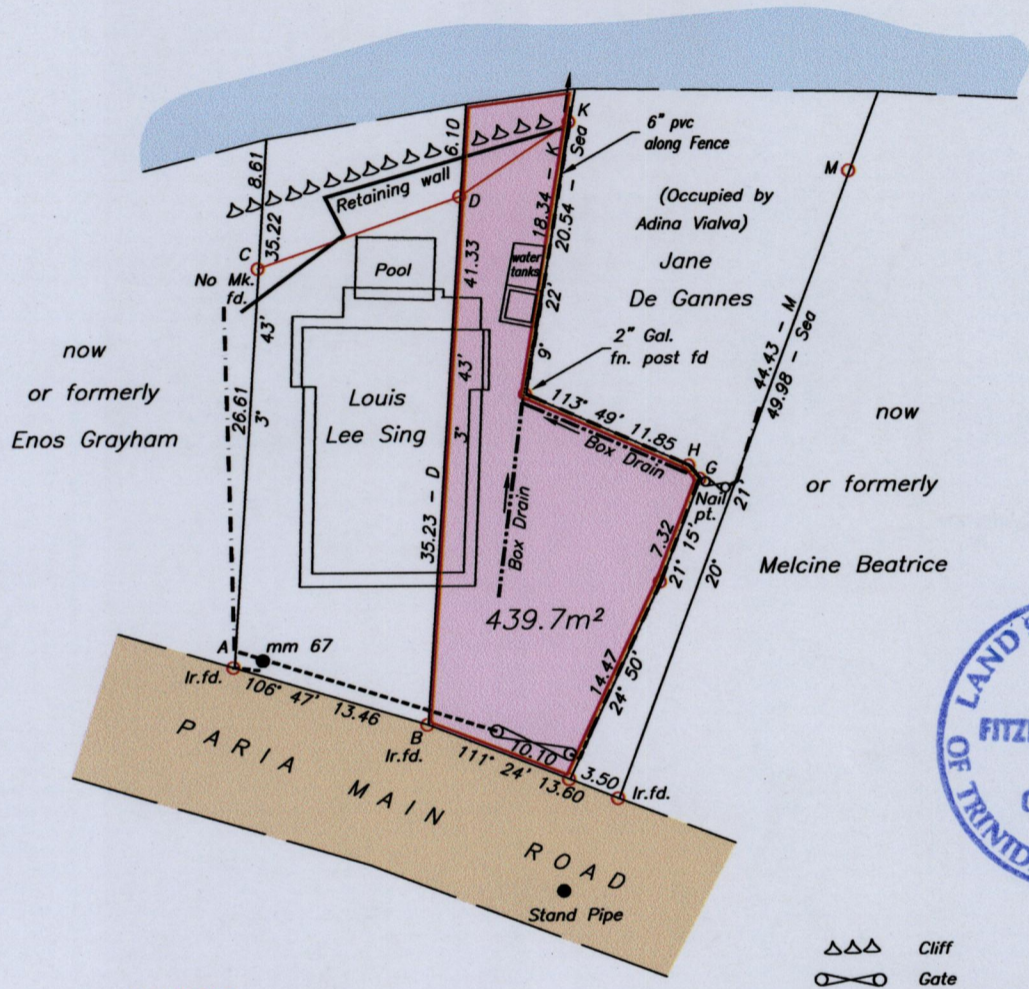

B = N 1194087 +/- 5m  
E 683786

UTM 20 Naparima 1955 Datum  
Hand Held GPS

- △△△ Cliff
- ⊗ Gate
- - - Chain Link Fence
- Conc. Wall

|                |          |       |
|----------------|----------|-------|
| Stand pipe - B | 321° 03' | 14.25 |
| A - mm         | 140° 53' | 1.13  |
| H - G          | 140° 53' | 1.13  |
| C - D          | 70° 40'  | 14.25 |
| D - K          | 56° 10'  | 8.77  |

Approved *[Signature]*  
Director of Surveys 2012.3.26

○ Denotes Iron put unless otherwise stated  
Bearings are based on Solar observations

SCALE 1:500  
Distances are in METRES

PLAN of a Parcel of land coloured pink in the Ward of Blanchisseuse Containing four hundred and thirty nine point seven square metres Surveyed by me, with due authority, on 9th April, 2011 for Jane De Gannes In accordance with Regulation 25 (1) of the Land Surveyors' Regulations 1998, I certify that this Plan is correct.

Checked by *[Signature]* 21/3/12 ..... *[Signature]* T.T.L.S.  
Entered on *[Signature]* 22-04-2012 Trinidad & Tobago Land Surveyor *[Signature]* 15 April 2011