

To be brought under the Provisions of the  
Real Property Ordinance.

1369

Ward of Naparima  
County of Victoria

2000

Cadastral Sheet (G.8.B.) 63.B.  
2/d

Process 20# 38872

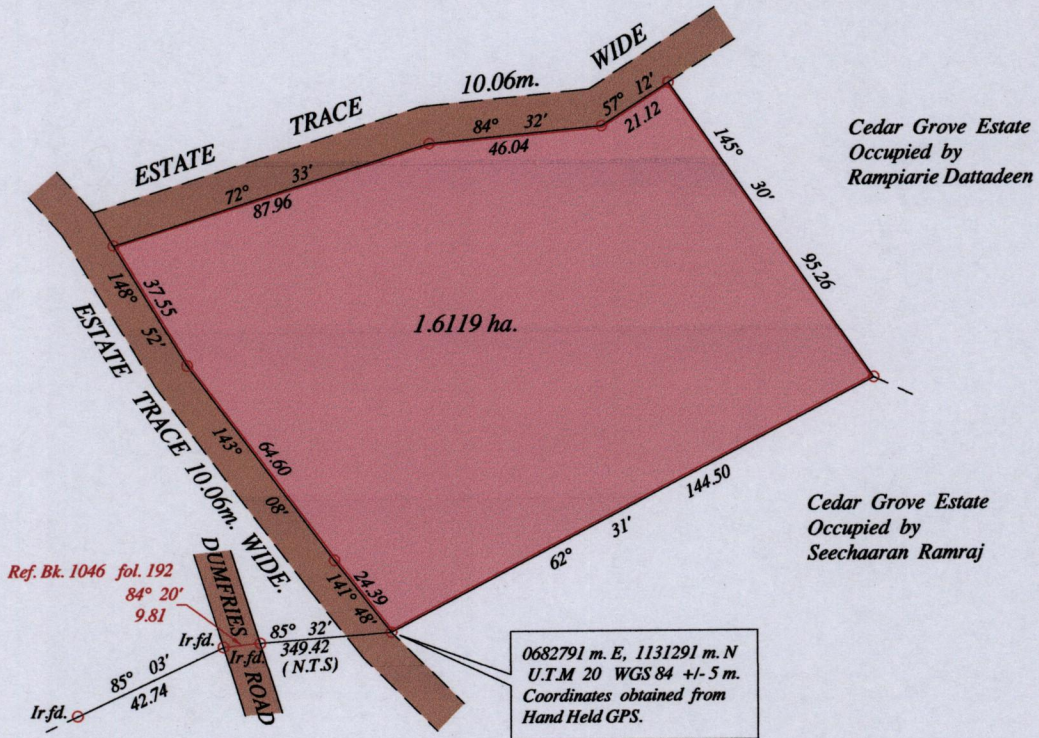

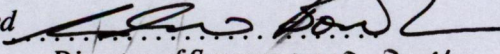
Approved   
Director of Surveys 2012.2.14

SCALE : 1:2000

o Denotes Iron Put Except Stated Otherwise

Distances are in metres

Note: Bearings are Cassini Grid based on Solar Observations.

PLAN of a Parcel of land coloured pink in the Ward of Naparima

Containing one point six one one nine hectares

Surveyed by me, with due authority, on 15th. May 2006 for Mohammed Hosein & Nazim Abdool.

In accordance with Regulation 25 (1) of the Land Surveyors' Regulations 1998,

I certify that this plan is correct.

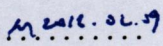
Checked by  2011.02.09

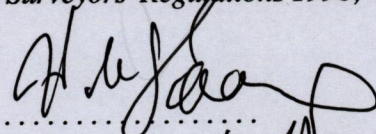

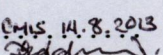
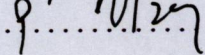
Entered on  14.8.2013 Trinidad & Tobago Land Surveyor  2011

