

To be brought under the provisions of the Real Property Ordinance

Process ID # 45177

Ward of Naparima
County of Victoria

Cadastral Sheet G.7.D., $\frac{53E}{4/c/3}$

VIDE Bk.1180 fol.199

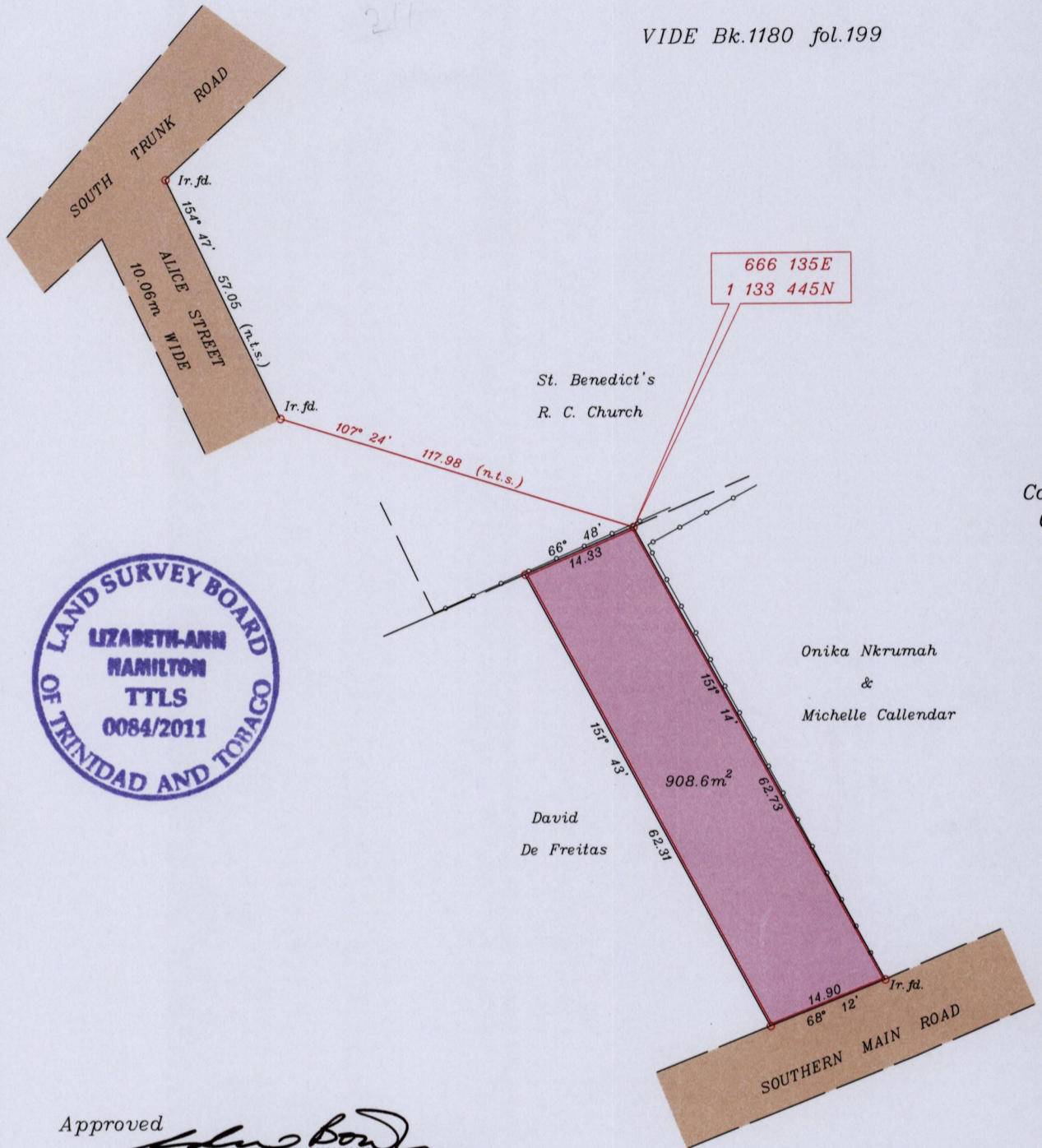

Approved *[Signature]*
 Director of Surveys 2012.1.31

Co-ordinates are U.T.M. Zone 20 Naparima Datum +/-5m
 obtained from handheld G.P.S.

—○— Chain Link Fence

SCALE 1:750

○ denotes Ir.pt. unless otherwise stated

Bearings are Cassini Grid based on Solar Observations

Distances are in metres

PLAN of a Parcel of land coloured pink in the Ward of Ortoire

Containing nine hundred and eight point six square metres

Surveyed by me, with due authority, on July 22, 2011 for Leon Lange and Laurence Lange

In accordance with Regulation 25(1) of the Land Surveyors Regulations 1998,

I certify that this plan is correct.

Checked by *[Signature]* 19/11/2012
 Entered *[Signature]* 22-06-2012

[Signature]
 Trinidad & Tobago Land Surveyor November 02 2011