

To be brought under the Provisions of the Real Property Ordinance

Reg. Deed No. 8883 of 1950

Process SD# 69480

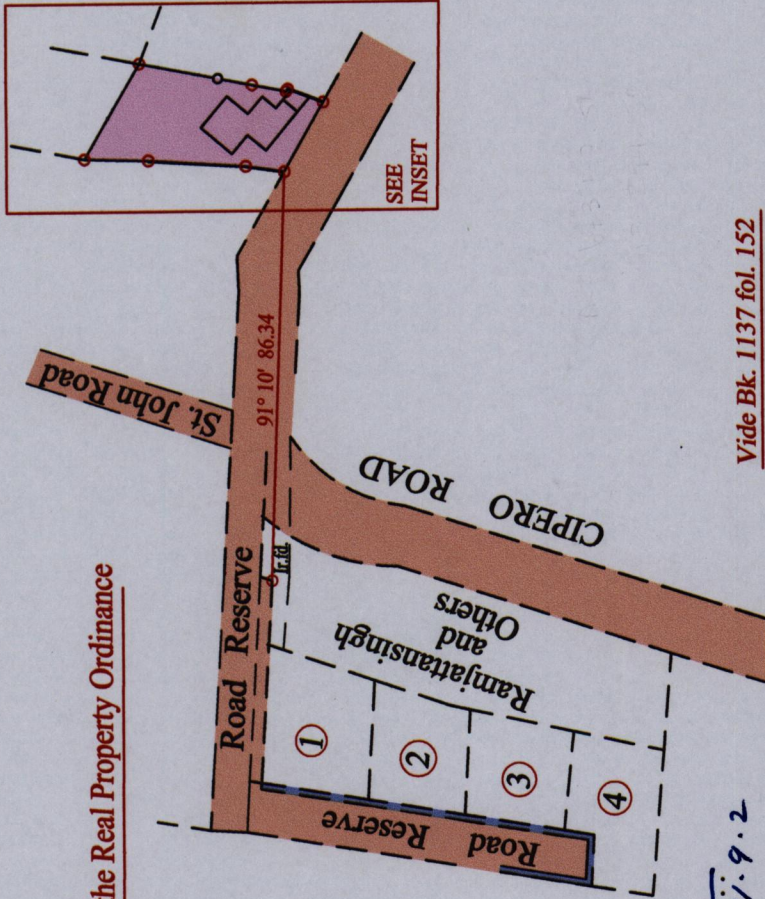

Approved *[Signature]*  
 Director of Surveys 2011.9.2

Vide Bk. 1137 fol. 152

o Denotes Iron put except stated otherwise.

Note: Bearings are cassini grid based on solar observations Distances are in metres

PLAN of a Parcel of land coloured pink in the Ward of Naparima  
 Containing four hundred and sixty two point three square metres  
 Surveyed by me, with due authority, in December 12th 2010 for Mr. Ramsingh  
 In accordance with Regulation 25 (1) of the Land Surveyors' Regulations 1998,  
 I certify that this plan is correct.

SCALE : 1:1250

Checked by *[Signature]* 26/8/2011

Entered on *[Signature]* 19.03.2011 Trinidad & Tobago Land Surveyor

Ward of Naparima  
 County of Victoria  
 Cadastral Sheet ( G.8.D ) 63.C. 2/a

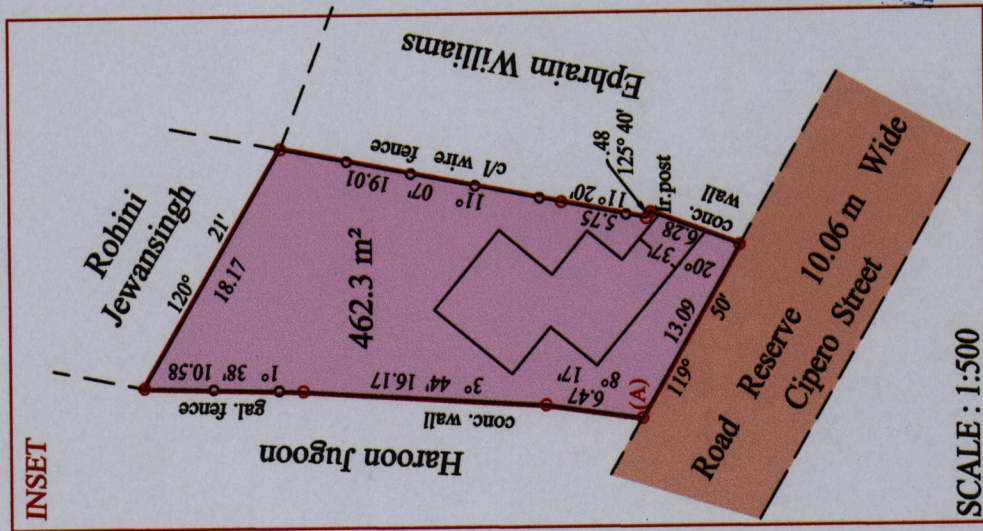

SCALE : 1:500

At Station (A)  
 E 0672992  
 N 1133214  
 Reading taken with  
 Handheld G.P.S.  
 U.T.M. Zone 20  
 Naparima  
 + 5 m.

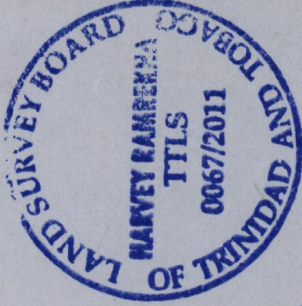

1369

6(1)