

1369

Cadastral Sheet I.21. 1E
Ward of Tobago 6/b/3
Parish of St. Patrick

Process ~~SN#~~ 69338

To be brought under the provisions of The Real Property Ordinance

BON ACCORD

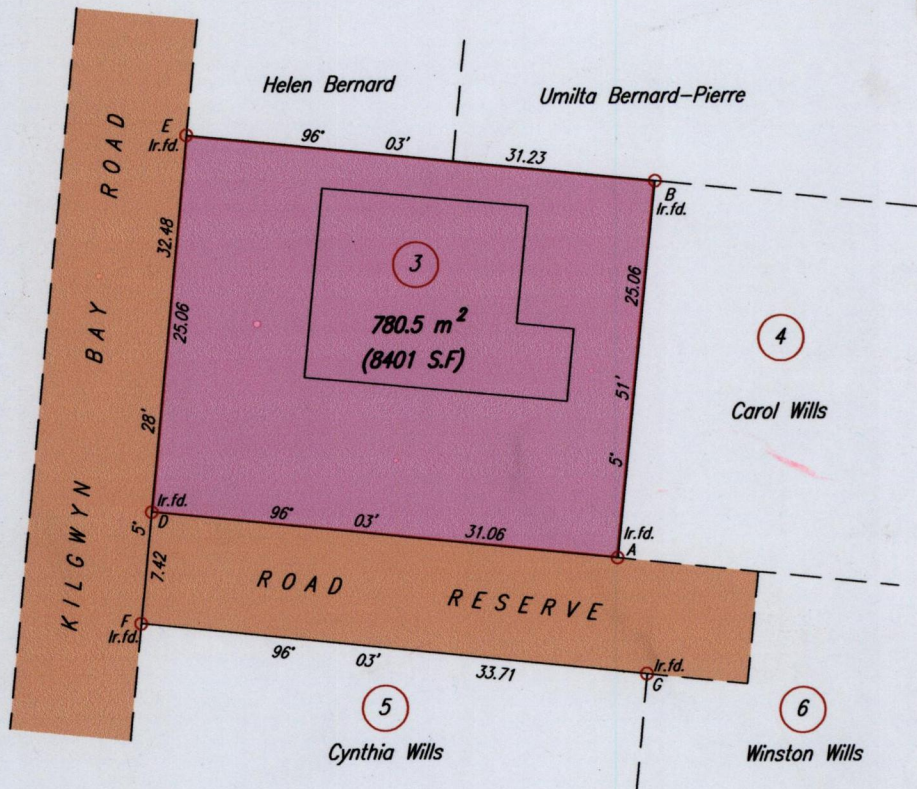

Coordinates of D (Ir.f.d.): 0738006mE, 1233930mN
U.T.M. 20 WGS 84 (+/- 7.00m)
G.P.S. Direct Observation

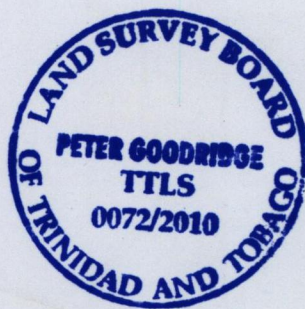

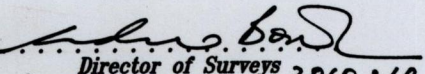
Approved 
Director of Surveys 2010.10.4

SCALE 1:500

Distances are in METRES

- Denotes Iron put except where otherwise stated
- Bearings are Cassini Grid based on Solar Observations

PLAN of a Parcel of land coloured pink in the Ward of Tobago
Containing seven hundred and eighty point five square metres
Surveyed by me, with due authority, on the 11th January 2010 for Barbara Patricia Wills

In accordance with Regulation 25 (1) of The Land Surveyors Regulations 1998,

I certify that this plan is correct.

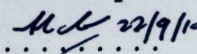
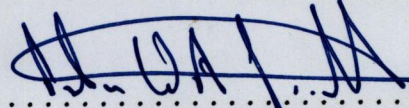
Checked by  22/9/10  TTLS

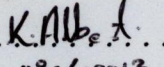
Entered  23-6-2013
Trinidad & Tobago Land Surveyor
C:\LESS 2010\TOBAGO\WILLS, BARBARA\dwg. 19 June 2010
FILE NO: TWO80