

1358/8

3

R.P.O. Vol. 5
C.T. Vol. 1251

Fol. 149
Fol. 61

Ward of Ortoire
County of Victoria
Cadastral Sheet G.5.J., 54 E
4/b

Ref. Bk. 903 fol. 150

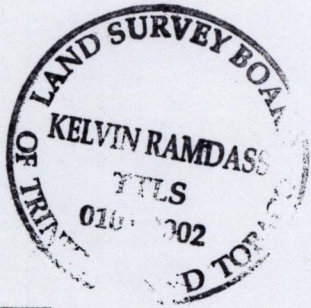
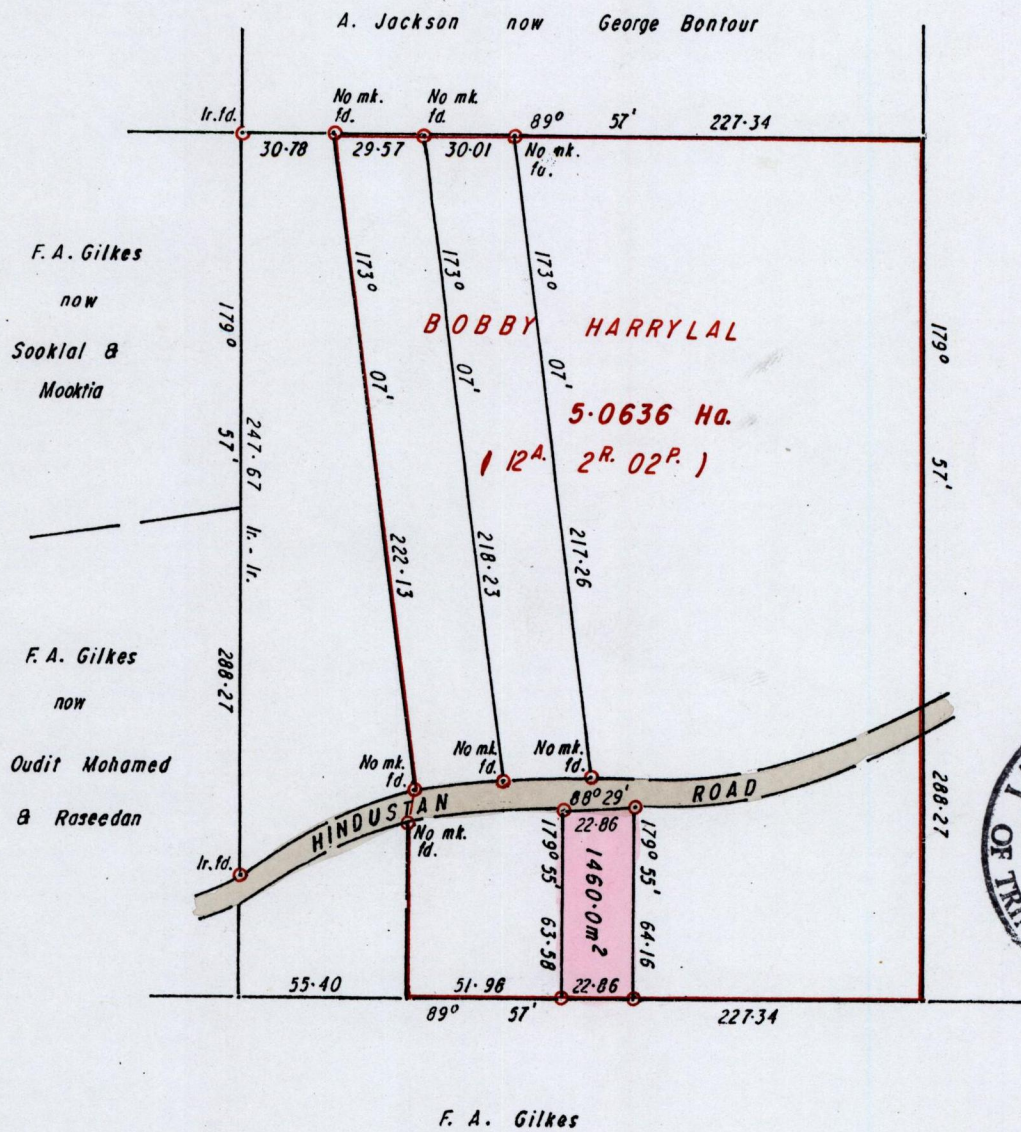

Approved

[Signature]
 Director of Surveys
 2005-8-15

○ Denotes Iron put unless otherwise stated
 Bearings are Cassini Grid based on Solar Obs.
 SCALE 1 / 2500
 Distances are in METRES

Note: To Obtain compass bearings add/subtract minutes

PLAN of a Parcel of land coloured PINK in the Ward of Ortoire
 Containing one thousand four hundred and sixty point zero square metres
 Surveyed by me, with due authority, in June 2002, ^{to be} vested in Chandai Woods
 In accordance with Regulation 25 (1) of the Land Surveyors' Regulations 1998,
 I certify that this plan is correct.

Checked by *[Signature]*

[Signature]

Entered Trinidad and Tobago Land Surveyor..... *[Signature]* 2002