

REMAINING PORTION

R.P.O. Vol. 635
C.T. Vol.

Fol. 601
Fol.

Ward of Tacarigua
County of St. George
Cadastral Sheet B.18.I

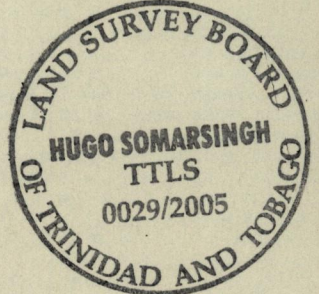
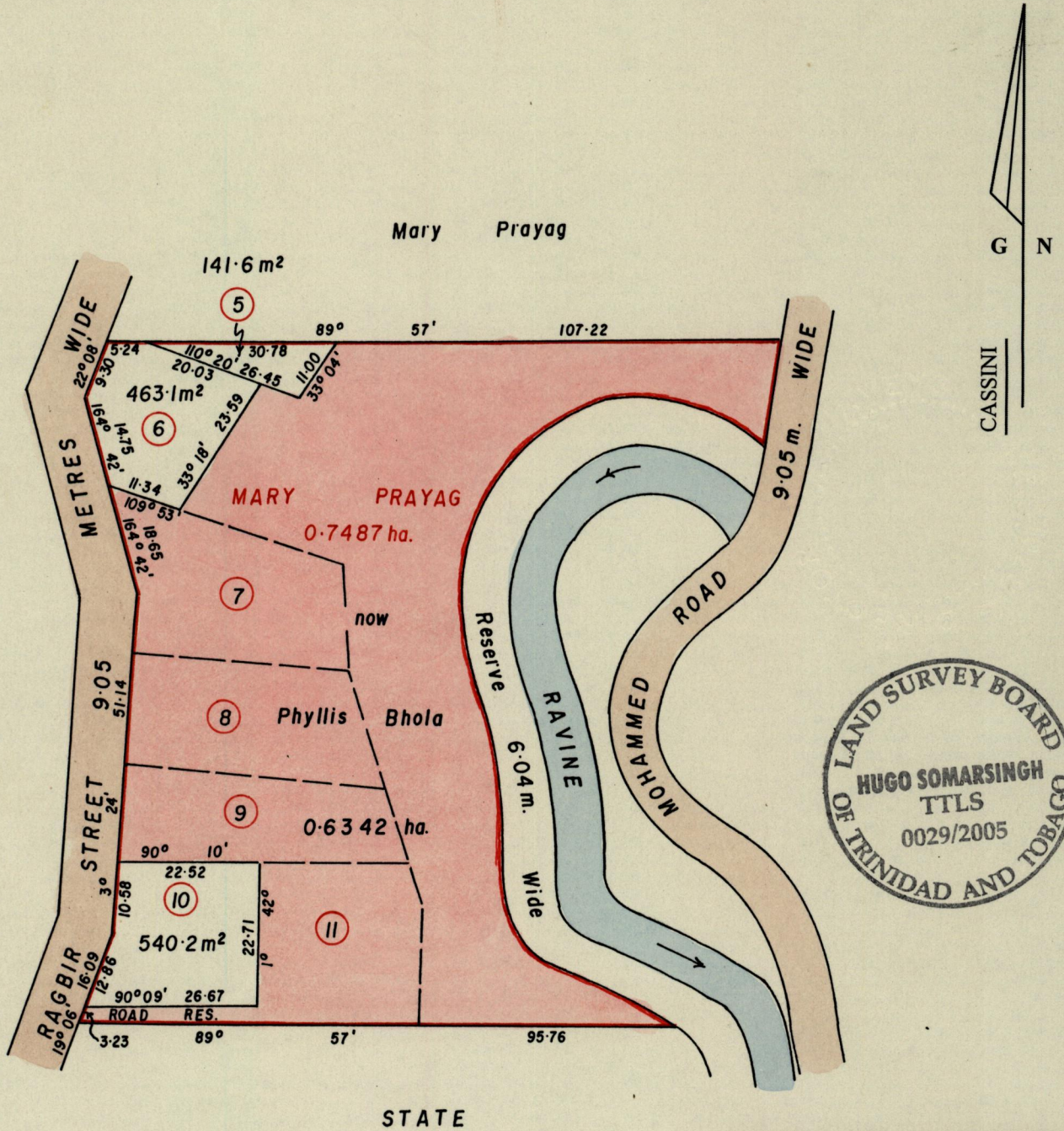

Lot 5	Angela Lubie E. Ors	C.T. Vol. 2961	fol. 165
Lot 6	Baldeo Ramlachan	C.T. Vol. 2698	fol. 343
Lot 10	Harry E. Dolly Ramai	C.T. Vol. 2864	fol. 107

Approved *[Signature]*
Director of Surveys
2005.8.24

See Bk. 606 Fol. 196

Note: To Obtain compass bearings add/subtract minutes Distances are in METRES

This is a true copy of a diagram of Point Seven Four Eight Seven Hectares originally granted to MARY PRAYAG, showing a portion coloured pink and containing Point Six Three Four Two Hectares being the remainder after three previous transfers of another portion of the land. the dividing lines having been run in accordance with Regulation 25[1] of the Land Surveyors Regulations 1998, I certify that this plan is correct.

Checked by *[Signature]* *[Signature]*
Entered Trinidad and Tobago Land Surveyor..... *[Signature]* 2005