

R.P.O. Vol. 611 Fol. 299  
C.T. Vol. 1825 Fol. 145

REMAINING PORTION

Ward of Siparia.  
County of St. Patrick.  
Cadastral Sheet G.14.M. 64D  
3/d

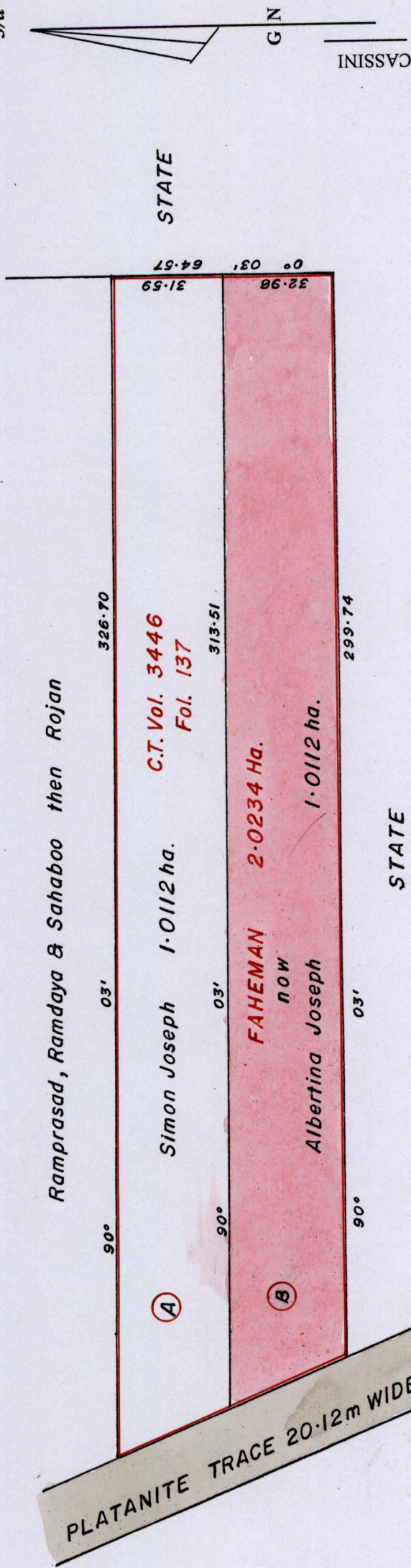

1358

176

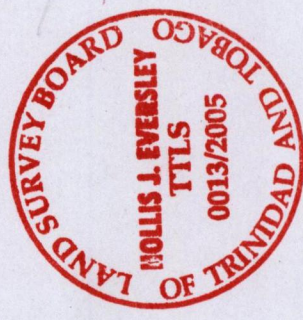

Bk. 1197:51

SCALE 1:1500.  
Distances are in METRES

Approved .....  
Director of Surveys 2006.2.7

Note: To Obtain compass bearings add/subtract minutes

This is a true copy of a diagram of two point zero two three four hectarews originally transferred to FAHEMAN, showing a portion coloured pink and containing one point zero one one two hectares, being the remainder, after one previous transfer of another portion of the land. In accordance with Regulation 25[1] of the Land Surveyors' Regulations 1998, I certify that this plan is correct.

Checked by .....  
Entered .....  
Trinidad and Tobago Land Surveyor.....2005

July 21/06