

1358 358/175 175

REMAINING PORTION

R.P.O Vol. 218 Fol. 609  
C.T. Vol. 3459 Fol. 231

Ward of Siparia.  
County of St. Patrick.  
Cadastral Sheet G.13.G. 63F  
2/c

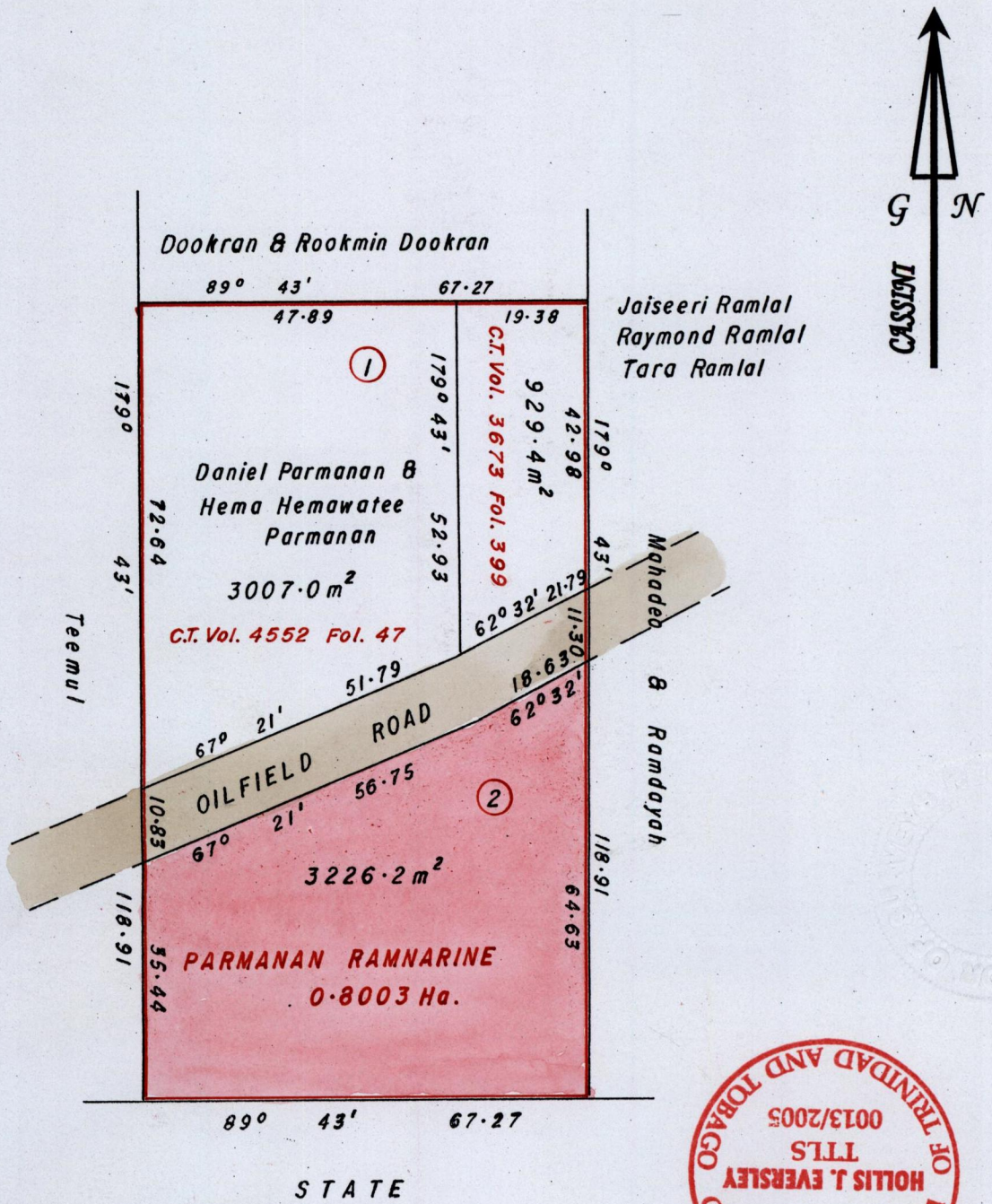

Bk. 856 : 73

SCALE 1 : 1000.  
Distances are in METRES

Approved. *[Signature]*  
Director of Surveys. 2006. 2-7

This is a true copy of a diagram of zero point eight zero zero three hectare Originally transferred to PARMANAN RAMNARINE showing a portion, Coloured pink and containing three thousand three hundred and twenty six point two square metres, being the remainder after two previous transfers of another portion of the land.

In accordance with Reg. 25(1) of the Land Surveyors' Regulations 1998, I certify that this plan is correct.

Checked by *[Signature]* 25/10

Entered .....

*[Signature]*  
Trinidad and Tobago Land Surveyor. 25<sup>th</sup> October 2005.