

R.P.O. Vol. Fol.
C.T. Vol.3024 Fol.367

Ward of Ortoire
County of Victoria
Cadastral Sheet G.5.J 54E
2/c

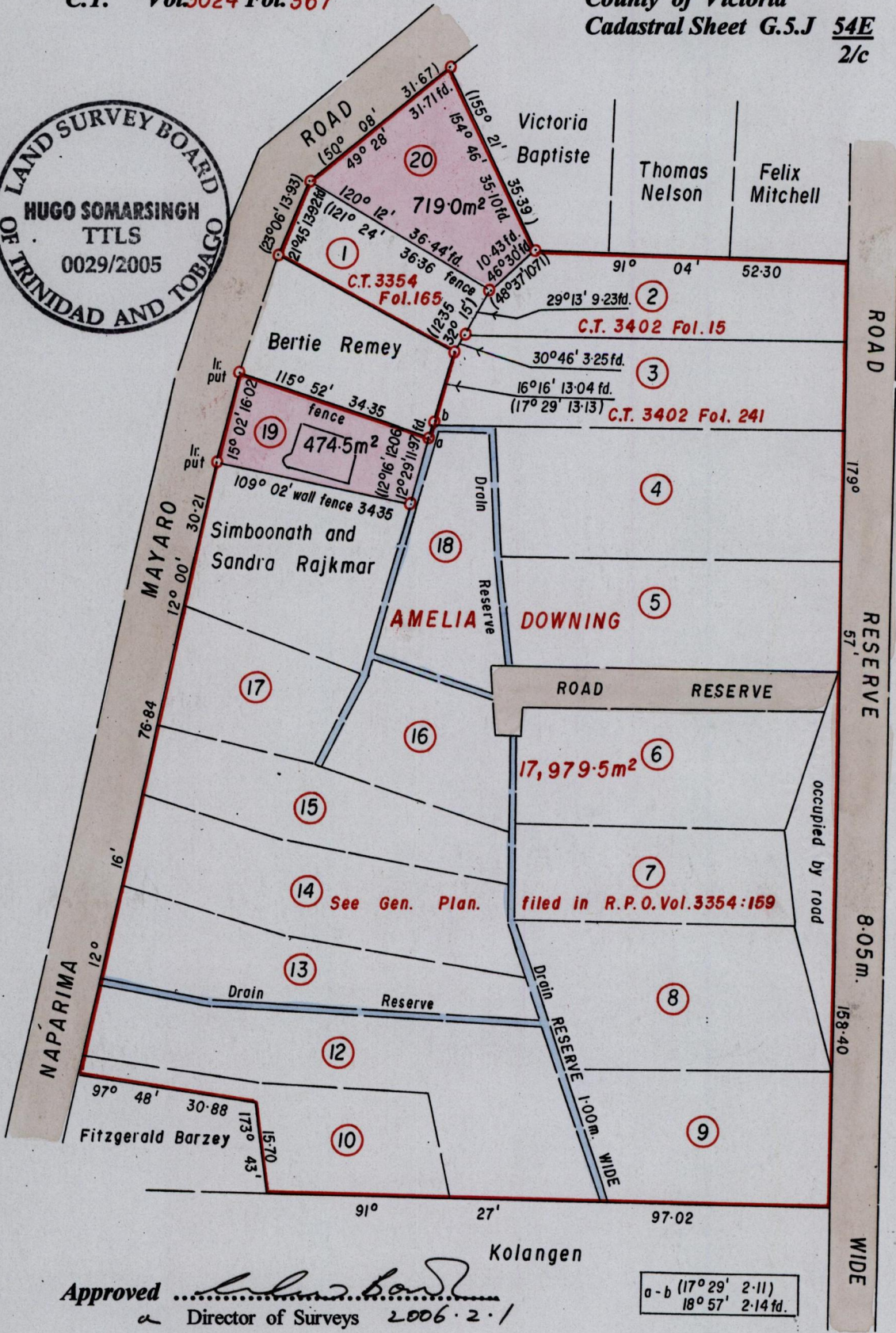
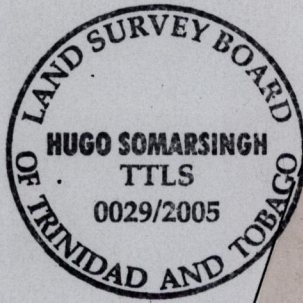

Ref.:

See Bk.1114 : 165
" " 1189 : 86
" " 1227 : 9
" " 1145 : 729

Approved
a Director of Surveys 2006.2.1

a-b (17° 29' 2.11)
18° 57' 2.14 fd.

○ Denotes Iron found unless otherwise stated
Bearings are Cassini Grid based on, Solar Observations

SCALE 1/1000
Distances are in metres

Plan of 2 parcels of land coloured pink in the Ward of Ortoire
Containing one thousand one hundred and ninety-three point five square metres
Surveyed by me, with due authority, in May 2005

In accordance with Regulation 25(1) of the Land Surveyors' Regulations 1998,
I certify that this plan is correct.

Entered on.....
Checked by..... 17/1/06
Trinidad & Tobago Land Surveyor..... 2005