

R.P.O. Vol. 56
C.T. Vol. 4591

Fol. 333
Fol. 43

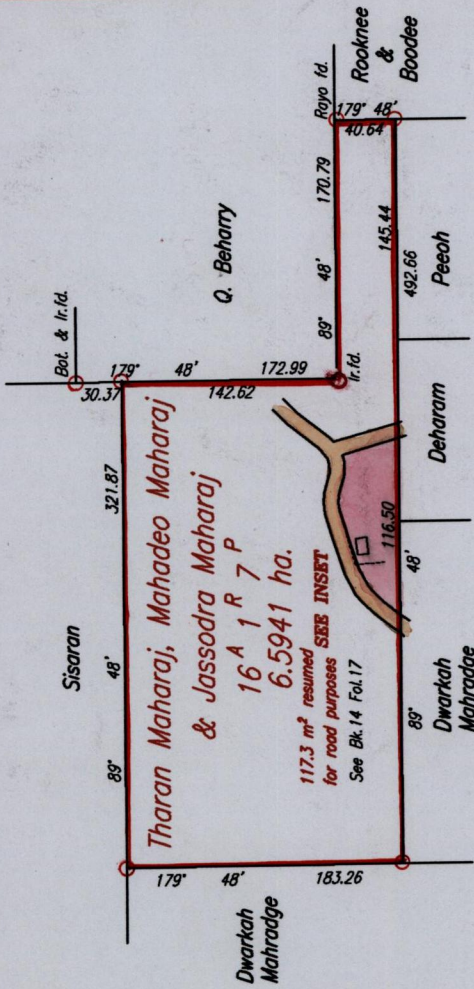

SCALE 1:5000

Distances are in METRES

Approved *[Signature]*
Director of Surveys 2006.1.25

○ Denotes Iron put except where otherwise stated

Bearings are Cassini Grid based on Solar Observations

PLAN of a Parcel of land coloured pink in the Ward of Tamana

Containing three thousand three hundred and ninety four point five square metres

Surveyed by me, with due authority, in March 2005

In accordance with Regulation 25 (1) of The Land Surveyors' Regulations 1998,

I certify that this plan is correct.

Checked by *[Signature]*

Entered on

Trinidad & Tobago Land Surveyor
C:\LESS 2005\MAHARAJ,MAHADEO\015.dwg
FILE NO: M051
2006

Cadastral Sheet D.5.P. 35A
2/c
Ward of Tamana
County of St. Andrew

INSET

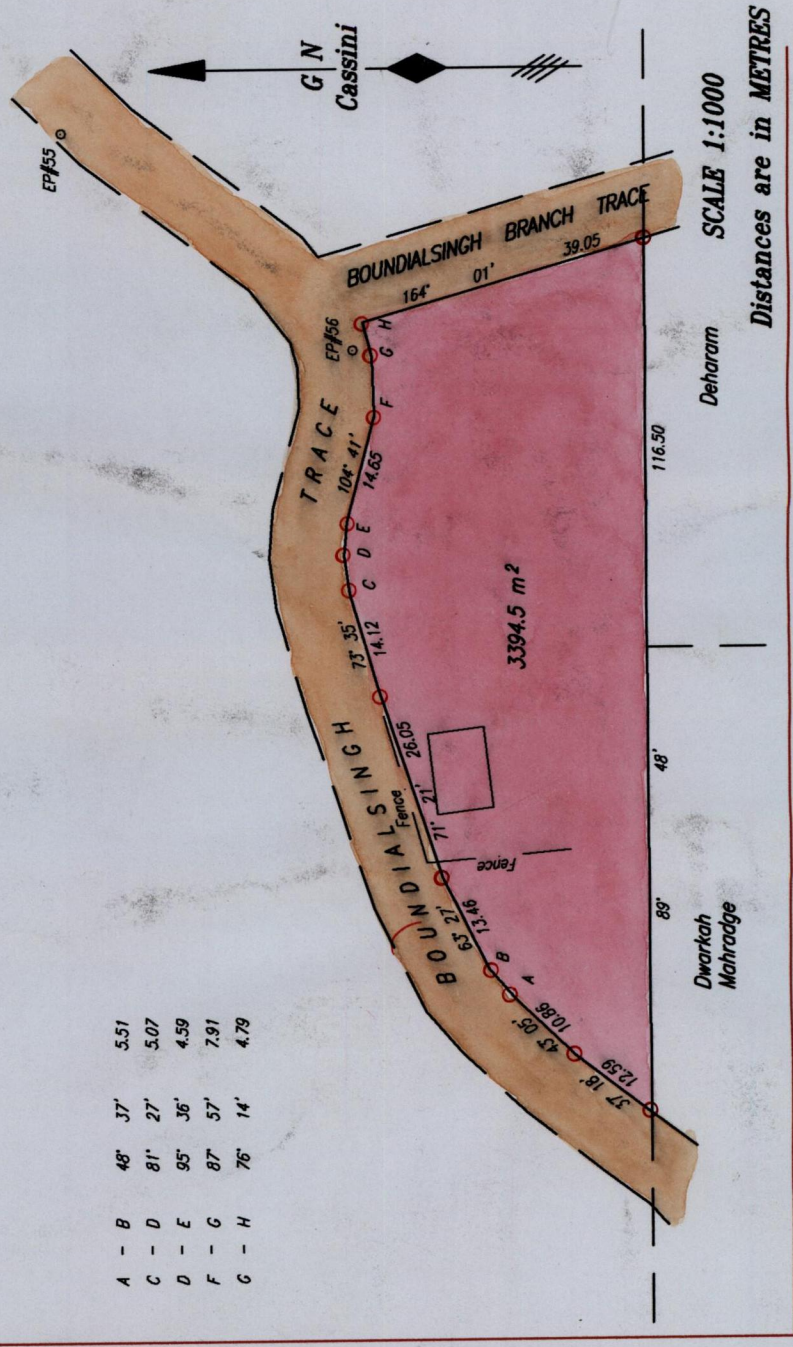

SCALE 1:1000

Distances are in METRES

References:
Bk. 7 Fol. 165
Plan E.B. 19
PK. 71



1358

148