

R.P.O. Vol. 131

Fol. 141

Cadastral Sheet H.15.M. 66E
4/d

C.T. Vol. 3711

Fol. 181

Ward of Guayaguayare

Plots B1,C1,D1 & E1 to be Amalgamated

County of Mayaro

See Bk.780 Fol.98
Bk.957 Fol.290
Bk.1101 Fol.183
Bk.1119 Fol.66
Plan F.A.113 (S.O.19/74)

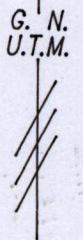
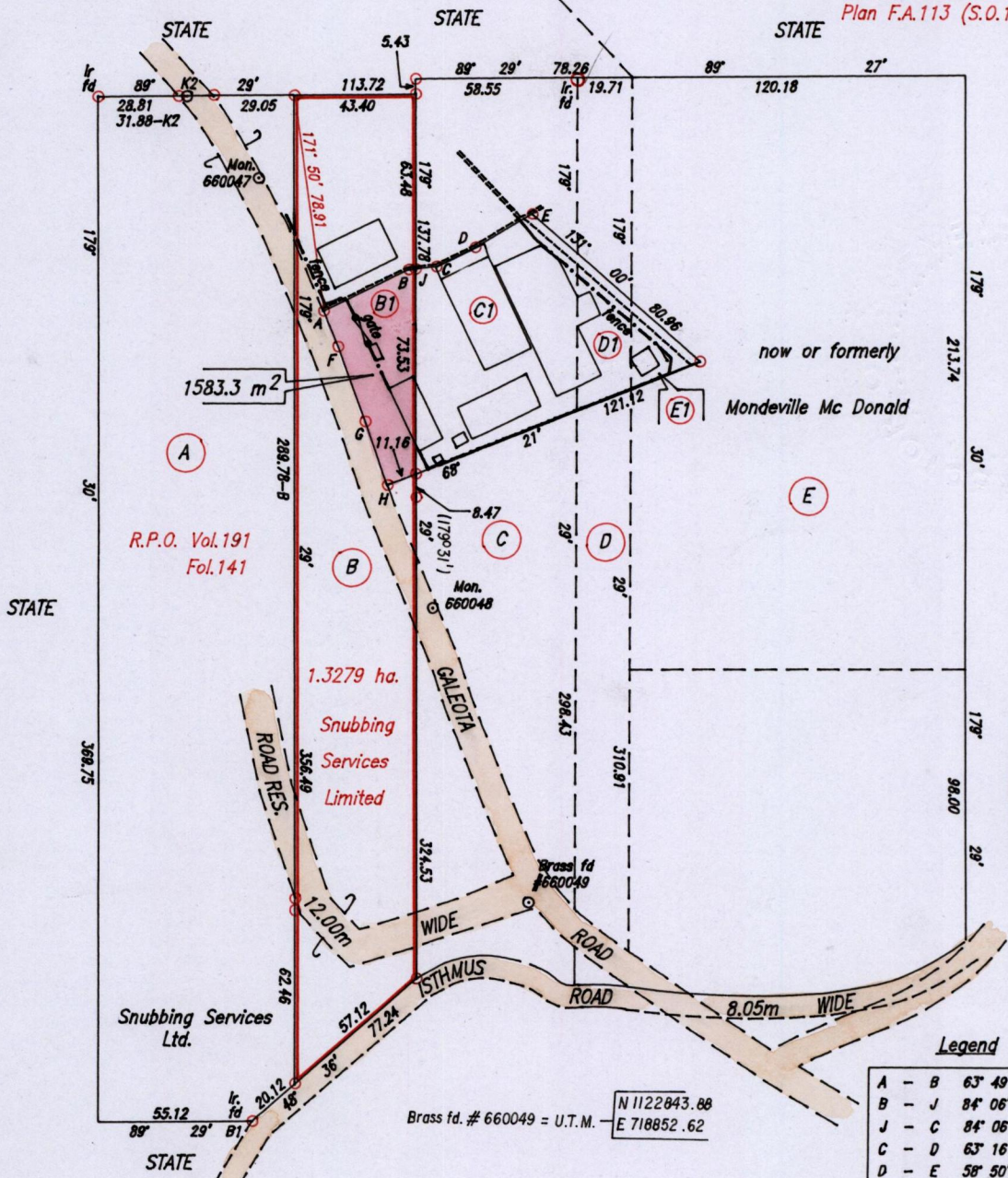

R.P.O. Vol.191
Fol.141

1.3279 ha.
Snubbing
Services
Limited

Legend

A - B	63° 49'	34.08
B - J	84° 06'	2.57
J - C	84° 06'	7.41
C - D	63° 16'	15.69
D - E	58° 50'	23.83
A - F	157° 08'	13.98
F - G	159° 22'	28.59
G - H	160° 46'	24.04

660049 - 660048	341° 27'	111.89
660048 - 660047	337° 35'	167.61
660047 - K2	318° 57'	39.26
B1 - Brass	51° 24'	126.20

Approved

[Signature]
Director of Surveys
2005.12.19

○ Denotes Iron put except where otherwise stated
Bearings are based on Solar Observations
PLAN of a Parcel of land coloured pink in the Ward of Guayaguayare
Containing one thousand five hundred and eighty three point three square metres
Surveyed by me, with due authority, in August 2003 for Snubbing Services Limited
In accordance with Regulation 25 (1) of the Land Surveyors' Regulations 1998,
I certify that this plan is correct.

SCALE 1:2500

Distances are in metres

Checked by *[Signature]* 2005.12.8

Entered on Trinidad & Tobago Land Surveyor. 6th May 2005.