

1336

1336/60

60

Cadastral Sheet B.24.B 24B
4/a

Ward of Arima

County of St. George

Bk. 1247 fol. 202, Bk. 1145 fol. 667, 667

CONSOLIDATED PLAN

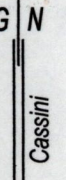
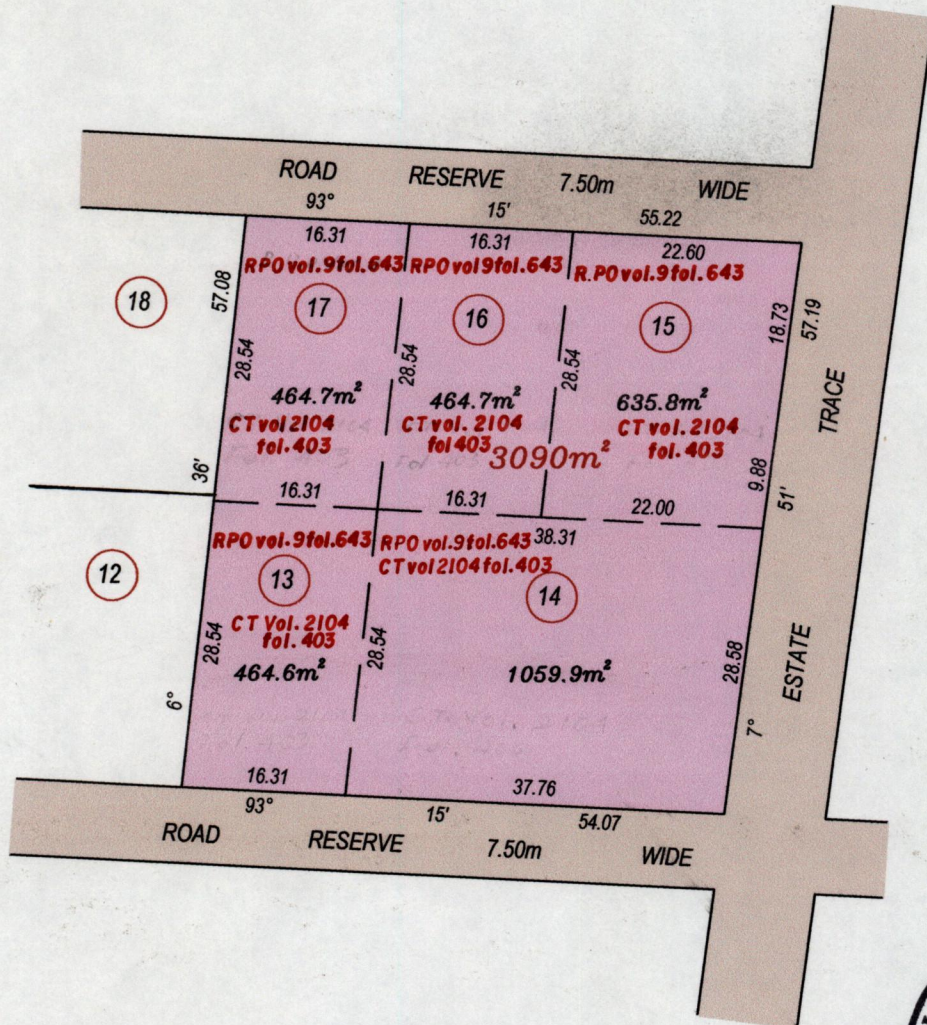

Approved

[Signature]
 Director of Surveys 2010.7.5



Bearings are based on Solar Observations
 Note: To obtain compass add/subtract 7 minutes.

SCALE 1/750

Distances are in metres

PLAN of a Parcel of land coloured pink in the Ward of Arima
 Containing together three thousand and ninety square metres
 Prepared by me, with due authority, on January 24th 1995
 In accordance with Regulation 25 (1) of the Land Surveyors' Regulations 1998,
 I certify that this plan is correct.

Checked by *[Signature]* *[Signature]*

Entered..... Trinidad & Tobago Land Surveyor 12th June 2010.....