

1336

1336/41

41

R.P.O. Vol. 27 Fol. 307
C.T. Vol. 4854 Fol. 321

Ward of Siparia
County of St. Patrick
Cadastral Sheet (G 7 N & G 12 B) $\frac{63 D}{2/a\&b}$ & $\frac{63 A}{4/a\&c}$

G N

CASSINI

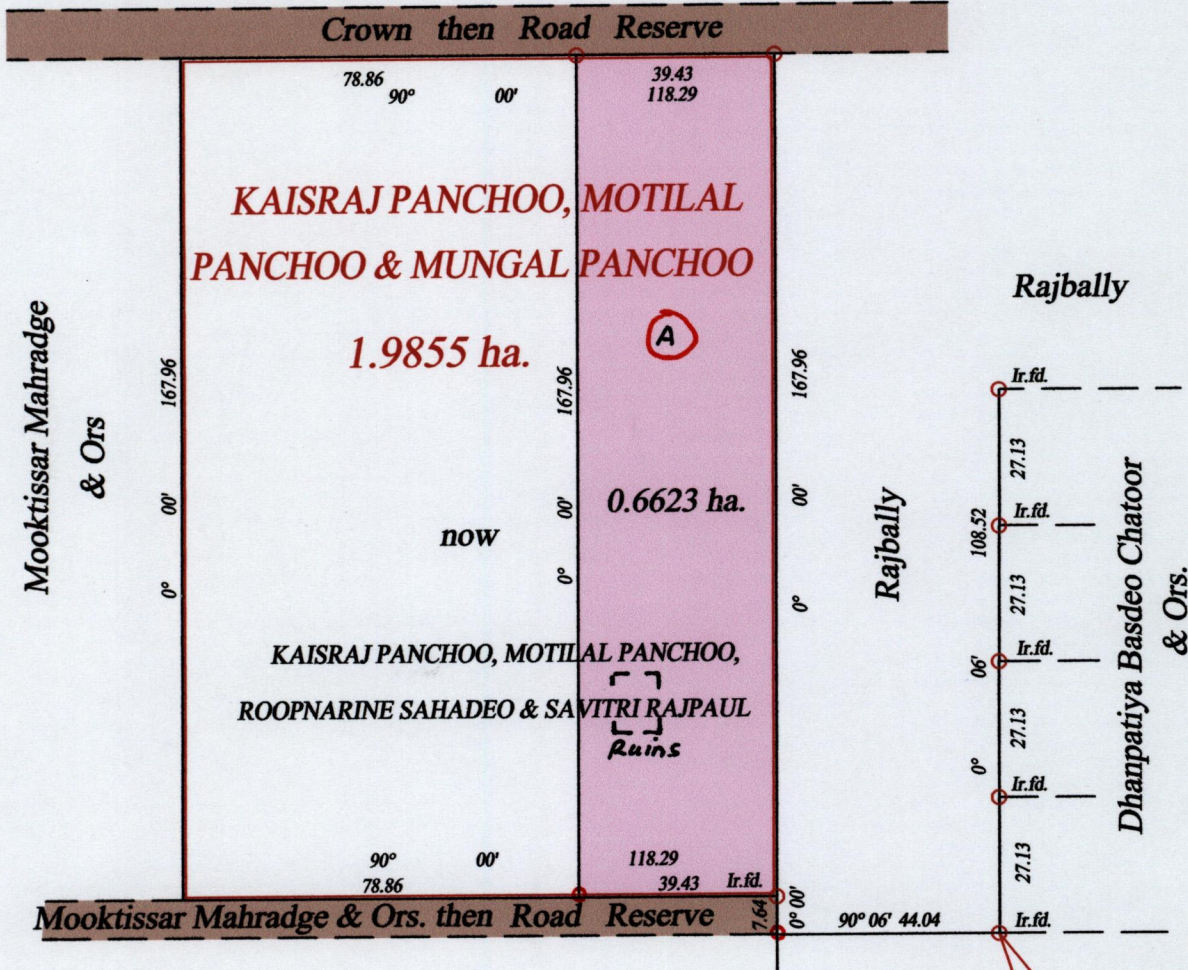

E 661982
N 1127651
Reading taken with
Handheld G.P.S.
Garmin 76S
U.T.M. 20 Naparima

Vide Bk. 710 fol. 213
Vide Bk. 1117 fol. 112

Approved *[Signature]*
9 Director of Surveys 2010.6.21

○ Denotes Iron put except stated otherwise.

SCALE : 1:1500

Note: Bearings are cassini grid based on solar observations Distances are in metres

PLAN of a Parcel of land coloured pink in the Ward of Siparia

Containing zero point six six two three hectares

Surveyed by me, with due authority, in May 2008

In accordance with Regulation 25 (1) of the Land Surveyors' Regulations 1998,

I certify that this plan is correct.

Checked by *[Signature]* 16/6/10 *[Signature]*

Entered on Trinidad & Tobago Land Surveyor *27th* May 2008

