

REMAINING PORTION

R.P.O Vol. 119 Fol. 597
C.T. Vol. 1260 Fol. 381

Ward of Siparia.
County of St. Patrick.
Cadastral Sheet G.18.F&G; 73C
1/d

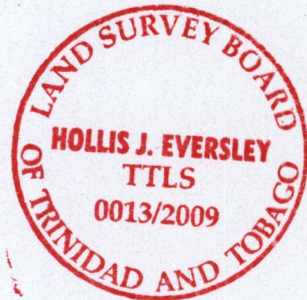
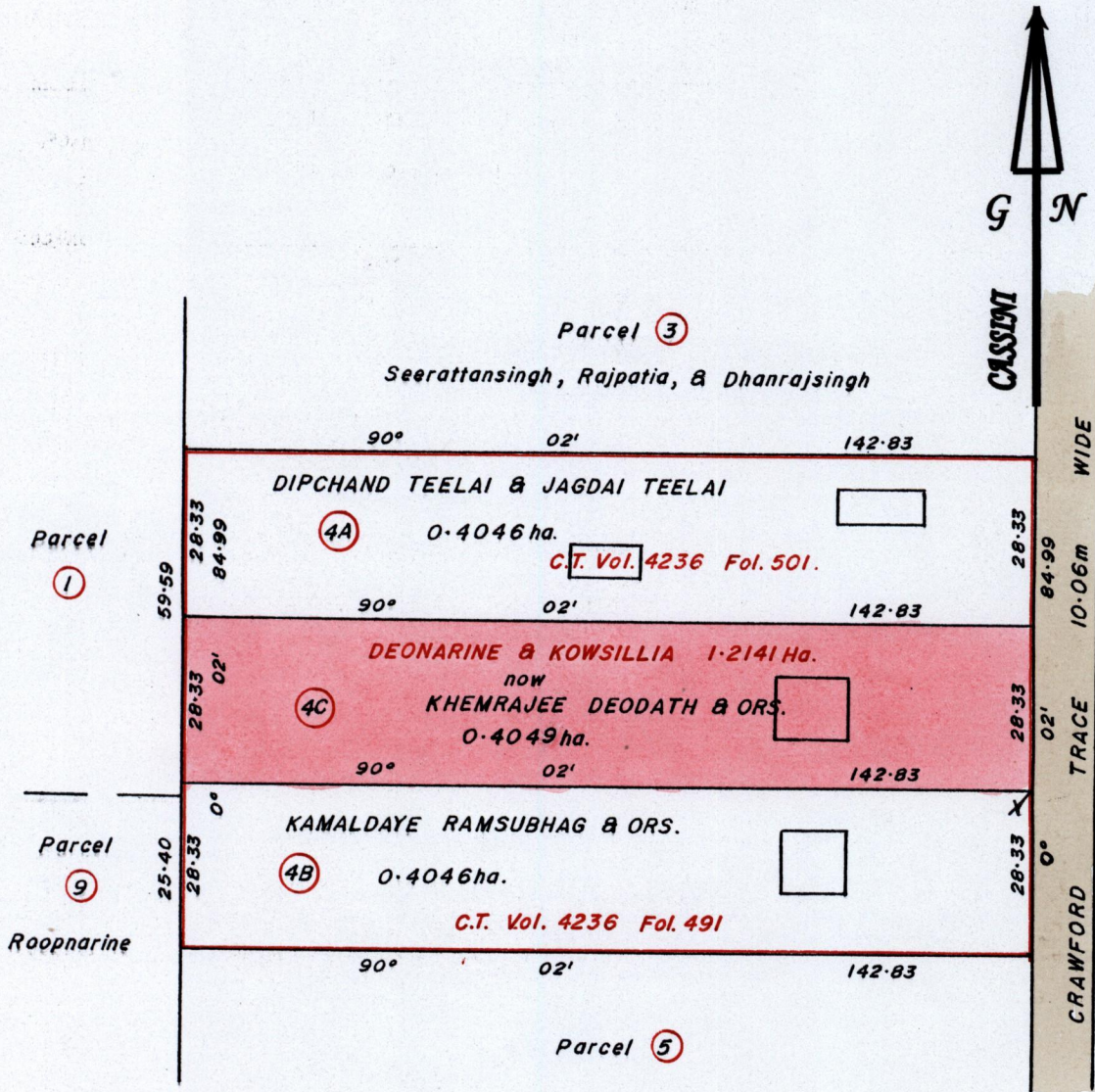

1119872mN, 670604mE.
X- U.T.M. 20, WGS 84 (+/-5.0m)
GPS Handheld Direct Obs.

Bk. 909 : 34.
Bk. 1249 : 171.
SCALE 1 : 1250.
Distances are in METRES

Approved. *[Signature]*

9 Director of Surveys. 2010.6.24

This is a true copy of a diagram one point two one four one hectares Originally transferred to DEONARINE & KOWSILLIA showing a portion, Coloured pink and containing zero point four zero four nine hectares, being the remainder after two (2) previous transfer of another portion of the land. In accordance with Reg. 25(1) of the Land Surveyors' Regulations 1998, I certify that this plan is correct.

Checked by *[Signature]* 16/6/10

Entered

[Signature]
28th August
Trinidad and Tobago Land Surveyor..... 2009.