

R.P.O Vol. 96 Fol. 53  
C.T. Vol. 3030 Fol. 23

Ward of Siparia  
County of St. Patrick  
Cadastral Sheet (G.13.E), 63E  
2/d  
Parcel Address: Batchiya Trace,  
Penal

Coordinates  
Iron Found C : N 1125482  
E 668470  
Error Statement : ±4m  
Datum Definition : U.T.M. Zone 20 Naparima  
Source : Magellan Hand Held GPS

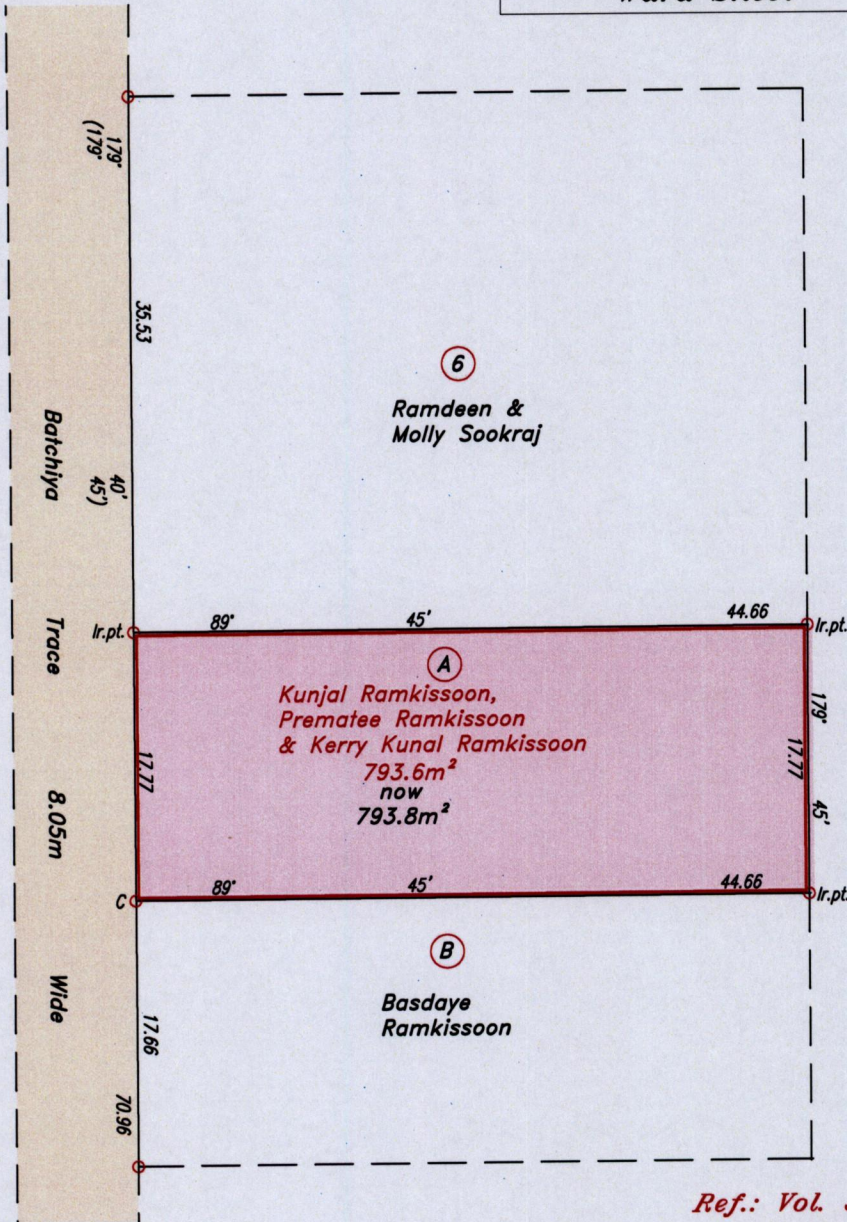
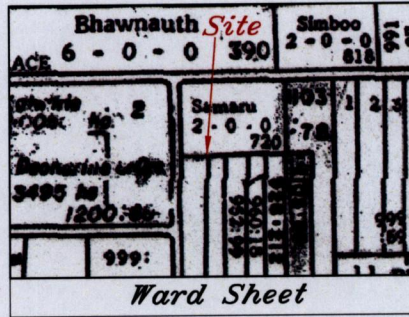

Ref.: Vol. 3030 Fol. 21  
Vol. 3030 Fol. 17  
Vol. 1666 Fol. 299

Approved.....  
Director of Surveys 20.0.5.27

SCALE 1:500

○ Denotes Iron found except otherwise stated.

Note: Bearings are U.T.M grid based on solar observations.

Distances are in metres.

Plan of a Parcel of land coloured pink in the Ward of Siparia  
Containing seven hundred and ninety three point eight square metres  
Redefined by me, with due authority, in March 2010.

In accordance with Regulation 25(1) of the Land Surveyors' Regulations 1998,  
I certify that this plan is correct.

Checked by.....  
Entered .....

.....  
Trinidad & Tobago Land Surveyor ..... 2010