

R.P.O. Vol. 64 Fol. 41  
C.T. Vol. 643 Fol. 539  
U.P.I.N. No.:

Cadastral Sheet F.14.K. 62D  
3/b  
County of St. Patrick  
Ward of La Brea

References: Bk.459 Fol.153  
Bk.834 Fol.141  
Bk.964 Fol.21

G.N.  
Cassini

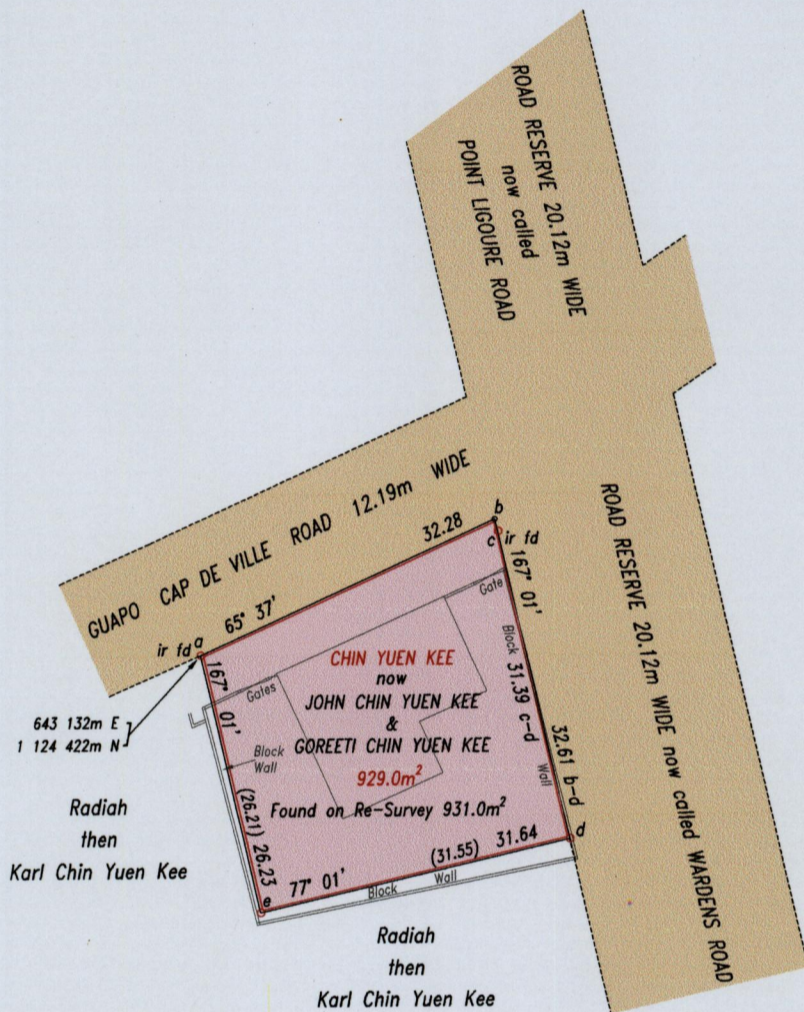

Coordinate Information		
Source:	GPS (Hand Held)	
Error Statement:	+/- 5m	
Datum:	Naparima, UTM (Zone 20)	

Sta.-Sta.	Bearing	Distance
a - c	67° 46'	32.06

Approved  
*[Signature]*  
Director of Surveys 2010.12.2

SCALE 1: 750

Distances are in metres

○ Denotes iron put except otherwise stated

Bearings are Cassini Grid based on Solar Observations

PLAN of a parcel of land coloured pink in the Ward of La Brea  
Containing nine hundred and thirty one point zero square metres  
Surveyed by me, with due authority, November 2010

In accordance with Regulation 25(1) of the Land Surveyors' Regulations 1998, I certify that this plan is correct.

Checked by *MM 26/11/10*  
Entered .....

*L.A. Roodchand*  
Trinidad & Tobago Land Surveyor 8/11/2010

