

R.P.O. Vol. 146
C.T. Vol. 5065
U.R.P.N.

Fol. 553
Fol. 501

73A
Cadastral Sheet G.17.B. 2/b
Ward of Siparia
County of St. Patrick
Vide Bk. 1010 Fol. 211
Bk. 1010 Fol. 183

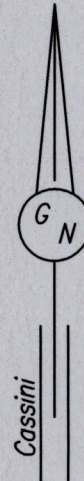
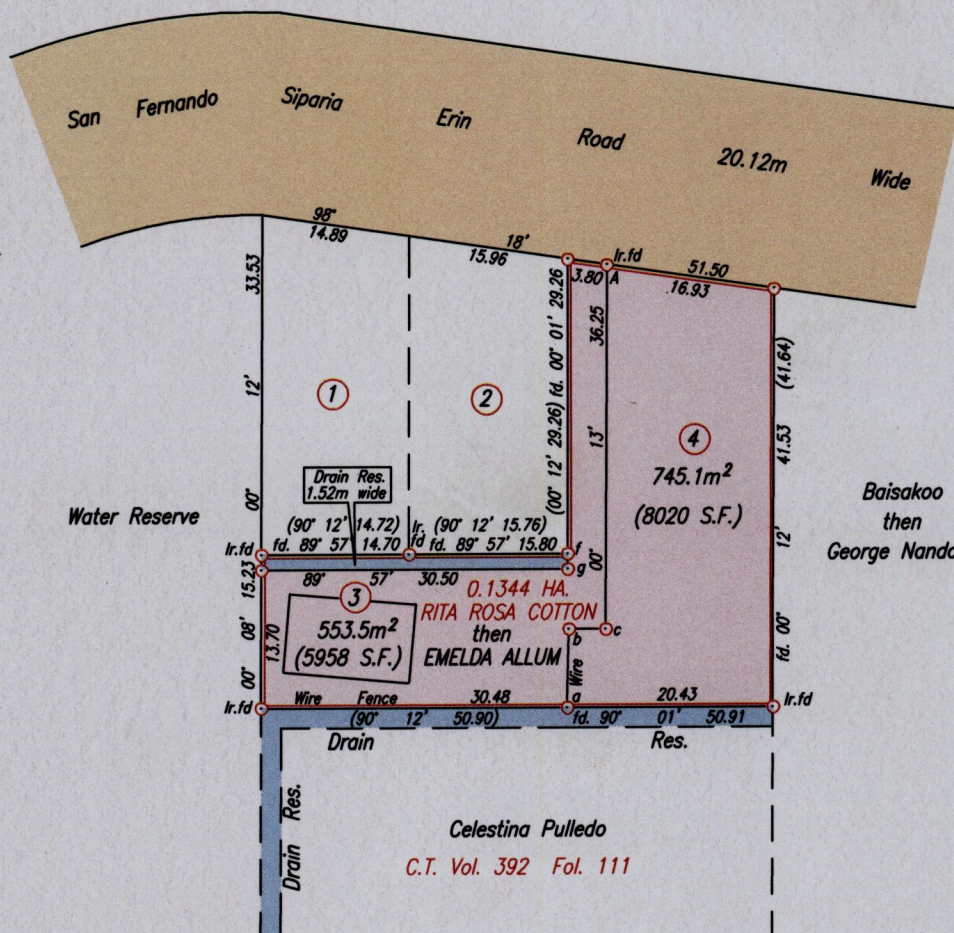

Baisakoo
then
George Nandoo

Celestina Pulledo
C.T. Vol. 392 Fol. 111

Sta.	Bearing	Dist.
a - b	00° 13'	7.74
b - c	90° 13'	3.66
g - f	00° 01'	1.52

Approved *[Signature]*
Director of Surveys 2010.10.27

SCALE 1/750
Distances are in metres

Point A
Co-ordinates obtained by Hand Held G.P.S. (Nap. Datum)
Accuracy ± 4m
E 662515m
N 1122380m

○ Denotes Iron put except otherwise stated
Bearings are Cassini Grid based on Solar Observations
Plan of 2 Parcels of land coloured pink in the Ward of Siparia
Containing together one thousand two hundred and ninety eight point six square metres
Surveyed by me, with due authority, on September 30th 1994
In accordance with Regulation 25 (1) of the Land Surveyors' Regulations 1998,
I certify that this plan is correct.



Entered on *[Signature]*
Checked by *[Signature]* 25/10/10 Trinidad & Tobago Land Surveyor 15/10 2010