

1336/163

R.P.O. Vol. 67 Fol. 533
C.T. Vol. 1894 Fol. 57

Cadastral Sheet E.2.I. 35C
1/b
Ward of Turure
County of St. Andrew

Vide Plan R.H.101
Bk.1179 Fol.9
Bk.171 Fol.8

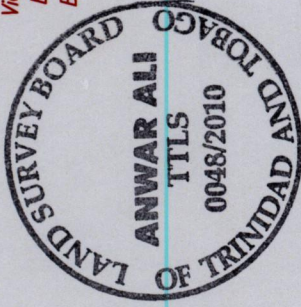

Note :

Coordinates obtained by
hand held G.P.S. (+/-5.0m.)
For Identification only

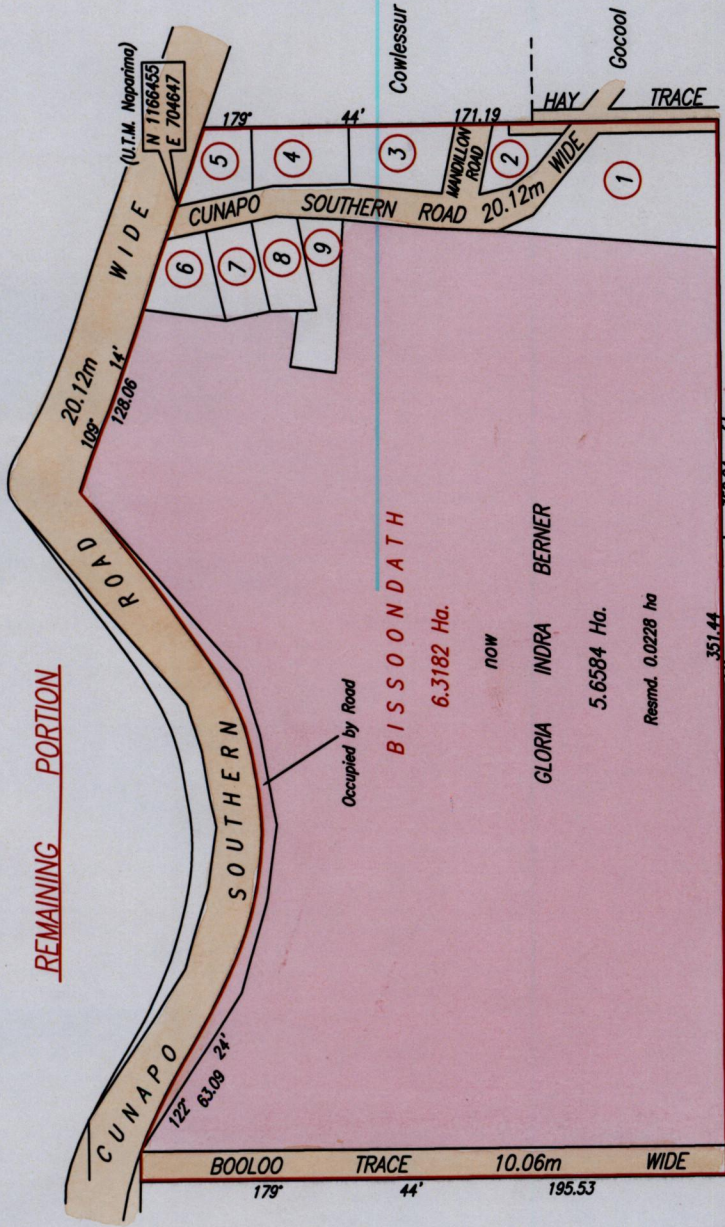

STATE

Approved
[Signature]
Director of Surveys 2010.08.20

Bearings are based on Solar Observations

This is a true copy of a diagram of six point three one eight two hectares originally, transferred to Bissoondath showing a portion coloured pink containing five point six five eight four hectares being the remainder after nine transfers and one resumption of another portion of the land.

In accordance with Regulation 25 (1) of the Land Surveyors' Regulations 1998, I certify that this plan is correct.

Checked by *[Signature]*

Entered on
Trinidad & Tobago Land Surveyor.
PAATH = AD0004 D:/DRAWINGS/MARTIN BERNER 18-08-2010 DWG. 18th August 2010.

LOTS	NAMES	C.T.Vol.	Fol.	AREAS
1	Yashwantee Khadan Joseph	3134	45	2,083.7 m ²
2	Sewak Baran	3121	317	355.8 m ²
3	Rose J. Baksh	4915	383	711.9 m ²
4	Sherry Ann Mc Donald Joseph & Christopher Joseph	4637	315	637.8 m ²
5	Gloria Indra Berner	5235	67	466.9 m ²
6	Gatka Sharma & Lila Ramdial	4219	325	549.4 m ²
7	Winnie Partillo	2964	337	464.5 m ²
8	Simbhoo Ramoutar	2947	291	471.9 m ²
9	Holima Baksh and Sanardar Rampersad	4372	357	628.0 m ²

SCALE 1:2500

Distances are in metres

163

1336 36/163